

REVISIONS	
WPHA 12-22-88	
WPHA 8-15-89	
WPHA 9-19-91	

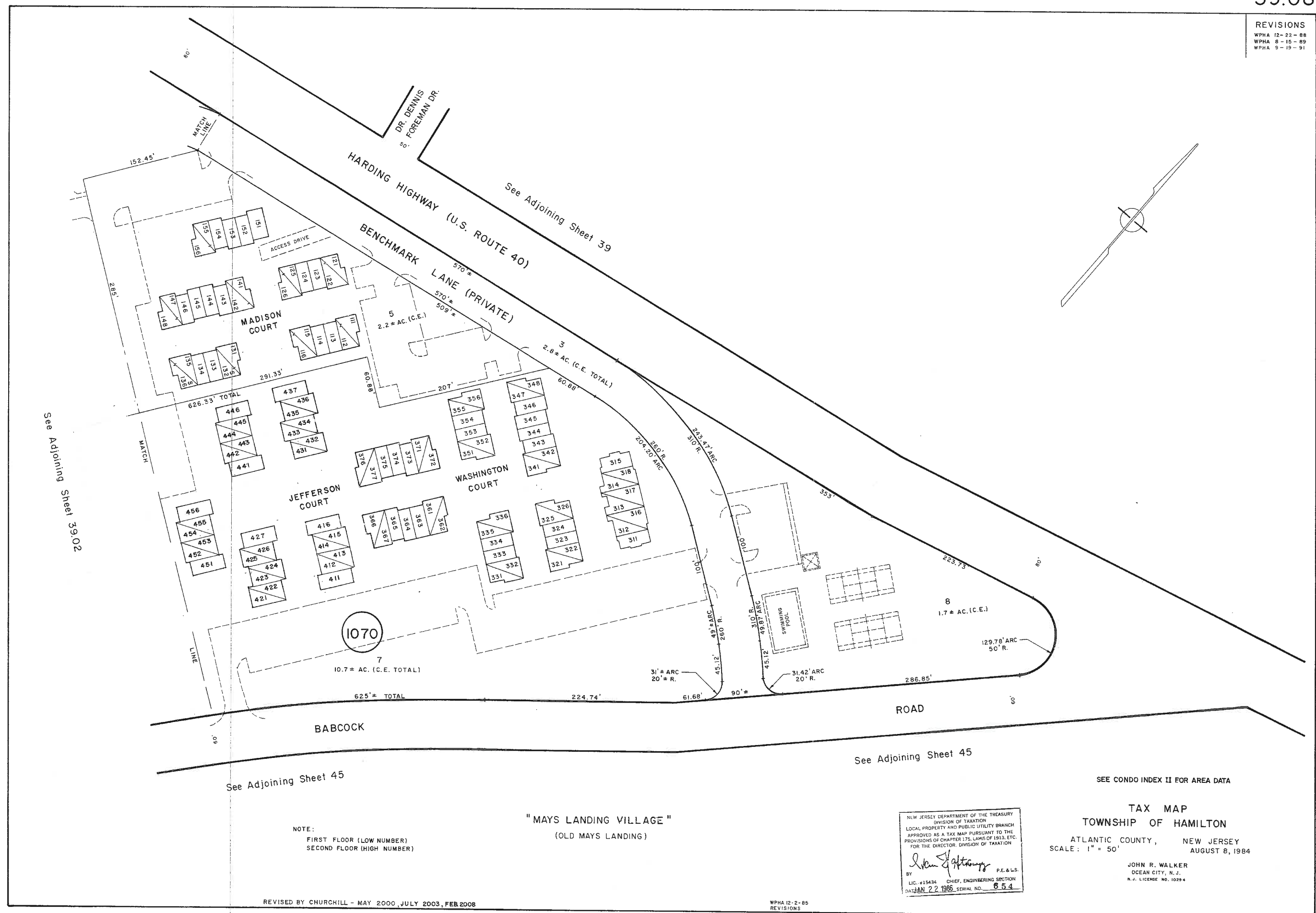

See Adjoining Sheet 39.02

See Adjoining Sheet 39

See Adjoining Sheet 45

See Adjoining Sheet 45

NOTE:
 FIRST FLOOR (LOW NUMBER)
 SECOND FLOOR (HIGH NUMBER)

"MAYS LANDING VILLAGE"
 (OLD MAYS LANDING)

N.J. DEPARTMENT OF THE TREASURY
 DIVISION OF TAXATION
 LOCAL PROPERTY AND PUBLIC UTILITY BRANCH
 APPROVED AS A TAX MAP PURSUANT TO THE
 PROVISIONS OF CHAPTER 175, LAWS OF 1913, ETC.
 FOR THE DIRECTOR, DIVISION OF TAXATION

John R. Walker
 BY: JOHN R. WALKER, P.E. & L.S.
 LIC. #15434 CHIEF, ENGINEERING SECTION
 DATE: JAN 22 1988 SERIAL NO. 654

SEE CONDO INDEX II FOR AREA DATA

TAX MAP
 TOWNSHIP OF HAMILTON
 ATLANTIC COUNTY, NEW JERSEY
 SCALE: 1" = 50'
 AUGUST 8, 1984

JOHN R. WALKER
 OCEAN CITY, N.J.
 N.J. LICENSE NO. 10224