

REVISIONS  
 WPHA 3-5-86  
 WPHA 6-3-96  
 JAM 4-30-09

GREAT EGG HARBOR BAY

SHEET 30

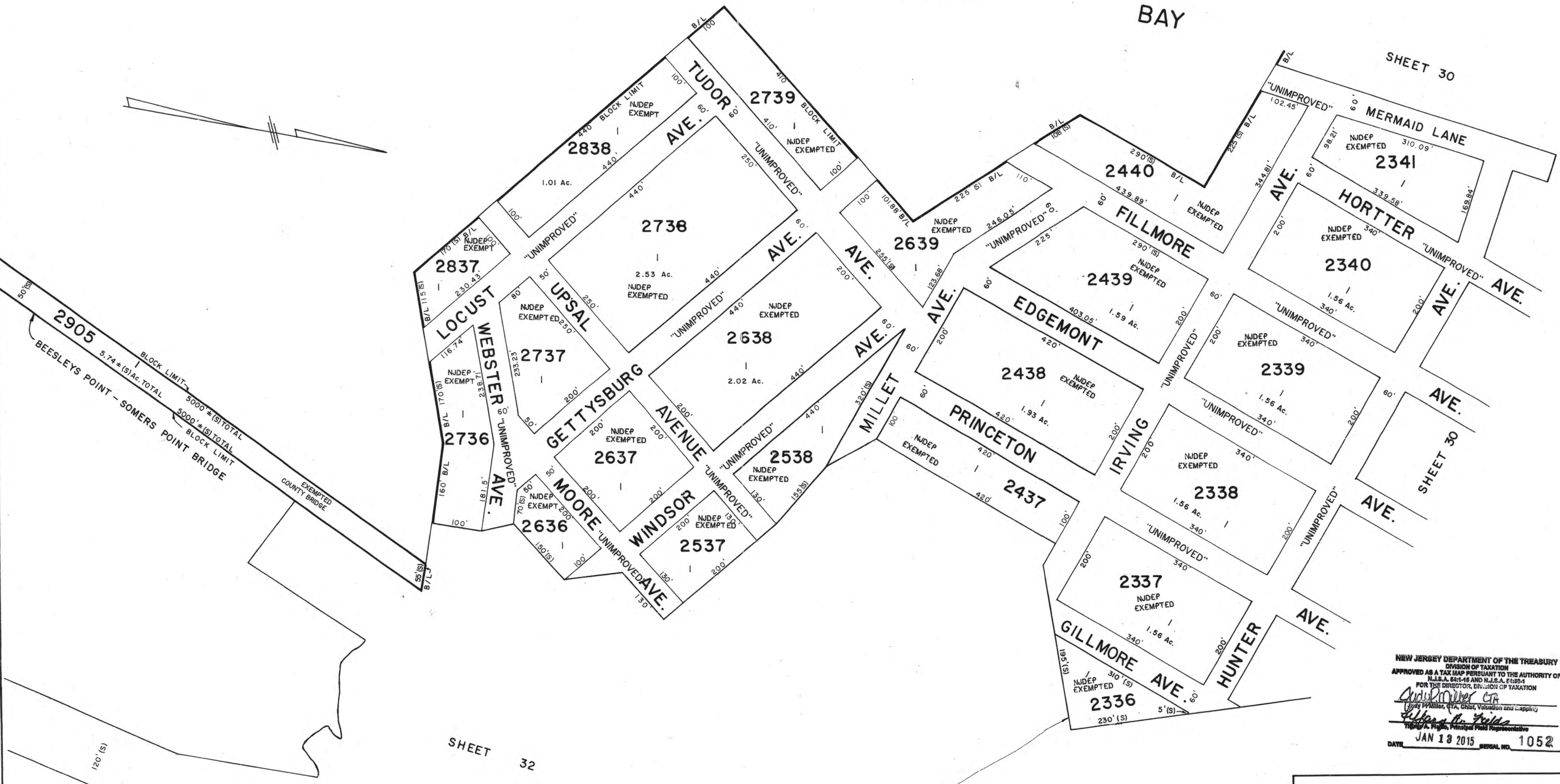

SHEET 32

NEW JERSEY DEPARTMENT OF THE TREASURY  
 DIVISION OF TAXATION  
 APPROVED AS A TAX MAP PURSUANT TO THE AUTHORITY OF  
 N.J.S.A. 54:26 AND N.J.S.A. 17:27  
 FOR THE DIRECTOR, DIVISION OF TAXATION  
*John R. Walker*  
 John R. Walker, CTA, Chief, Valuation and Mapping  
 Thomas A. Pagan, Principal Field Representative  
 DATE JAN 13 2015 SERIAL NO. 1052

GARDEN STATE PARKWAY RIGHT - OF - WAY

SHEET 29

NEW JERSEY DEPARTMENT OF THE TREASURY  
 DIVISION OF TAXATION  
 PROPERTY ADMINISTRATION  
 APPROVED AS A TAX MAP PURSUANT TO THE AUTHORITY OF  
 N.J.S.A. 54:26 AND N.J.S.A. 17:27  
 FOR THE DIRECTOR, DIVISION OF TAXATION  
*Thomas A. Pagan*  
 Thomas A. Pagan, Chief, Local Property Field Assistance  
 DATE 12 17 2014 SERIAL NO. 961

APPROVAL - THE PUBLIC UTILITY TAX BUREAU  
 NEW JERSEY DEPARTMENT OF THE TREASURY  
 DIVISION OF TAXATION  
 PUBLIC UTILITY TAX BUREAU  
 APPROVED AS A TAX MAP PURSUANT TO THE  
 PROVISIONS OF CHAPTER 175, LAWS OF 1913, ETC.  
 FOR THE DIRECTOR, DIVISION OF TAXATION  
*John R. Walker*  
 John R. Walker, CTA, Chief, Valuation and Mapping  
 DATE JAN 28 1969 SERIAL NO. 466

**TAX MAP**  
 CITY OF SOMERS POINT  
 ATLANTIC COUNTY, NEW JERSEY  
 SCALE: 1" = 100' NOVEMBER, 1968  
 TO SHOW CONDITIONS AS OF: 11-17-14  
 JOHN R. WALKER  
 738 SHORE ROAD  
 SOMERS POINT, N.J.