

REVISIONS  
WPHA 2-10-86  
JAM 4-28-09

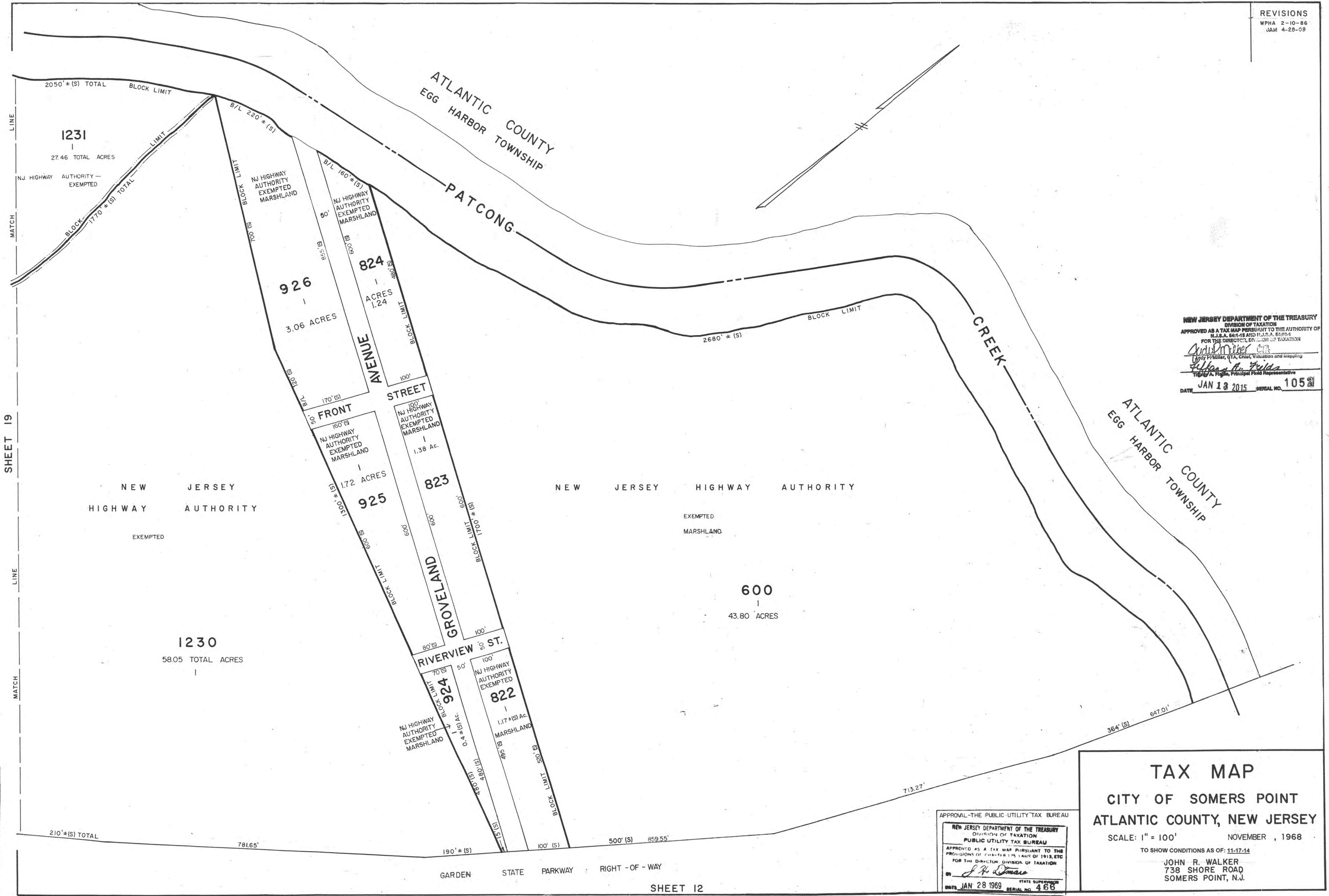

NEW JERSEY DEPARTMENT OF THE TREASURY  
DIVISION OF TAXATION  
APPROVED AS A TAX MAP PURSUANT TO THE AUTHORITY OF  
N.J.S.A. 54:1-6 AND N.J.A.C. 17:27  
FOR THE DIRECTOR, DIVISION OF TAXATION

*John R. Walker*  
John R. Walker, CTA, Chief, Valuation and Mapping

*Thomas A. Pagan*  
Thomas A. Pagan, Principal Field Representative

DATE JAN 13 2015 SERIAL NO. 1052

APPROVAL - THE PUBLIC UTILITY TAX BUREAU

NEW JERSEY DEPARTMENT OF THE TREASURY  
DIVISION OF TAXATION  
PUBLIC UTILITY TAX BUREAU

APPROVED AS A TAX MAP PURSUANT TO THE  
PROVISIONS OF CHAPTER 175, LAWS OF 1913, ETC.  
FOR THE DIRECTOR, DIVISION OF TAXATION

*J. H. Dumas*  
STATE SUPERVISOR

DATE JAN 28 1969 SERIAL NO. 466

**TAX MAP**  
CITY OF SOMERS POINT  
ATLANTIC COUNTY, NEW JERSEY

SCALE: 1" = 100' NOVEMBER, 1968

TO SHOW CONDITIONS AS OF: 11-17-14

JOHN R. WALKER  
738 SHORE ROAD  
SOMERS POINT, N.J.

PROPERTY ADMINISTRATOR  
APPROVED AS A TAX MAP PURSUANT TO THE AUTHORITY OF  
N.J.S.A. 54:1-6 AND N.J.A.C. 17:27  
FOR THE DIRECTOR, DIVISION OF TAXATION

THOMAS A. PAGAN, CTA, Chief, Valuation and Mapping

DATE: SEP 17 2010 SERIAL NO. 961