

REVISIONS			
DATE	BY	LIC. No.	COMMENTS

TOWNSHIP OF EGG HARBOR

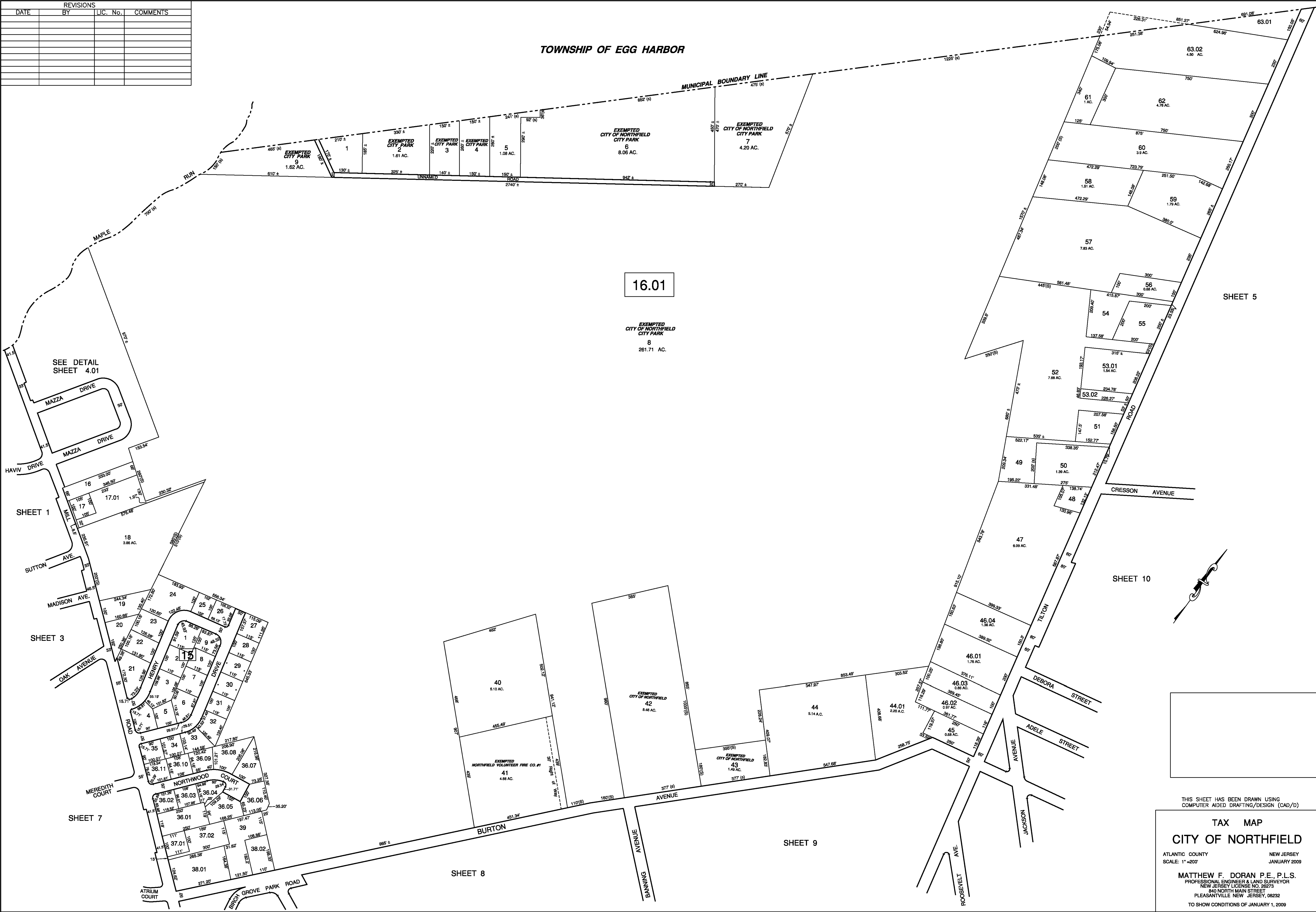

16.01

SHEET 5

SHEET 10

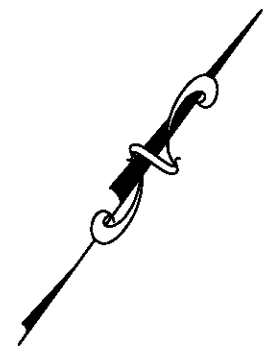

THIS SHEET HAS BEEN DRAWN USING COMPUTER AIDED DRAFTING/DESIGN (CAD/D)

TAX MAP
CITY OF NORTHFIELD
ATLANTIC COUNTY NEW JERSEY
SCALE: 1" = 200' JANUARY 2009

MATTHEW F. DORAN P.E., P.L.S.
PROFESSIONAL ENGINEER & LAND SURVEYOR
NEW JERSEY LICENSE NO. 28273
840 NORTH MAIN STREET
PLEASANTVILLE NEW JERSEY 08232
TO SHOW CONDITIONS OF JANUARY 1, 2009