

MATCH SHEET 91

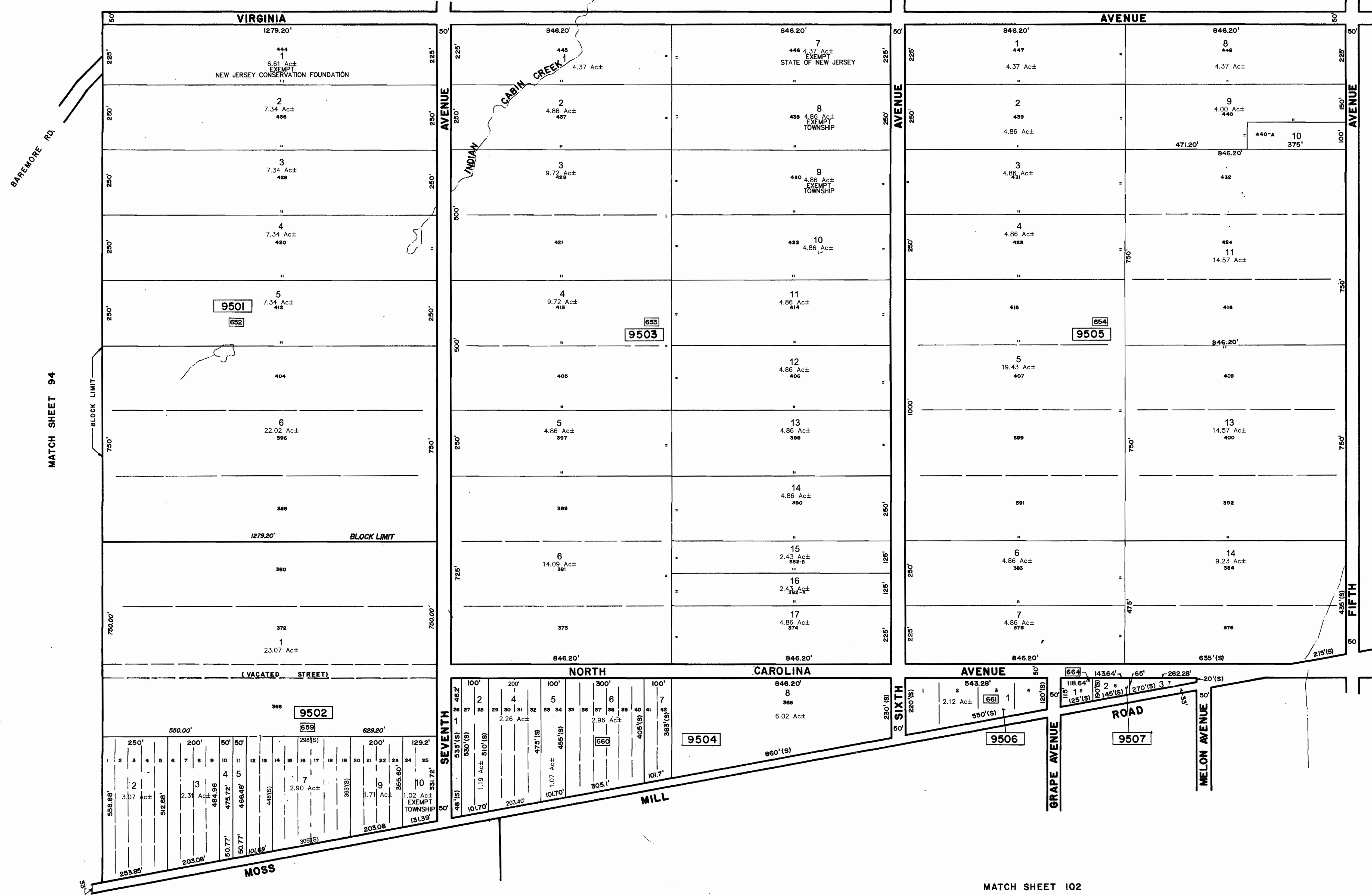

\* THIS MAP IS A SCANNED COPY OF THE ORIGINAL MAP PREPARED BY CHRIS R. REHMANN DATED 1983. THE ORIGINAL APPROVED MAP IS ON FILE IN THE ENGINEERS OFFICE.

REVISIONS				
DATE	BY	LIC. NO.	BLOCK	LOT
10/1997	A.T.			
12/1998	A.T.			
10/2006	DORAN ENG.			
10/2012	ED CLAY	34842	9505	11

THIS MAP WAS FORMALLY CERTIFIED BY THE DIVISION OF TAXATION ON MARCH 14, 1984, SIGNED BY IVAN HAFTKOWITZ AND ASSIGNED SERIAL NUMBER 630

**TAX MAP**  
**TOWNSHIP OF MULLICA**  
 ATLANTIC COUNTY NEW JERSEY  
 SCALE: 1" = 200' DATE: NOVEMBER 1983  
**CHRIS R. REHMANN**  
 PROFESSIONAL ENGINEER LAND SURVEYOR  
 NEW JERSEY LICENSE NO. 17119  
 850 SO. WHITE HORSE PIKE  
 HAMMINGTON, NEW JERSEY 08037  
 CO# 24GA27973300  
 TO SHOW CONDITIONS AS OF FEBRUARY 1, 2017