

MATCH SHEET 52

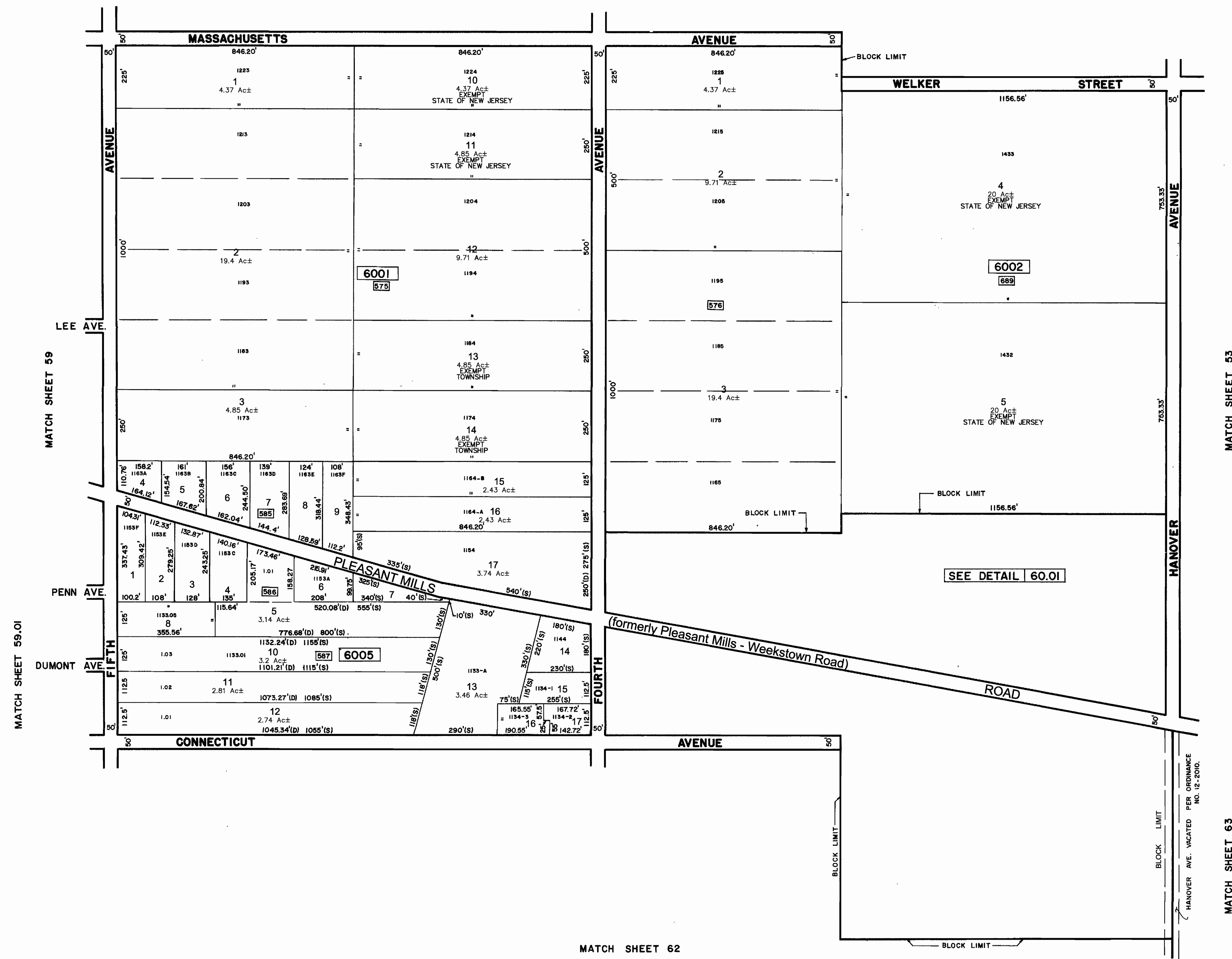
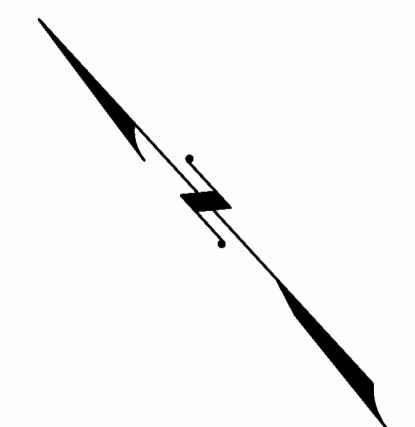

* THIS MAP IS A SCANNED COPY OF THE ORIGINAL MAP PREPARED BY CHRIS R. REHMANN DATED 1983. THE ORIGINAL APPROVED MAP IS ON FILE IN THE ENGINEERS' OFFICE.

REVISIONS				
DATE	BY	LIC. NO.	BLOCK	LOT
12/2010	ED CLAY	34842		
8/2011	ED CLAY	34842		
02/2017	ED CLAY	34842	Pleasant Mills Weekstown Rd to Pleasant Mills Rd	

THIS MAP WAS FORMALLY CERTIFIED BY THE DIVISION OF TAXATION ON MARCH 14, 1984, SIGNED BY IVAN HAFTKOWITZ AND ASSIGNED SERIAL NUMBER 630

TAX MAP
TOWNSHIP OF MULLICA

ATLANTIC COUNTY
SCALE: 1" = 200'

NEW JERSEY
DATE: NOVEMBER 1983

CHRIS R. REHMANN

PROFESSIONAL ENGINEER LAND SURVEYOR
NEW JERSEY LICENSE NO. 17119
850 SO. WHITE HORSE PIKE
HAMMONTON, NEW JERSEY 08037
CO#P 24GA27973300

TO SHOW CONDITIONS AS OF FEBRUARY 1, 2017