

REVISIONS				
DATE	BY	LIC.NO	BLOCK	LOT
3/1994	R.V.			
10/1999	AQUA TERRA			
8/2002	A.T.			
8/2011	ED CLAY	34842	4303	6

* THIS MAP IS A SCANNED COPY OF THE ORIGINAL MAP PREPARED BY CHRIS R. REHMANN DATED 1983. THE ORIGINAL APPROVED MAP IS ON FILE IN THE ENGINEERS' OFFICE.

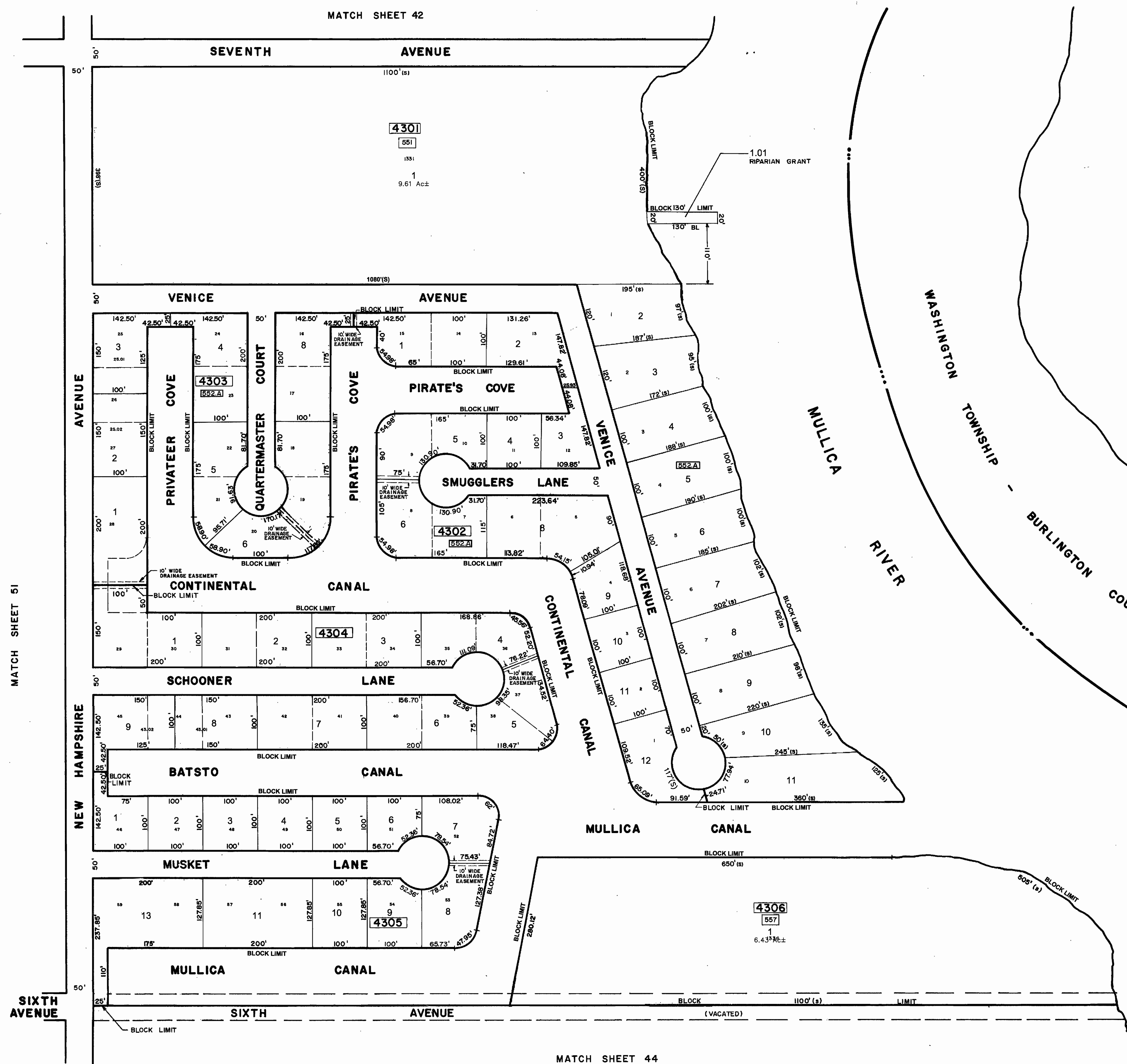

THIS MAP WAS FORMALLY CERTIFIED BY THE DIVISION OF TAXATION ON MARCH 14, 1984, SIGNED BY IVAN HAFTKOWITZ AND ASSIGNED SERIAL NUMBER 630

TAX MAP
TOWNSHIP OF MULLICA

ATLANTIC COUNTY NEW JERSEY
SCALE: 1" = 100' DATE: NOVEMBER 1983

CHRIS R. REHMANN

PROFESSIONAL ENGINEER LAND SURVEYOR
NEW JERSEY LICENSE NO. 17119
880 SO. WHITE HORSE PIKE
HAMMONTON, NEW JERSEY 08037
CO.# 24GA27873300

TO SHOW CONDITIONS AS OF FEBRUARY 1, 2017