

MATCH SHEET 78

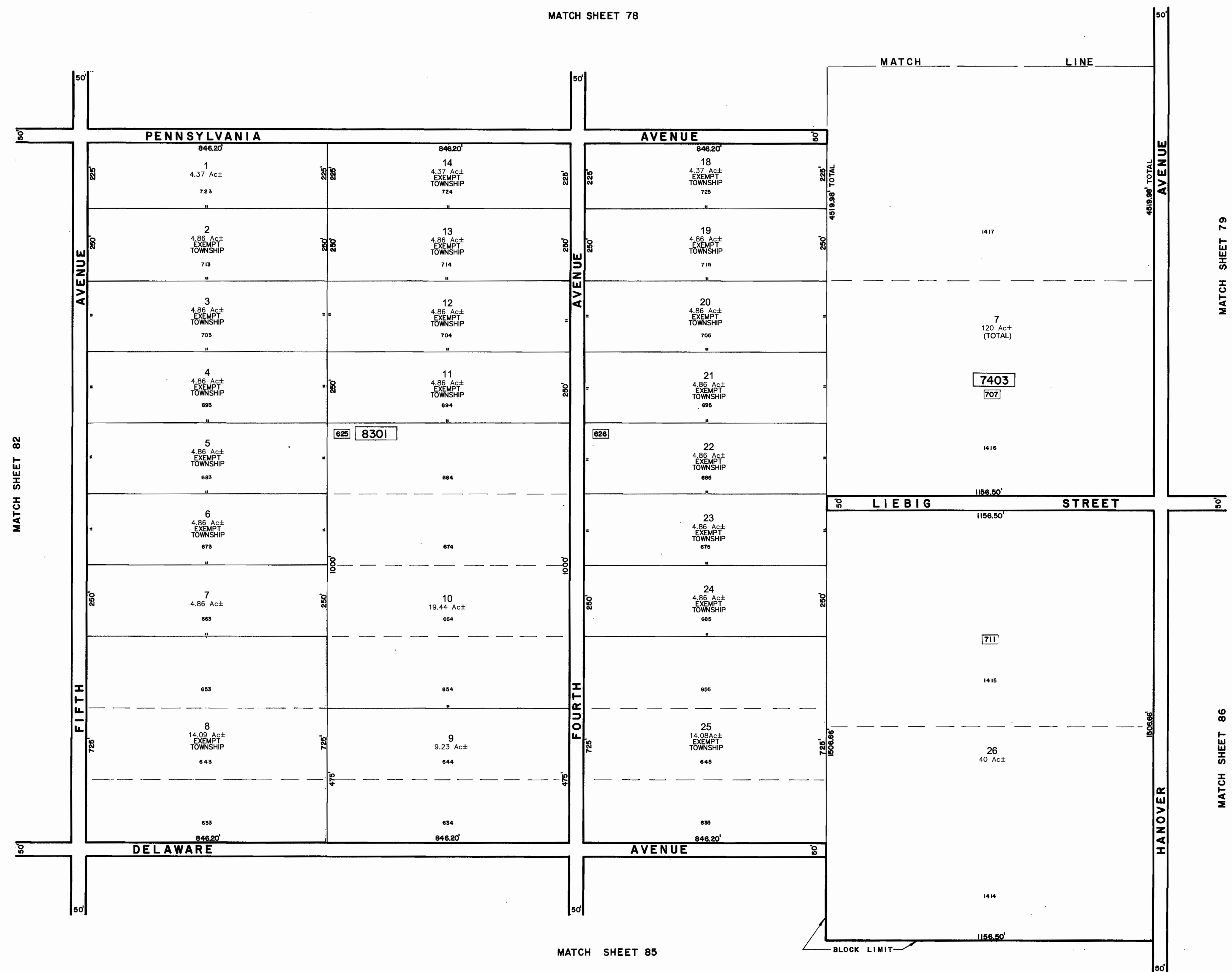

\* THIS MAP IS A SCANNED COPY OF THE ORIGINAL MAP PREPARED BY CHRIS R. REHMANN DATED 1983. THE ORIGINAL APPROVED MAP IS ON FILE IN THE ENGINEERS OFFICE.

REVISIONS				
DATE	BY	LIC.NO	BLOCK	LOT

THIS MAP WAS FORMALLY CERTIFIED BY THE DIVISION OF TAXATION ON MARCH 14, 1984, SIGNED BY IVAN HAFTKOWITCZ AND ASSIGNED SERIAL NUMBER 630

**TAX MAP**  
**TOWNSHIP OF MULLICA**

ATLANTIC COUNTY NEW JERSEY  
SCALE: 1" = 200' DATE: NOVEMBER 1983

**CHRIS R. REHMANN**  
PROFESSIONAL ENGINEER LAND SURVEYOR  
NEW JERSEY LICENSE NO. 17119  
850 SO. WHITE HORSE PIKE  
HAMMONTON, NEW JERSEY 08037  
COAR 24GA27973300  
TO SHOW CONDITIONS AS OF FEBRUARY 1, 2017