

REVISIONS				
DATE	BY	LIC.NO	BLOCK	LOT

\* THIS SHEET HAS BEEN DRAWN USING COMPUTER AIDED DRAFTING/ DESIGN (CAD/D) AND COORDINATE GEOMETRY (COGO).

## KEYMAP 1

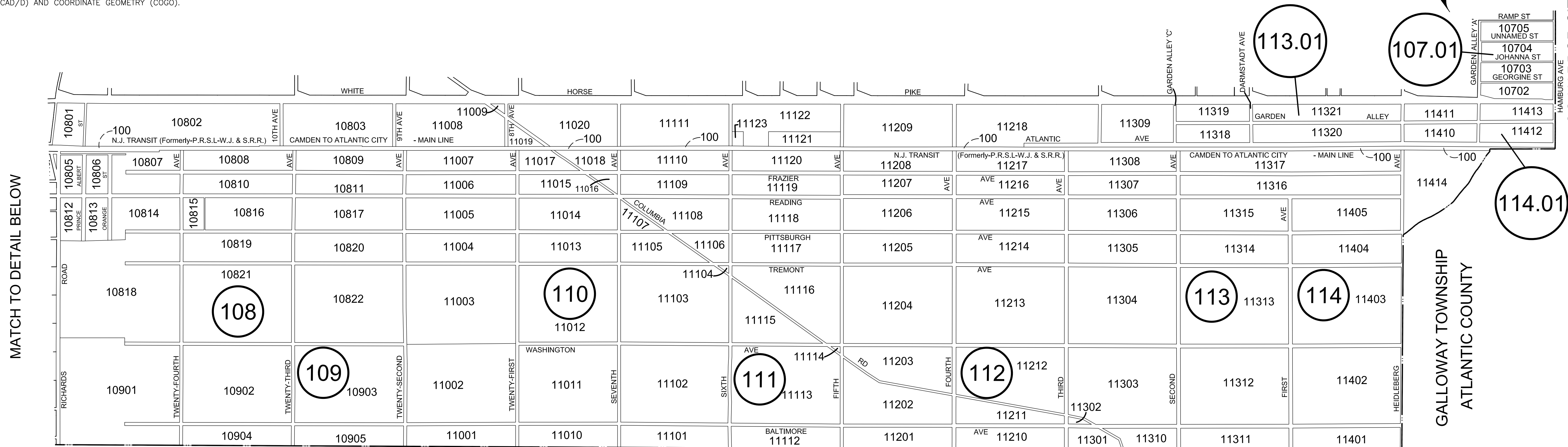

MATCH TO DETAIL BELOW

GALLOWAY TOWNSHIP  
ATLANTIC COUNTY

EGG HARBOR CITY  
ATLANTIC COUNTY

## KEYMAP 2

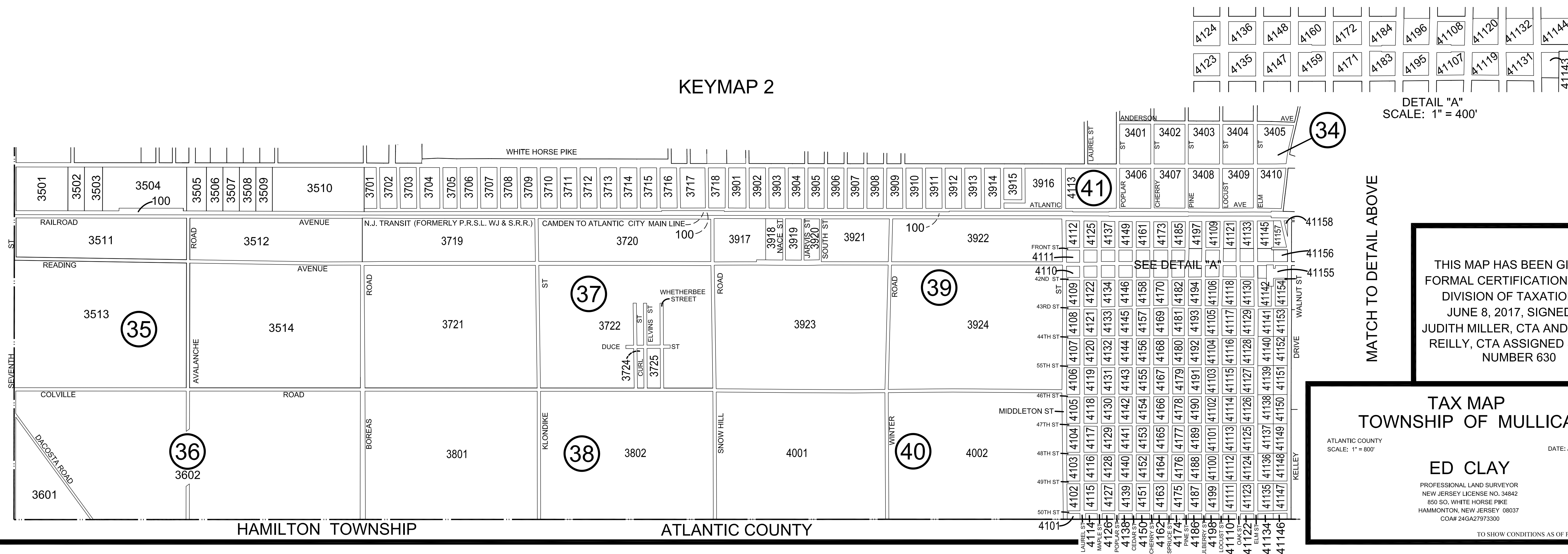

DETAIL "A"  
SCALE: 1" = 400'

MATCH TO DETAIL ABOVE

THIS MAP HAS BEEN GIVEN A FORMAL CERTIFICATION BY THE DIVISION OF TAXATION ON JUNE 8, 2017, SIGNED BY JUDITH MILLER, CTA AND SHELLY REILLY, CTA ASSIGNED SERIAL NUMBER 630

### TAX MAP TOWNSHIP OF MULLICA

ATLANTIC COUNTY  
SCALE: 1" = 800'

NEW JERSEY  
DATE: JANUARY 2017

**ED CLAY**  
PROFESSIONAL LAND SURVEYOR  
NEW JERSEY LICENSE NO. 34842  
350 SO. WHITE HORSE PIKE  
HAMMONTON, NEW JERSEY 08037  
CO#A 24GA27973300

TO SHOW CONDITIONS AS OF FEBRUARY 1, 2017