

REVISIONS		
6-14-2013	CRAIG F. REMINGTON	23924
12-11-2015	CHARLES E. ADAMSON	42627
1-30-2017	CHARLES E. ADAMSON	42627

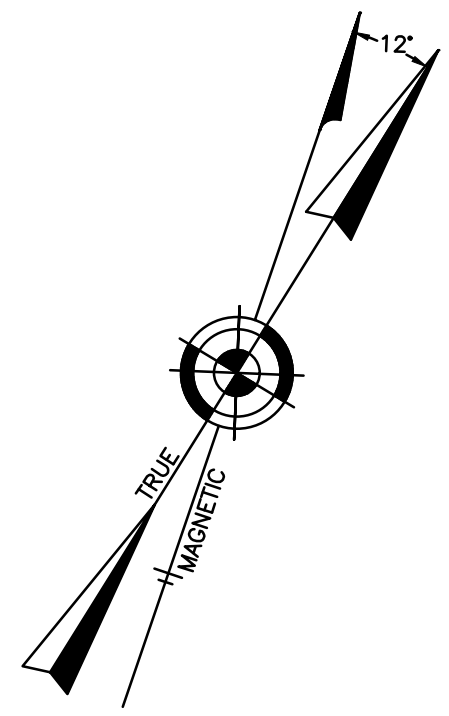

SHEET 21

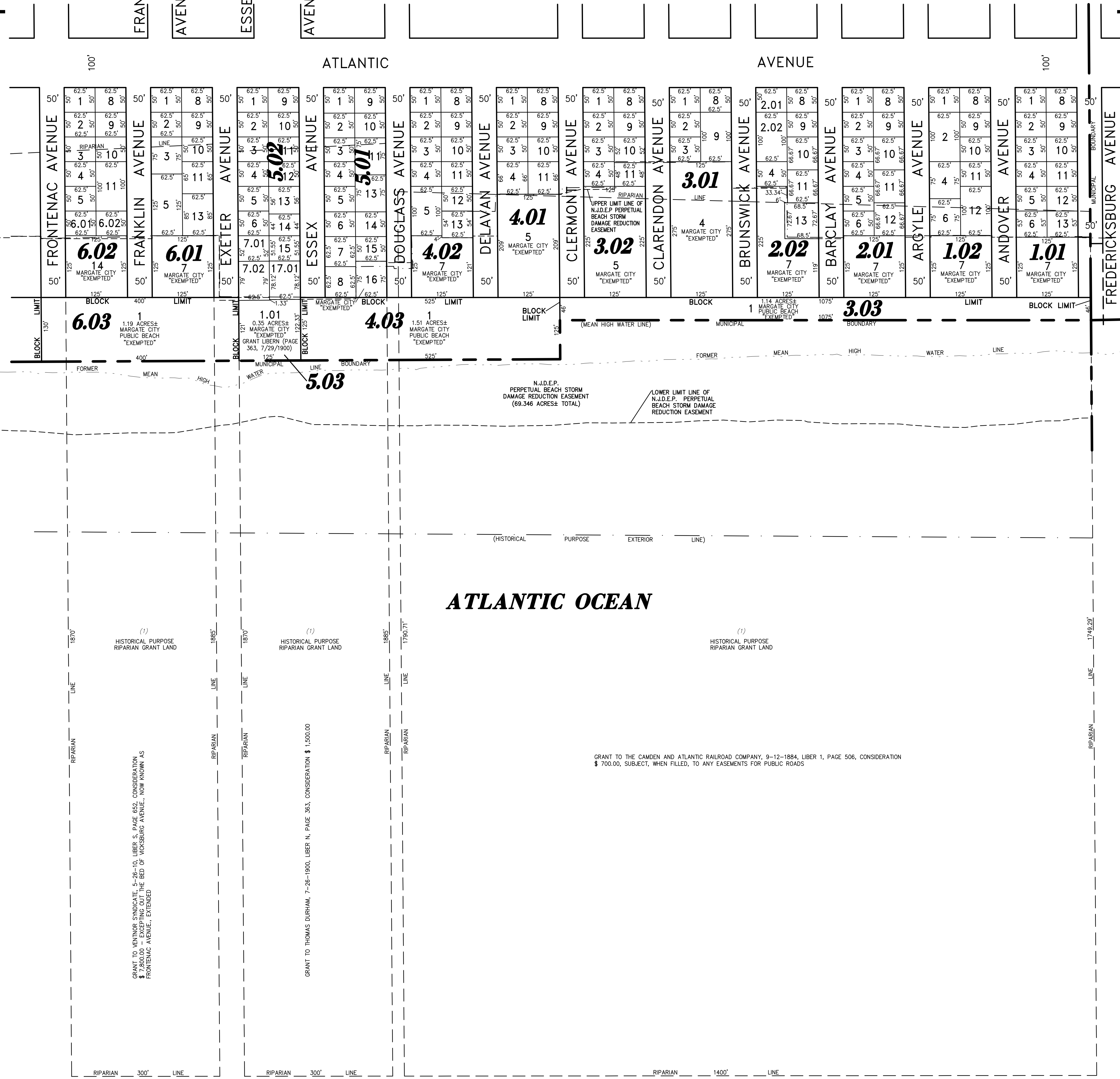

# ATLANTIC OCEAN

GRANT TO THE CAMDEN AND ATLANTIC RAILROAD COMPANY, 9-12-1884, LIBER 1, PAGE 506, CONSIDERATION \$ 700.00, SUBJECT, WHEN FILLED, TO ANY EASEMENTS FOR PUBLIC ROADS

GRANT TO VENTNOR SYNDICATE 5-26-10, LIBER 8, PAGE 462, CONSIDERATION \$ 7,200.00 - EXCEPTING OUT THE BED OF VIGSBURG AVENUE, NOW KNOWN AS FRONTENAC AVENUE, EXTENDED

GRANT TO THOMAS DURHAM, 7-26-1900, LIBER N, PAGE 383, CONSIDERATION \$ 1,500.00

"THIS TAX MAP PLATE HAS BEEN DIGITALLY DRAWN USING COMPUTER-AIDED DRAFTING/DESIGN (CADD) & COORDINATE GEOMETRY (COGO). IT IS BASED ON THE ORIGINAL DIGITALLY DRAWN TAX MAP PLATE BEARING THE OFFICIAL NEW JERSEY DIVISION TAXATION APPROVAL STAMP WITH APPROVAL DATE 6-3-2005 SERIAL NUMBER 846 AND SIGNATURES OF SIGNERS' THOMAS J. REILLY, CHIEF, LOCAL PROPERTY, FIELD ASSISTANCE, SANTO C. DIDONATO, SUPERVISING FIELD REPRESENTATIVE. THE ORIGINAL DIGITALLY DRAWN TAX MAP PLATE WITH THE OFFICIAL APPROVAL STAMP IS ON FILE WITH REMINGTON, VERNICK & WALBERG ENGINEERS."

## TAX MAP CITY OF MARGATE

ATLANTIC COUNTY NEW JERSEY  
SCALE: 1" = 100' DATE: 11-01-2003

CRAIG F. REMINGTON LAND SURVEYOR LIC. NO. 23924

**RV & W** REMINGTON, VERNICK & WALBERG ENGINEERS  
24 GA 28048700  
845 N. MAIN STREET, PLEASANTVILLE, NJ 08232  
(609) 645-7100, FAX (609) 645-7076  
WEB SITE ADDRESS: WWW.RVW.COM