

REVISIONS		
8-31-2009	CRAIG F. REMINGTON	23924
12-31-2010	CRAIG F. REMINGTON	23924

BRUNSWICK AVENUE BARCLAY AVENUE SHEET 16 BELMONT AVENUE ASH AVENUE

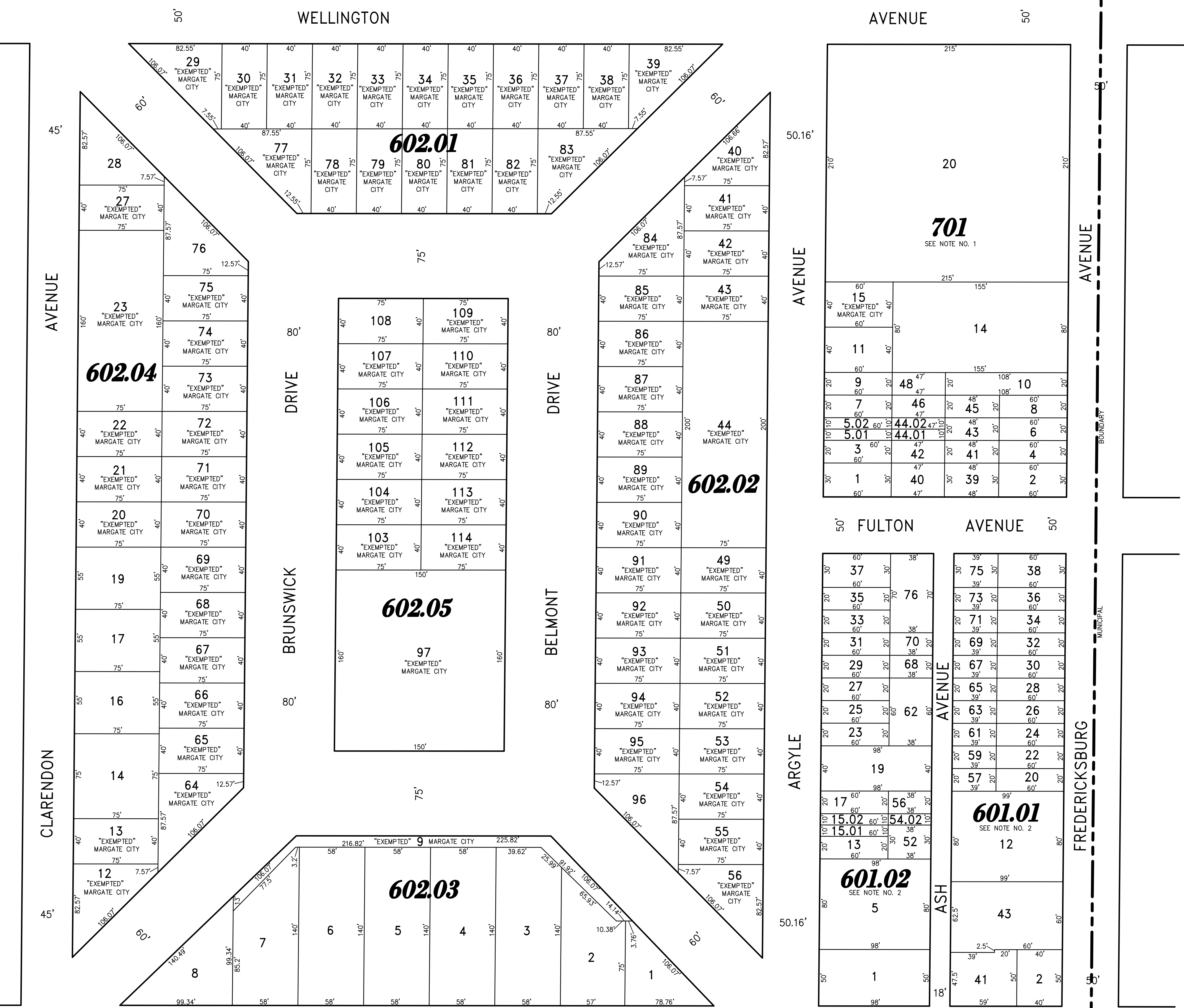
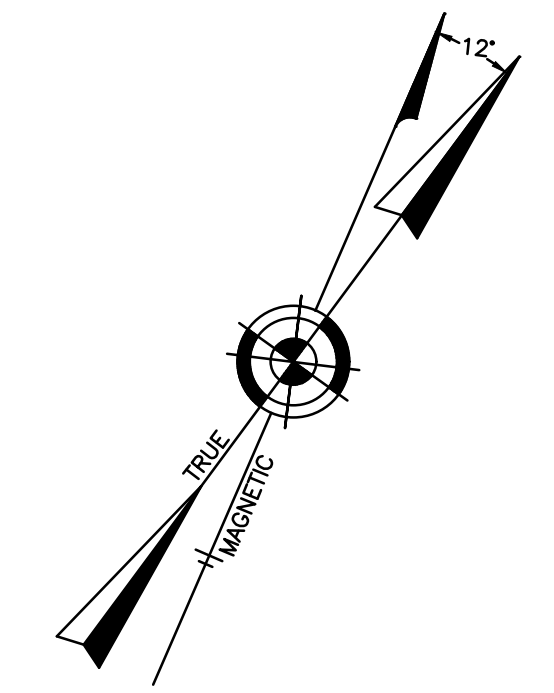

SHEET 15

CITY OF VENTNOR

- NOTES:
- BLOCK 701, LOTS 1-4, 5.01, 5.02, 6-9, 39-43, 44.01, 44.02, & 45-48 ARE ALL EXEMPTED PROPERTIES OWNED BY THE MARGATE CITY.
 - BLOCK 601.01, LOTS 20, 22, 24, 26, 28, 30, 32, 34, 57, 59, 61, 63, 65, 67, 69, 71, & 73 ARE ALL EXEMPTED PROPERTIES, OWNED BY THE MARGATE CITY.
 - BLOCK 601.02, LOTS 13, 15.01, 15.02, 17, 23, 25, 27, 29, 31, 33, 35, 37, 52, 56, 68, & 70 ARE ALL EXEMPTED PROPERTIES, OWNED BY THE MARGATE CITY.

"THIS TAX MAP PLATE HAS BEEN DIGITALLY DRAWN USING COMPUTER-AIDED DRAFTING/DESIGN (CADD) & COORDINATE GEOMETRY (COCO). IT IS BASED ON THE ORIGINAL DIGITALLY DRAWN TAX MAP PLATE BEARING THE OFFICIAL NEW JERSEY DIVISION TAXATION APPROVAL STAMP WITH APPROVAL DATE 6-3-2005 SERIAL NUMBER 846 AND SIGNATURES OF SIGNERS' THOMAS J. REILLY, CHIEF, LOCAL PROPERTY, FIELD ASSISTANCE; SANTO C. DIDONATO, SUPERVISING FIELD REPRESENTATIVE. THE ORIGINAL DIGITALLY DRAWN TAX MAP PLATE WITH THE OFFICIAL APPROVAL STAMP IS ON FILE WITH REMINGTON, VERNICK & WALBERG ENGINEERS."

TAX MAP
CITY OF MARGATE

ATLANTIC COUNTY NEW JERSEY
SCALE: 1" = 50' DATE: 11-01-2003

CRAIG F. REMINGTON LAND SURVEYOR LIC. NO. 23924



REMINGTON, VERNICK & WALBERG ENGINEERS
24 GA 28048700
845 N. MAIN STREET, PLEASANTVILLE, NJ 08232
(609) 645-710, FAX (609) 645-7076
WEB SITE ADDRESS: WWW.RVE.COM

OLD SHEET 47

BRUNSWICK AVENUE SHEET 9 BRUNSWICK DRIVE