

REVISIONS		
8-31-2009	CRAIG F. REMINGTON	23924
5-10-2010	CRAIG F. REMINGTON	23924
3-8-2012	CRAIG F. REMINGTON	23924
6-14-2013	CRAIG F. REMINGTON	23924

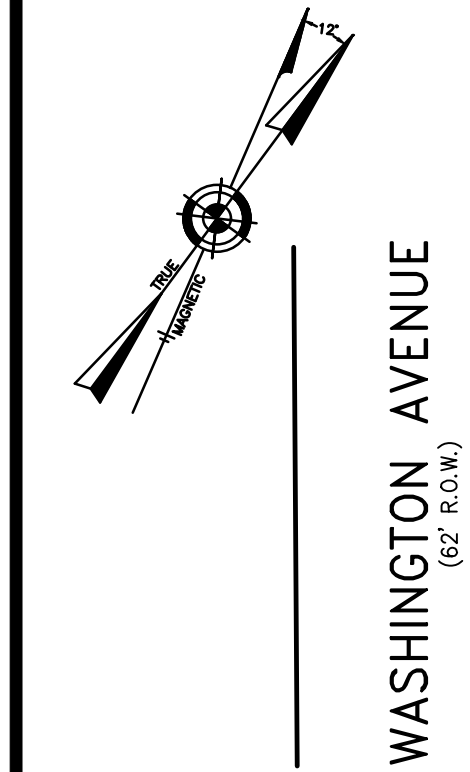

WASHINGTON AVENUE
(62' R.O.W.)

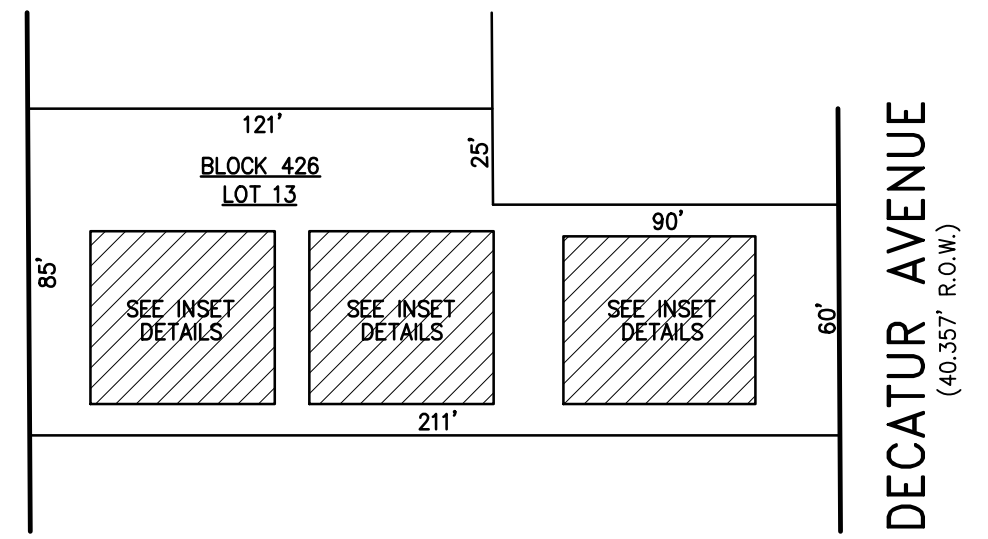

PLAN
SCALE: 1"=50'

UNIT NO.	LOT NO.
C001A	C-01A
C001B	C-01B
C002A	C-02A
C002B	C-02B
C003A	C-03A
C003B	C-03B

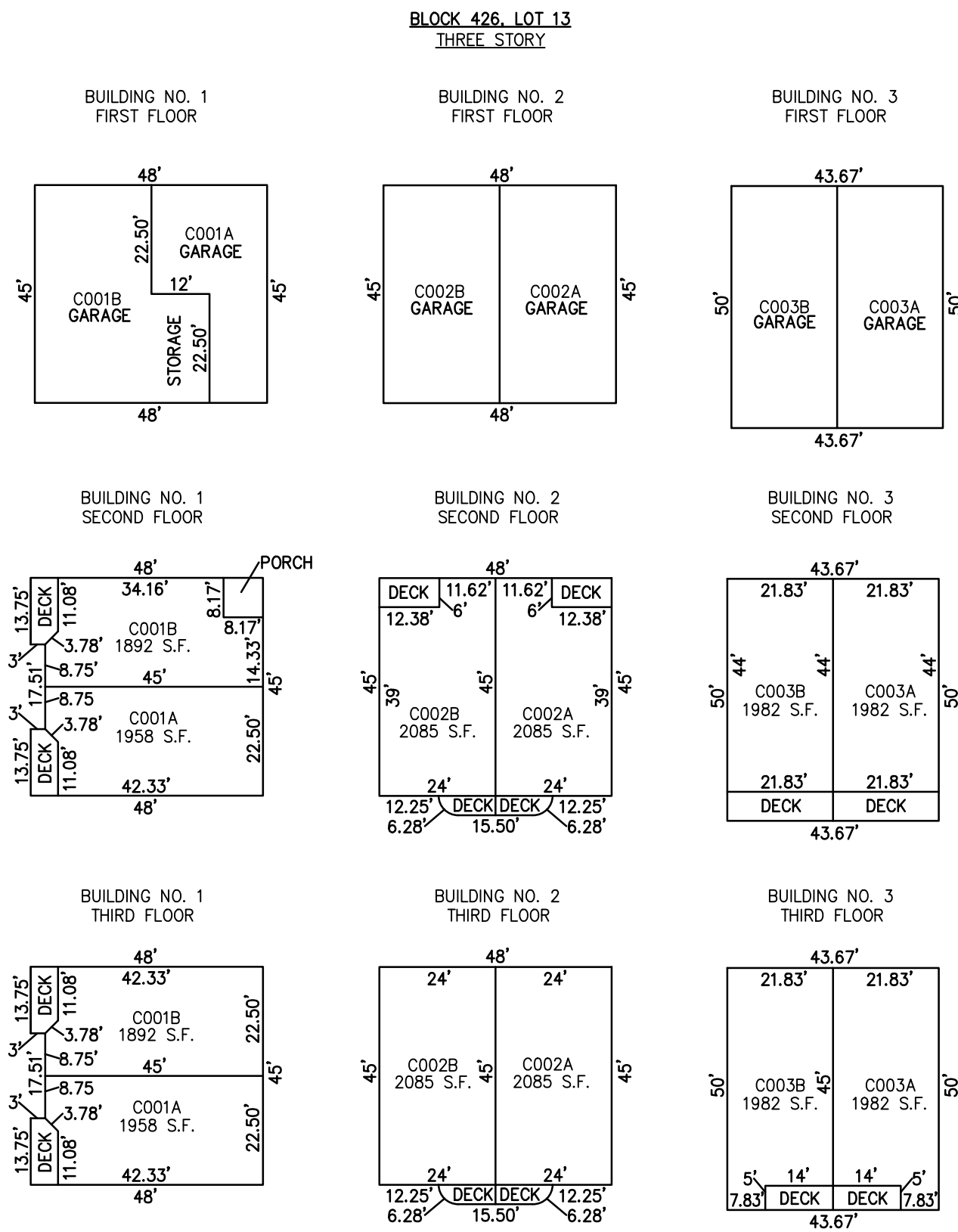

DETAILS
SCALE: 1"=30'

BLOCK 426, LOT 13
BAY CLUB CONDOMINIUM
223 WASHINGTON AVENUE &
214 NORTH DECATUR AVENUE
INSET "3N"

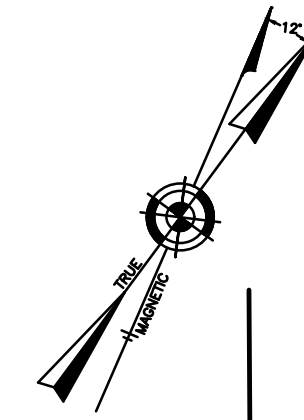

JEFFERSON AVENUE
(50' R.O.W.)

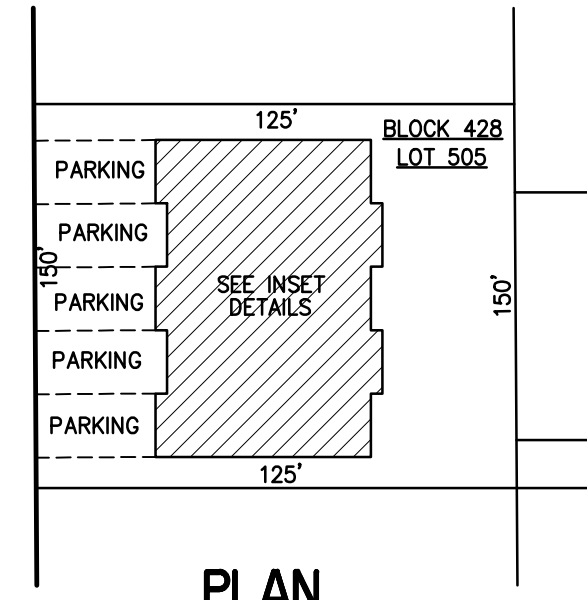

PLAN
SCALE: 1"=50'

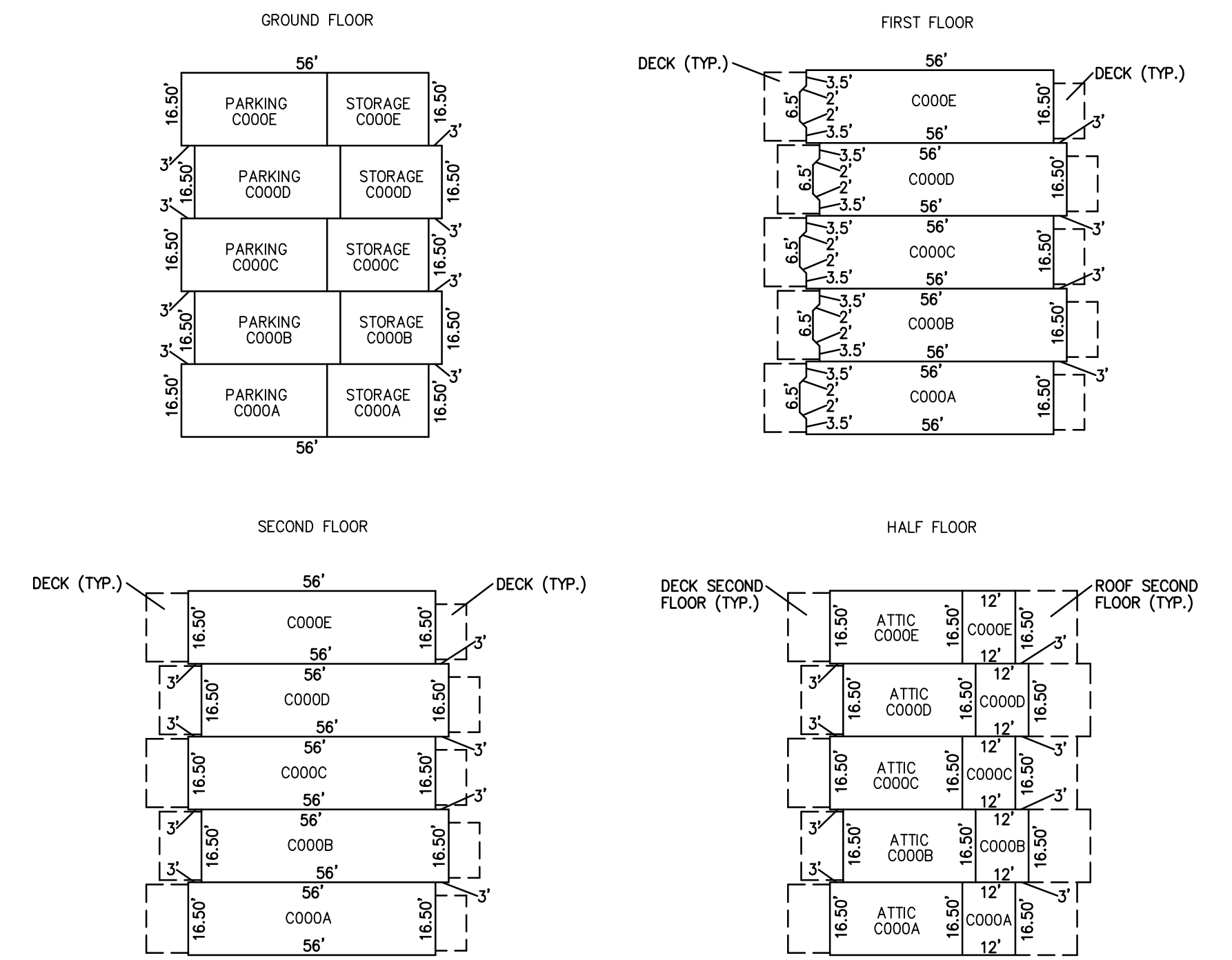

DETAILS
SCALE: 1"=30'

BLOCK 428, LOT 505
JEFFERSON WALK CONDOMINIUM
205 NORTH JEFFERSON AVENUE
INSET "3J"

UNIT NO.	LOT NO.
C000A	C-01A
C000B	C-01B
C000C	C-02A
C000D	C-02B
C000E	C-03A

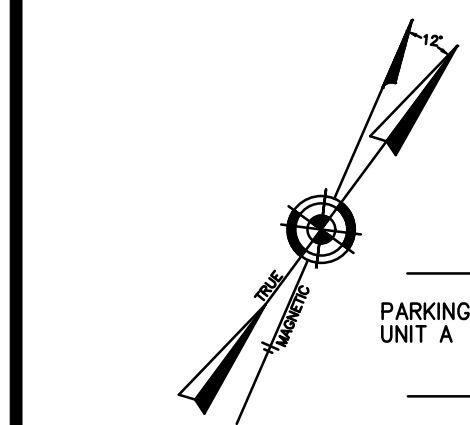

MONMOUTH AVENUE
(50' R.O.W.)

PLAN
SCALE: 1"=50'

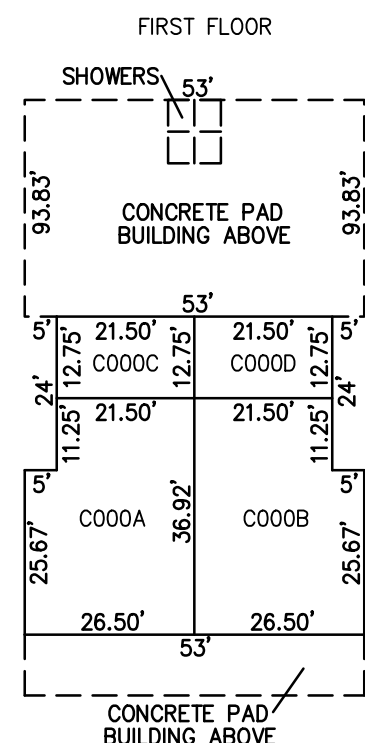

UNIT C000A - TOTAL LIVING AREA = 2862 S.F.
UNIT C000B - TOTAL LIVING AREA = 2862 S.F.
UNIT C000C - TOTAL LIVING AREA = 2211 S.F.
UNIT C000D - TOTAL LIVING AREA = 2159 S.F.

DETAILS
SCALE: 1"=30'

BLOCK 430, LOT 32
HARBORSIDE CONDOMINIUMS
9615 MONMOUTH AVENUE
INSET "4G"

UNIT NO.	LOT NO.
C000A	C-01
C000B	C-02
C000C	C-03
C000D	C-04

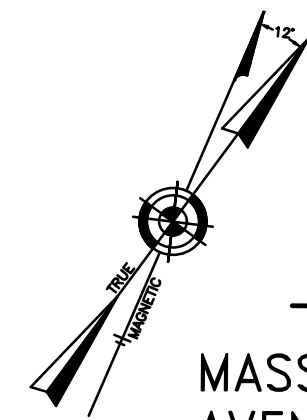

MASSEY AVENUE

WASHINGTON AVENUE
(62' R.O.W.)

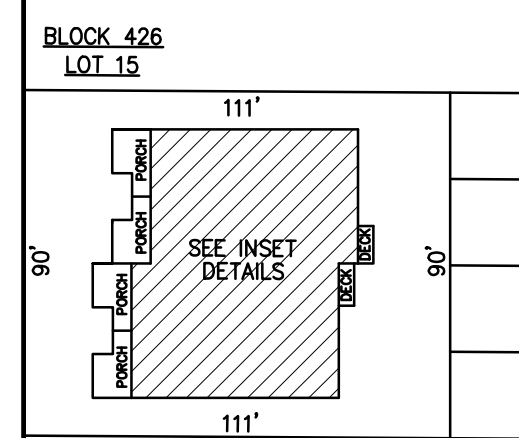

PLAN
SCALE: 1"=50'

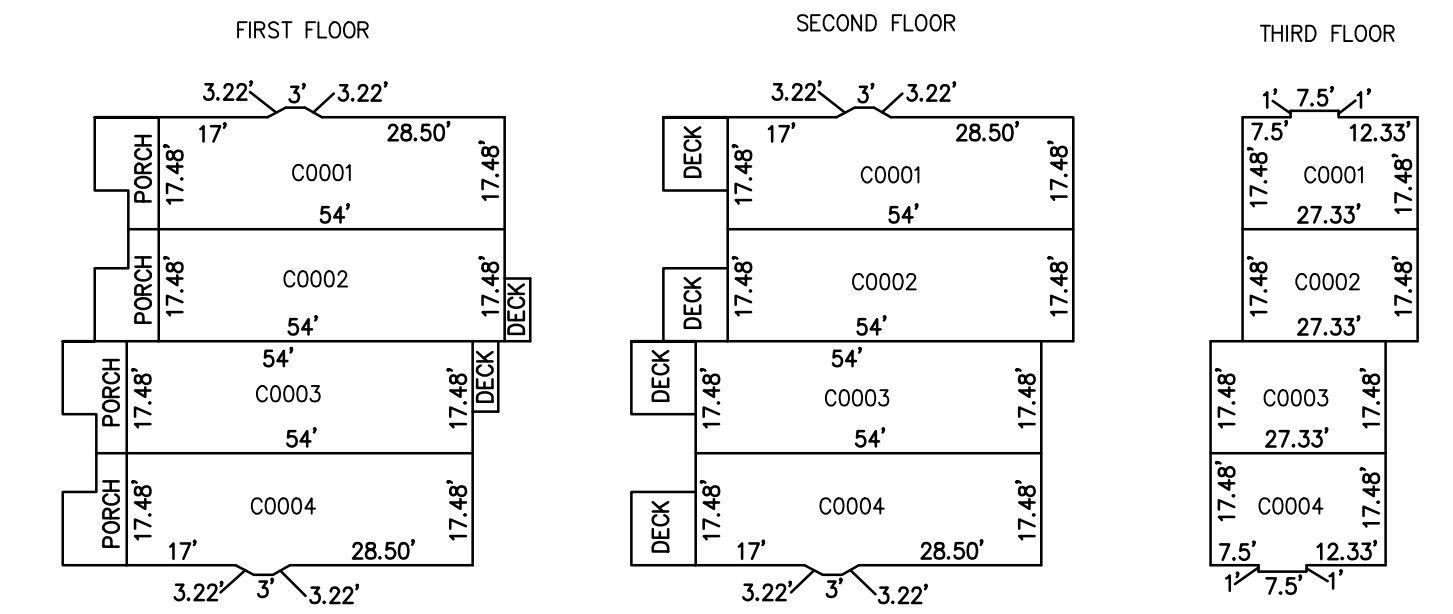

UNIT C0001 - TOTAL LIVING AREA = 2391 S.F.
UNIT C0002 - TOTAL LIVING AREA = 2391 S.F.
UNIT C0003 - TOTAL LIVING AREA = 2391 S.F.
UNIT C0004 - TOTAL LIVING AREA = 2391 S.F.

DETAILS
SCALE: 1"=30'

BLOCK 426, LOT 15
BAY VIEW AT WASHINGTON CONDOMINIUM
215 NORTH WASHINGTON AVENUE
INSET "4K"

CONDOMINIUM DETAILS AND DIMENSIONS
BLOCK 426, LOT 13
BLOCK 426, LOT 15
BLOCK 428, LOT 505
BLOCK 430, LOT 23
SEE PLATE 12

"THIS TAX MAP PLATE HAS BEEN DIGITALLY DRAWN USING COMPUTER-AIDED DRAFTING/DESIGN (CADD) & COORDINATE GEOMETRY (COGO). IT IS BASED ON THE ORIGINAL DIGITALLY DRAWN TAX MAP PLATE BEARING THE OFFICIAL NEW JERSEY DIVISION TAXATION APPROVAL STAMP WITH APPROVAL DATE 6-3-2005 SERIAL NUMBER 846 AND SIGNATURES OF SIGNERS' THOMAS J. REILLY, CHIEF, LOCAL PROPERTY, FIELD ASSISTANCE, SANTO C. DIDONATO, SUPERVISING FIELD REPRESENTATIVE. THE ORIGINAL DIGITALLY DRAWN TAX MAP PLATE WITH THE OFFICIAL APPROVAL STAMP IS ON FILE WITH REMINGTON, VERNICK & WALBERG ENGINEERS."



TAX MAP
CITY OF MARGATE

ATLANTIC COUNTY NEW JERSEY
SCALE: AS NOTED DATE: 1-30-2004

CRAIG F. REMINGTON LAND SURVEYOR LIC. NO. 23924

24 GA 28048700
REMINGTON, VERNICK & WALBERG ENGINEERS
845 N. MAIN STREET, PLEASANTVILLE, NJ 08232
(609) 645-7100, FAX (609) 645-7076
WEB SITE ADDRESS: WWW.RVWE.COM