

REVISIONS		
8-31-2009	CRAIG F. REMINGTON	23924
1-30-2017	CHARLES E. ADAMSON	42627
1-29-2019	CHARLES E. ADAMSON	42627

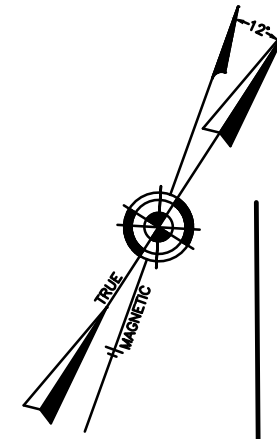

FRONTENAC AVENUE
(70' R.O.W.)

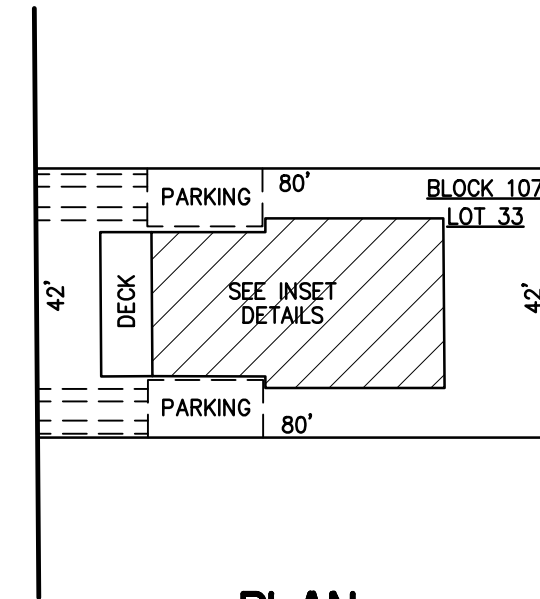

PLAN
SCALE: 1"=30'

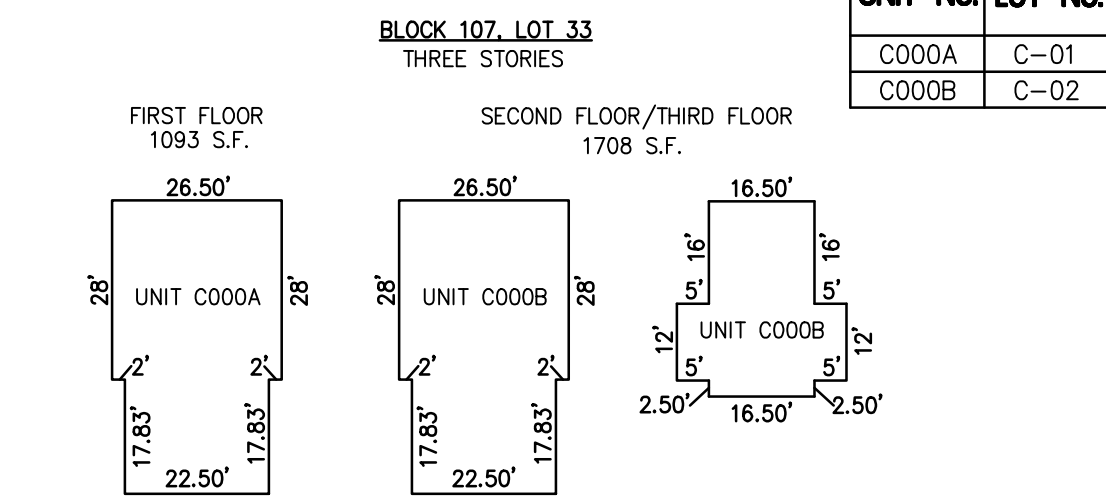

DETAILS
SCALE: 1"=30'

BLOCK 107, LOT 13
15 S. FRONTENAC AVENUE CONDOMINIUM
15 SOUTH FRONTENAC AVENUE
INSET "2W"

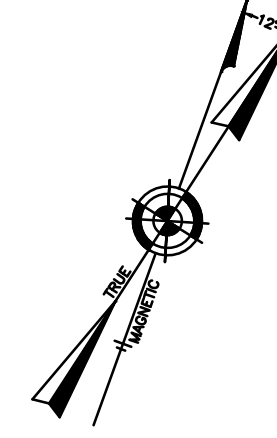

FRONTENAC AVENUE
(70' R.O.W.)

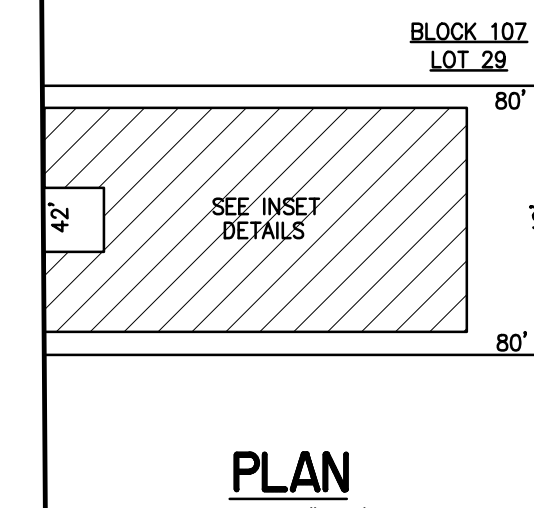

PLAN
SCALE: 1"=30'

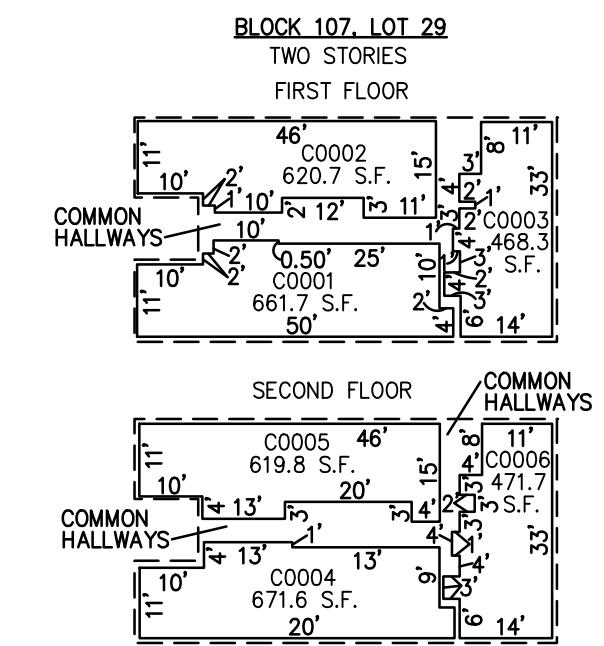

DETAILS
SCALE: 1"=30'

BLOCK 107, LOT 29
7 SOUTH CONDOMINIUM
7 SOUTH FRONTENAC AVENUE
INSET "2X"

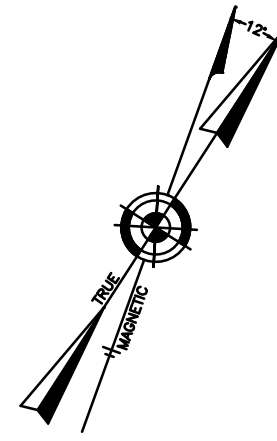

FRANKLIN AVENUE
(50' R.O.W.)

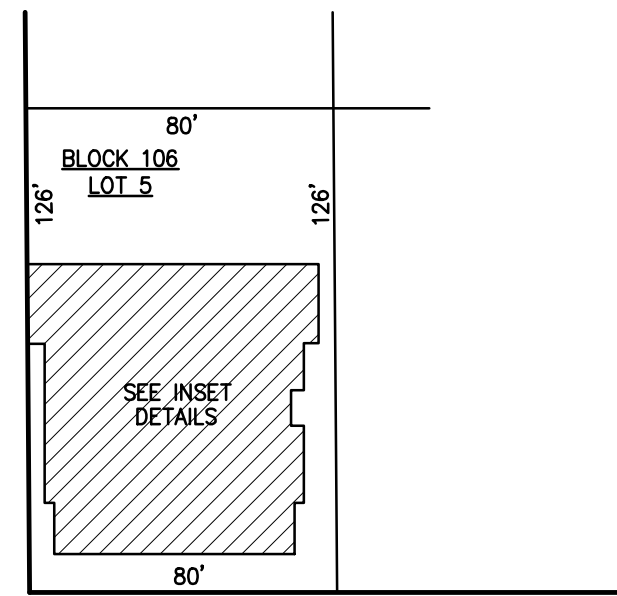

ATLANTIC AVENUE
(100' R.O.W.)

PLAN
SCALE: 1"=50'

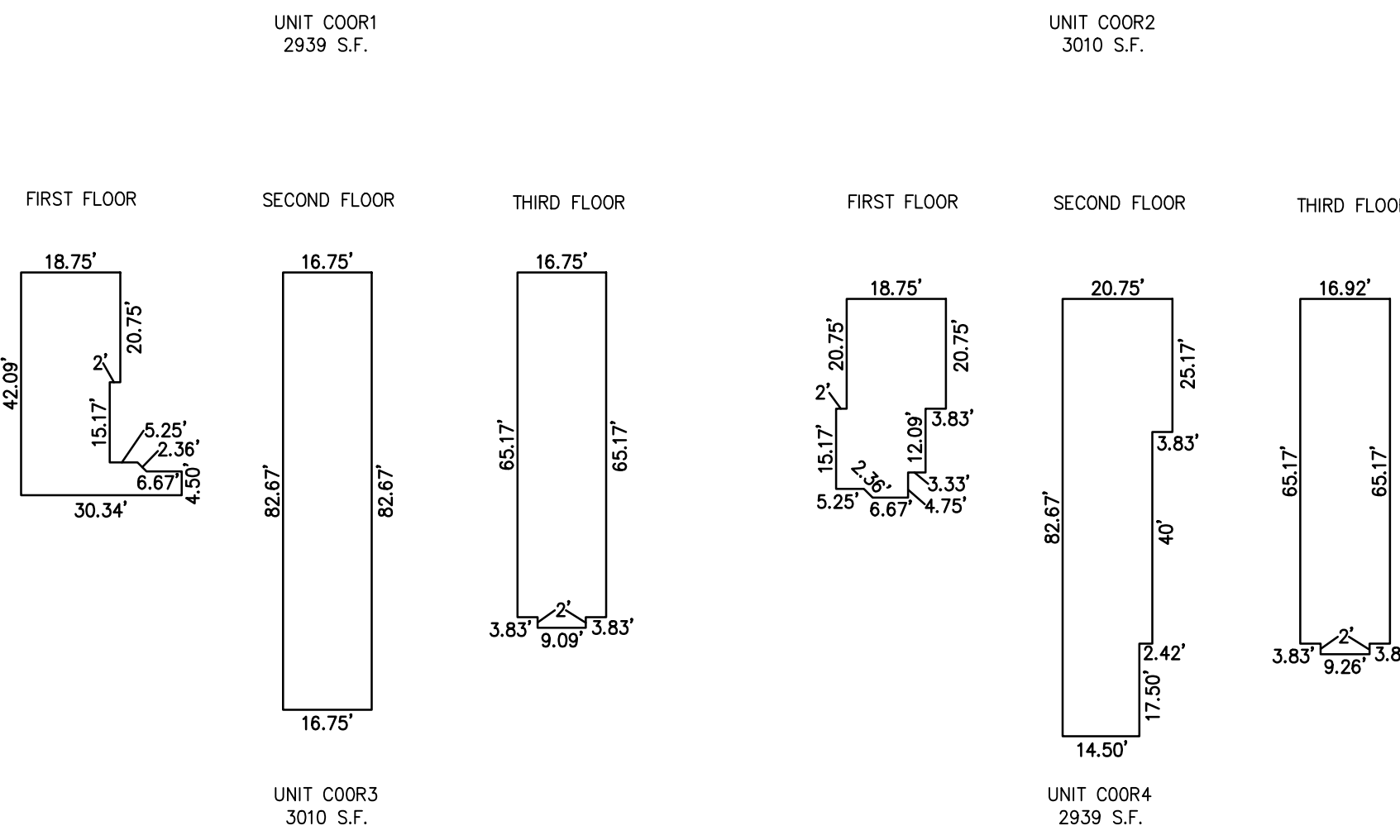
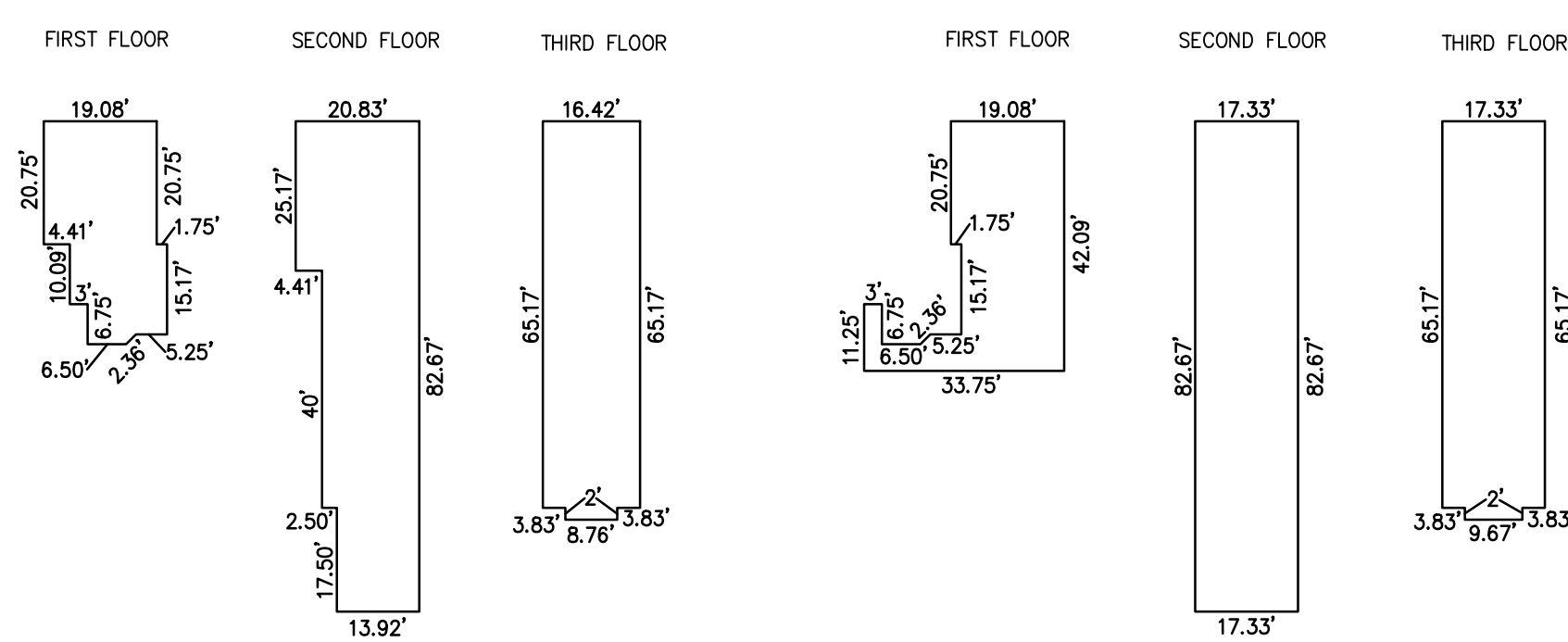
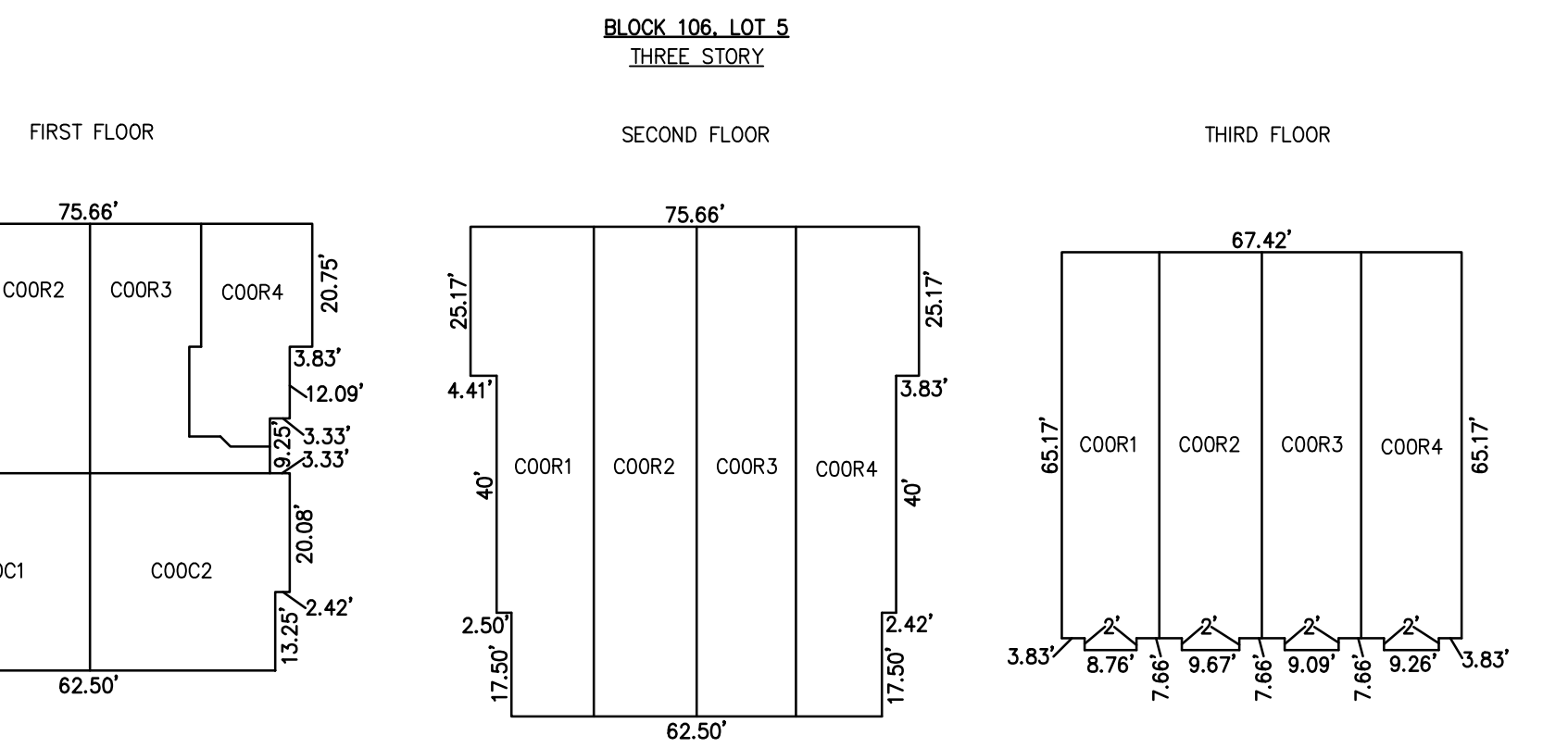
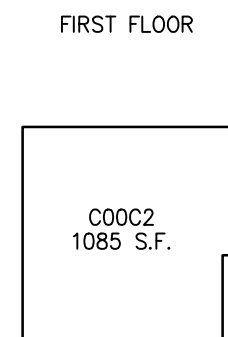
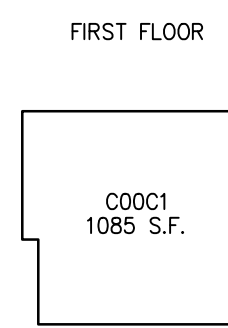

DETAILS
SCALE: 1"=30'

BLOCK 106, LOT 5
NORTHEAST FRANKLIN & ATLANTIC CONDOMINIUMS
7815 ATLANTIC AVENUE
INSET "30"

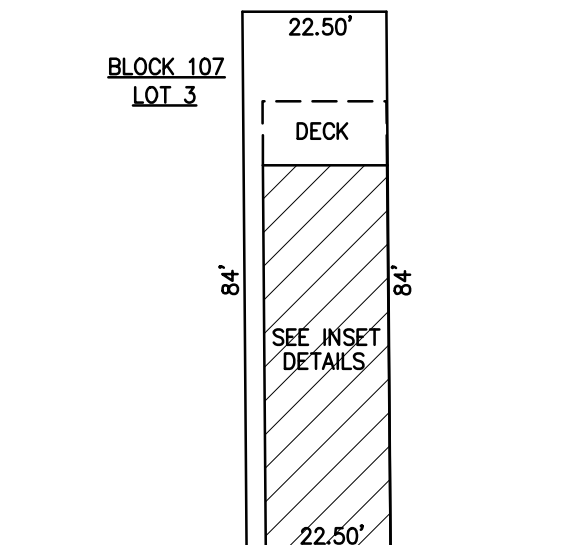
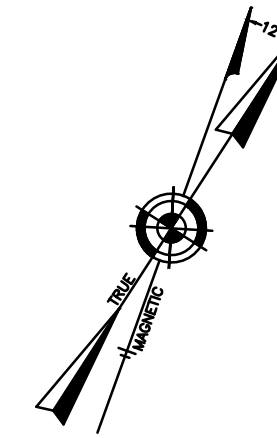

ATLANTIC AVENUE
(100' R.O.W.)

PLAN
SCALE: 1"=30'

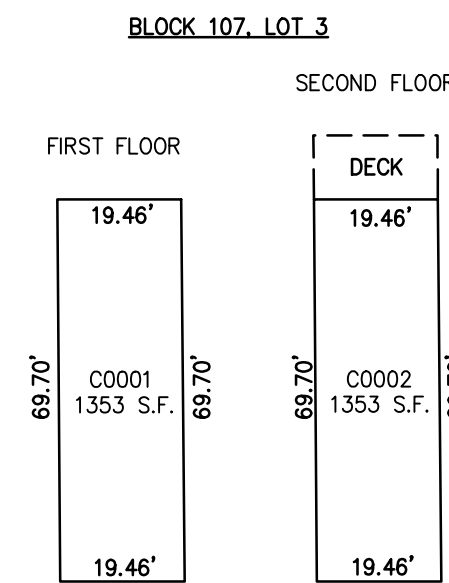

DETAILS
SCALE: 1"=30'

BLOCK 107, LOT 3
7907 ATLANTIC AVENUE CONDOMINIUM
7907 ATLANTIC AVENUE
INSET "2Y"

CONDOMINIUM DETAILS AND DIMENSIONS

- BLOCK 106, LOT 5
- BLOCK 107, LOT 3
- BLOCK 107, LOT 13
- BLOCK 107, LOT 29
- SEE PLATE I

"THIS TAX MAP PLATE HAS BEEN DIGITALLY DRAWN USING COMPUTER-AIDED DRAFTING/DESIGN (CADD) & COORDINATE GEOMETRY (COGO). IT IS BASED ON THE ORIGINAL DIGITALLY DRAWN TAX MAP PLATE BEARING THE OFFICIAL NEW JERSEY DIVISION TAXATION APPROVAL STAMP WITH APPROVAL DATE 6-3-2005, SERIAL NUMBER 848 AND SIGNATURES OF SIGNERS' THOMAS J. REILLY, CHIEF, LOCAL PROPERTY, FIELD ASSISTANCE. SANTO C. DIDONATO, SUPERVISING FIELD REPRESENTATIVE. THE ORIGINAL DIGITALLY DRAWN TAX MAP PLATE WITH THE OFFICIAL APPROVAL STAMP IS ON FILE WITH REMINGTON, VERNICK & WALBERG ENGINEERS."



TAX MAP
CITY OF MARGATE

ATLANTIC COUNTY NEW JERSEY
SCALE: AS NOTED DATE: 1-30-2004

CRAIG F. REMINGTON LAND SURVEYOR LIC. NO. 23924

REMINGTON, VERNICK & WALBERG ENGINEERS
24 GA 28048700
845 N MAIN STREET, PLEASANTVILLE, NJ 08232
(609) 645-710, FAX (609) 645-7076
WEB SITE ADDRESS: WWW.RVW.COM