

REVISIONS		
8-31-2009	CRAIG F. REMINGTON	23924
12-31-2010	CRAIG F. REMINGTON	23924

SHEET 15

SHEET 16

SHEET 9

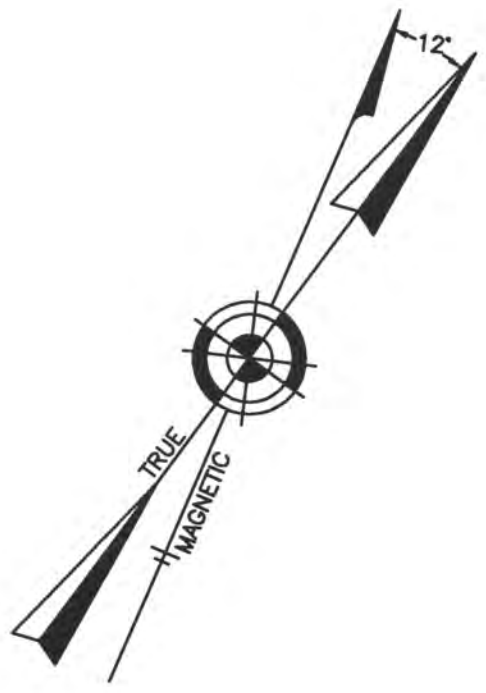
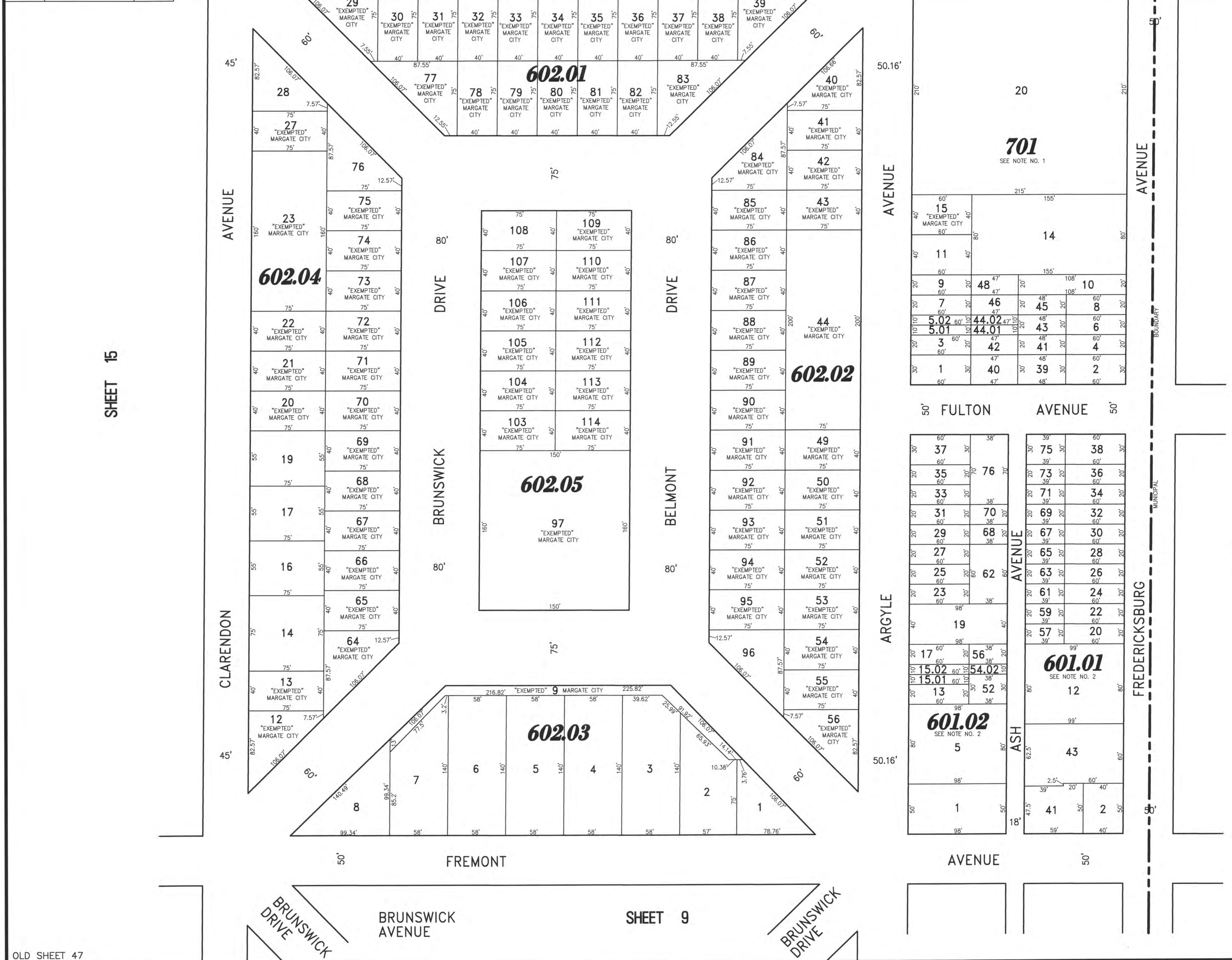

- NOTES:
1. BLOCK 701, LOTS 1-4, 5.01, 5.02, 6-9, 39-43, 44.01, 44.02, & 45-48 ARE ALL EXEMPTED PROPERTIES OWNED BY THE MARGATE CITY.
  2. BLOCK 601.01, LOTS 20, 22, 24, 26, 28, 30, 32, 34, 57, 59, 61, 63, 65, 67, 69, 71, & 73 ARE ALL EXEMPTED PROPERTIES, OWNED BY THE MARGATE CITY.
  3. BLOCK 601.02, LOTS 13, 15.01, 15.02, 17, 23, 25, 27, 29, 31, 33, 35, 37, 59.02, 56, 68, & 70 ARE ALL EXEMPTED PROPERTIES, OWNED BY THE MARGATE CITY.

"THIS TAX MAP PLATE HAS BEEN DIGITALLY DRAWN USING COMPUTER-AIDED DRAFTING/DESIGN (CADD) & COORDINATE GEOMETRY (COGO). IT IS BASED ON THE ORIGINAL DIGITALLY DRAWN TAX MAP PLATE BEARING THE OFFICIAL NEW JERSEY DIVISION TAXATION APPROVAL STAMP WITH APPROVAL DATE 6-3-2005 SERIAL NUMBER B46 AND SIGNATURES OF SIGNERS' THOMAS J. REILLY, CHIEF, LOCAL PROPERTY, FIELD ASSISTANCE. SANTO C. DIDONATO, SUPERVISING FIELD REPRESENTATIVE. THE ORIGINAL DIGITALLY DRAWN TAX MAP PLATE WITH THE OFFICIAL APPROVAL STAMP IS ON FILE WITH REMINGTON, VERNICK & WALBERG ENGINEERS."

### TAX MAP

#### CITY OF MARGATE

ATLANTIC COUNTY NEW JERSEY  
SCALE: 1" = 50' DATE: 11-01-2003

CRAIG F. REMINGTON LAND SURVEYOR LIC. NO. 23924

**RV & W** REMINGTON, VERNICK & WALBERG ENGINEERS  
24 GA 28048700  
845 N. MAIN STREET, PLEASANTVILLE, NJ 08232  
(609) 645-7100, FAX (609) 645-7076  
WEB SITE ADDRESS: WWW.RVW.COM