

REVISIONS

WPHA 2-21-89
WPHA 11-12-90
WPHA 10-28-91
WPHA 3-12-93
WPHA 4-12-96
WPHA 12-17-96

REVISIONS

DATE	LS NAME	LIC. NO.
9/29/98	MARTIN TIRELLA	27477
1/29/99	MARTIN F. TIRELLA	27477

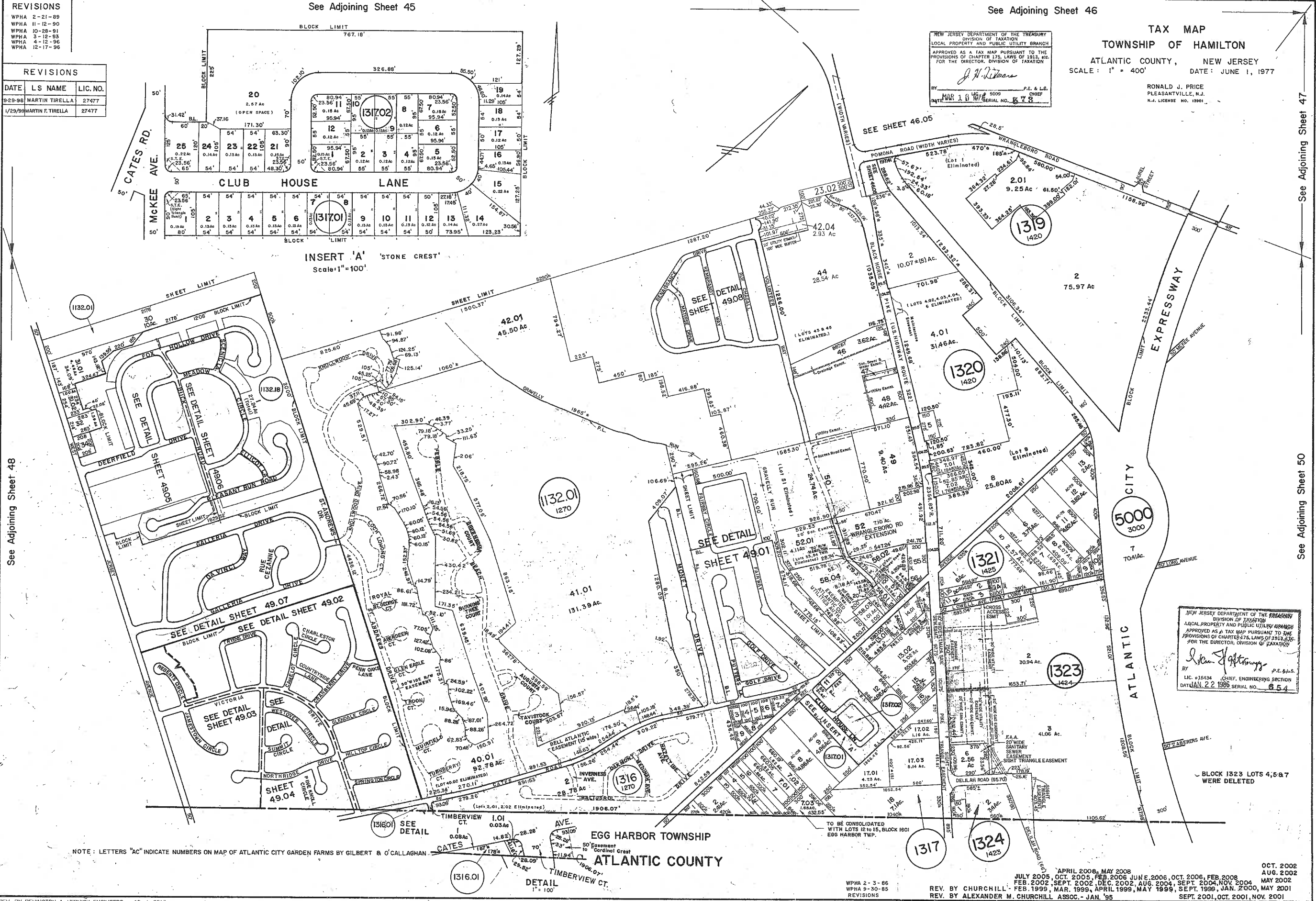

See Adjoining Sheet 48

See Adjoining Sheet 50

REV. BY REMINGTON & VERNICK ENGINEERS - 10-4-2013

NOTE: LETTERS "AC" INDICATE NUMBERS ON MAP OF ATLANTIC CITY GARDEN FARMS BY GILBERT & O'CALLAGHAN

EGG HARBOR TOWNSHIP
ATLANTIC COUNTY

WPHA 2-3-86
WPHA 9-30-85
REVISIONS

APRIL 2008, MAY 2008
JULY 2005, OCT. 2005, FEB. 2006, JUNE 2006, OCT. 2006, FEB. 2008
AUG. 2002
FEB. 2002, SEPT. 2002, DEC. 2002, AUG. 2004, SEPT. 2004, NOV. 2004
REV. BY CHURCHILL - FEB. 1999, MAR. 1999, APRIL 1999, MAY 1999, JAN. 2000, MAY 2001
REV. BY ALEXANDER M. CHURCHILL ASSOC. - JAN. '95
OCT. 2002
AUG. 2002
MAY 2002
SEPT. 2001, OCT. 2001, NOV. 2001

See Adjoining Sheet 46

NEW JERSEY DEPARTMENT OF THE TREASURY
DIVISION OF TAXATION
LOCAL PROPERTY AND PUBLIC UTILITY BRANCH
APPROVED AS A TAX MAP PURSUANT TO THE
PROVISIONS OF CHAPTER 178, LAWS OF 1983, AND
FOR THE DIRECTOR, DIVISION OF TAXATION

J. H. Williams
P.E. & L.S.
CHIEF
DATE: MAR 1 0 1999 SERIAL NO. 6578

TAX MAP
TOWNSHIP OF HAMILTON
ATLANTIC COUNTY, NEW JERSEY
SCALE: 1" = 400' DATE: JUNE 1, 1977

RONALD J. PRICE
PLEASANTVILLE, N.J.
N.J. LICENSE NO. 13901

NEW JERSEY DEPARTMENT OF THE TREASURY
DIVISION OF TAXATION
LOCAL PROPERTY AND PUBLIC UTILITY BRANCH
APPROVED AS A TAX MAP PURSUANT TO THE
PROVISIONS OF CHAPTER 178, LAWS OF 1983, AND
FOR THE DIRECTOR, DIVISION OF TAXATION

Alexander M. Churchill
P.E. & L.S.
CHIEF, ENGINEERING SECTION
DATE: JAN 22 1990 SERIAL NO. 654

BLOCK 1323 LOTS 4,5&7 WERE DELETED