

REVISIONS
WPHA 7-29-88

See Adjoining Sheet 42

TAX MAP
TOWNSHIP OF HAMILTON
ATLANTIC COUNTY, NEW JERSEY
SCALE: 1" = 100' DATE: JUNE 1, 1977

RONALD J. PRICE
PLEASANTVILLE, N.J.
N.J. LICENSE NO. 13901

NEW JERSEY DEPARTMENT OF THE TREASURY
LOCAL PROPERTY AND PUBLIC UTILITY BRANCH
APPROVED AS A TAX MAP PURSUANT TO THE
PROVISIONS OF CHAPTER 175, LAWS OF 1952, ETC.
FOR THE DIRECTOR, DIVISION OF TAXATION
BY: *[Signature]* P.E. & L.S.
L.I.C. 15436 CHIEF ENGINEERING SECTION
JAN 22 1966 SERIAL NO. 654

See Adjoining Sheet 42.03

See Adjoining Sheet 42

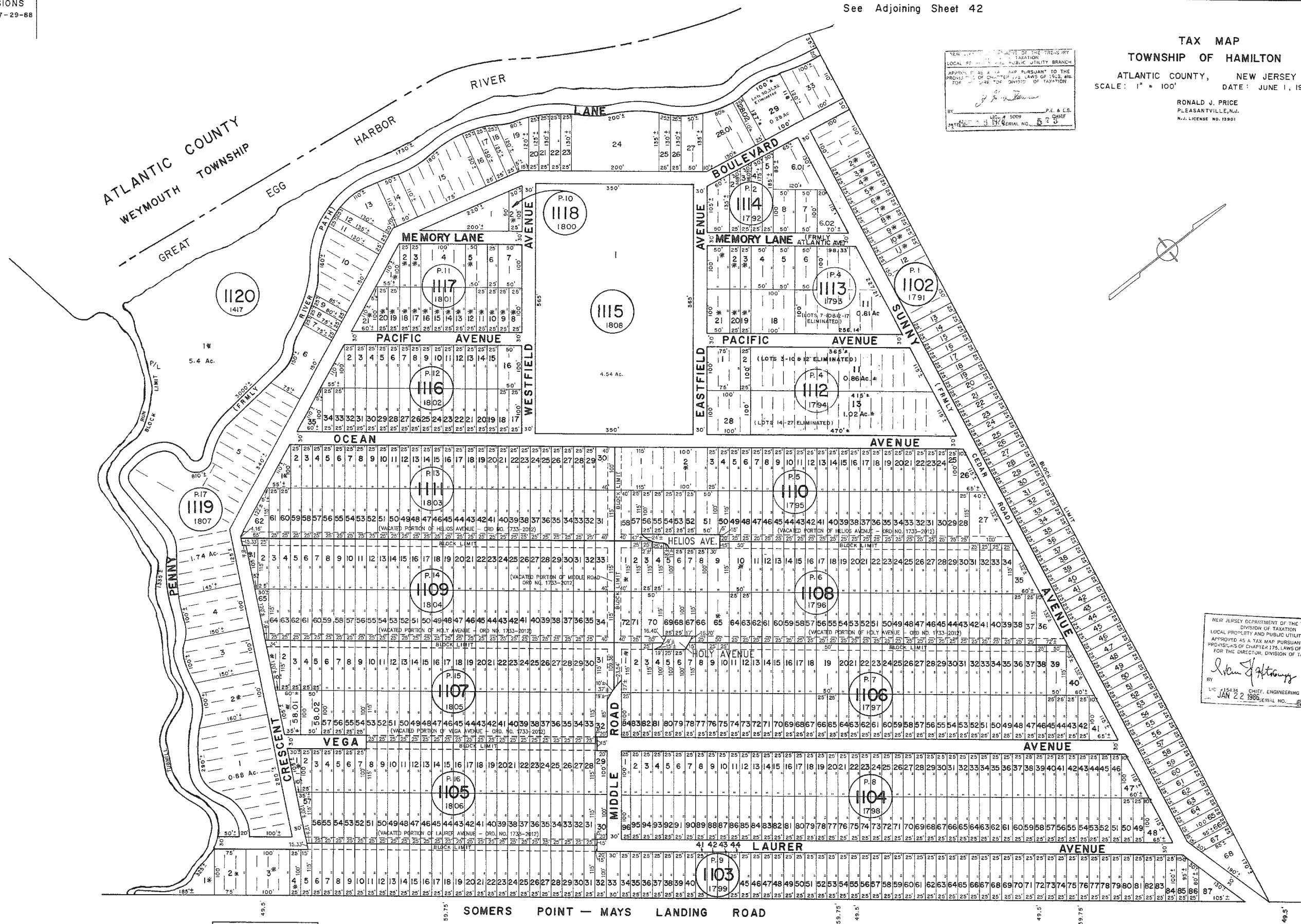

NOTE: LETTER "P" INDICATES NUMBER ON PLAN OF SUNSHINE PARK
* EXEMPT TOWNSHIP OF HAMILTON

See Adjoining Sheet 43

REVISED BY REMINGTON & VERNICK ENGINEERS - 1-8-2013
REV. BY ALEXANDER M. CHURCHILL ASSOC. - JAN. '95

JULY 2001, FEB. 2008
REV. BY CHURCHILL - FEB. 2000, MAR. 2000, MAY 2001