

| REVISIONS | | |
|-----------|--------------------|----------|
| DATE | L.S. NAME | LIC. No. |
| 2-4-98 | MARTIN F. TIRELLA | 27477 |
| 1-5-13 | CRAIG F. REMINGTON | 23924 |

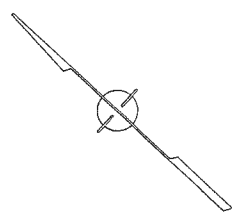

ATLANTIC COUNTY
GALLOWAY TOWNSHIP

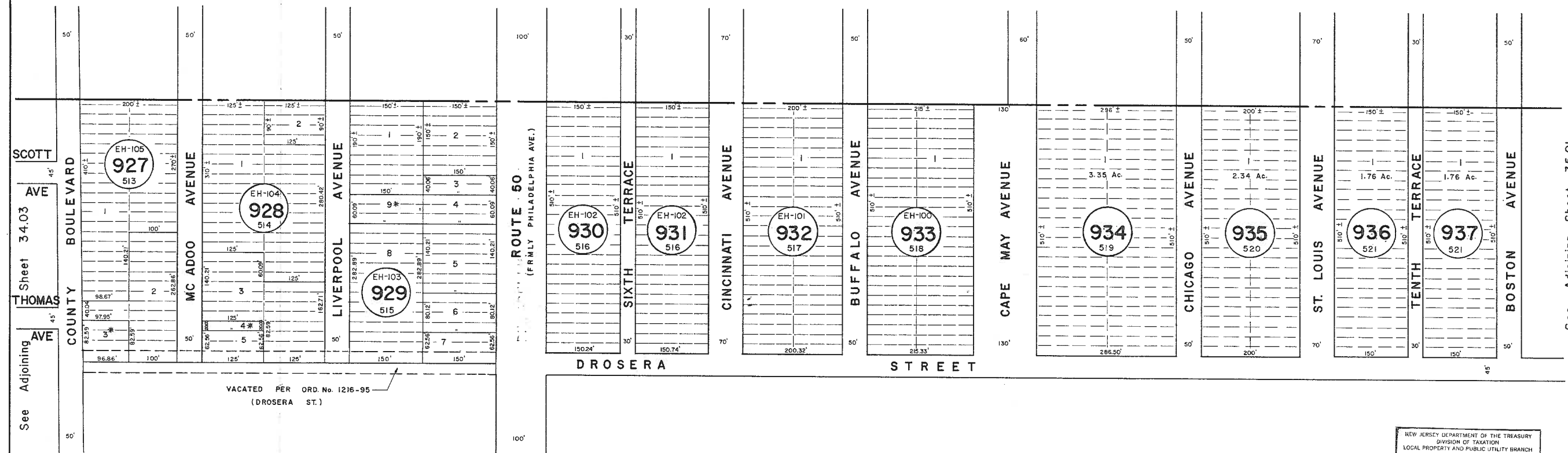

See Adjoining Sheet 34.03
See Adjoining Sheet 35.01

See Adjoining Sheet 35.01

NEW JERSEY DEPARTMENT OF THE TREASURY
DIVISION OF TAXATION
LOCAL PROPERTY AND PUBLIC UTILITY BRANCH
APPROVED AS A TAX MAP PURSUANT TO THE
PROVISIONS OF CHAPTER 175, LAWS OF 1913, ETC.
FOR THE DIRECTOR, DIVISION OF TAXATION
[Signature]
BY: P.E. & L.S.
LIC #15434 CHIEF, ENGINEERING SECTION
DATE: JAN 22 1996 SERIAL NO. 554

NEW JERSEY DEPARTMENT OF THE TREASURY
DIVISION OF TAXATION
LOCAL PROPERTY AND PUBLIC UTILITY BRANCH
APPROVED AS A TAX MAP PURSUANT TO THE
PROVISIONS OF CHAPTER 175, LAWS OF 1913, ETC.
FOR THE DIRECTOR, DIVISION OF TAXATION
[Signature]
BY: P.E. & L.S.
LIC # 5009 CHIEF
DATE: MAR 16 1999 SERIAL NO. 578

TAX MAP
TOWNSHIP OF HAMILTON
ATLANTIC COUNTY, NEW JERSEY
SCALE: 1" = 100' DATE: JUNE 1, 1977

RONALD J. PRICE
PLEASANTVILLE, N.J.
N.J. LICENSE NO. 15961

* EXEMPT TOWNSHIP OF HAMILTON
LETTER 'E.H.' INDICATES NUMBER ON MAP OF EGG HARBOR CITY MANOR

See Adjoining Sheet 34

REV. BY CHURCHILL - FEB. 2008
REV. BY ALEXANDER M. CHURCHILL ASSOC. - JAN '95