

REVISIONS

WPHA 8-16-90
WPHA 11-7-91
WPHA 12-5-96

REVISIONS

DATE	L.S. NAME	LIC. NUMBER
10-13-97	KENNETH P FRANK	LS36727
12-31-97	MARTIN F TIRELLA	LS 27477
1-20-98	MARTIN F TIRELLA	LS 27477
2-4-98	MARTIN F TIRELLA	LS 27477

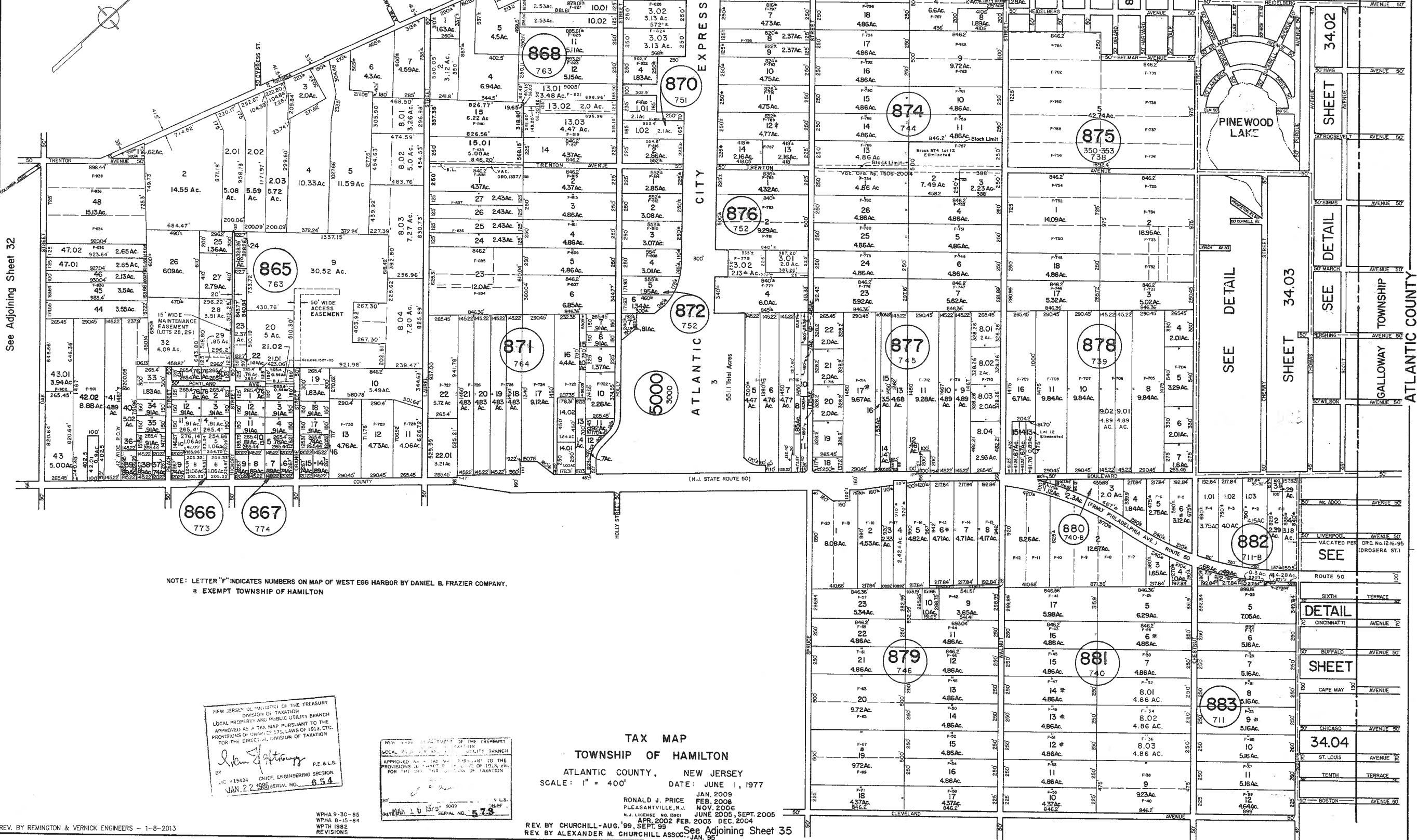

See Adjoining Sheet 32

See Adjoining Sheet 33

See Adjoining Sheet 21

NOTE: LETTER "F" INDICATES NUMBERS ON MAP OF WEST EGG HARBOR BY DANIEL B. FRAZIER COMPANY.
 * EXEMPT TOWNSHIP OF HAMILTON

NEW JERSEY DEPARTMENT OF THE TREASURY
 DIVISION OF TAXATION
 LOCAL PROPERTY AND PUBLIC UTILITY BRANCH
 APPROVED AS A TAX MAP PURSUANT TO THE
 PROVISIONS OF CHAPTER 175, LAWS OF 1913, ETC.
 FOR THE DIRECTOR, DIVISION OF TAXATION

[Signature] P.E. & L.S.
 LIC. 15434 CHIEF, ENGINEERING SECTION
 JAN. 22 1998 SERIAL NO. 654

NEW JERSEY DEPARTMENT OF THE TREASURY
 DIVISION OF TAXATION
 LOCAL PROPERTY AND PUBLIC UTILITY BRANCH
 APPROVED AS A TAX MAP PURSUANT TO THE
 PROVISIONS OF CHAPTER 175, LAWS OF 1913, ETC.
 FOR THE DIRECTOR, DIVISION OF TAXATION

[Signature] L.S.
 LIC. 15434 CHIEF, ENGINEERING SECTION
 JAN. 10 1997 SERIAL NO. 573

TAX MAP
 TOWNSHIP OF HAMILTON
 ATLANTIC COUNTY, NEW JERSEY
 SCALE: 1" = 400' DATE: JUNE 1, 1977

RONALD J. PRICE
 PLEASANTVILLE, N.J.
 NOV. 2006
 N.J. LICENSE NO. 13901
 APR. 2002 FEB. 2003 DEC. 2004

REV. BY CHURCHILL-AUG. '99, SEPT. 99
 REV. BY ALEXANDER M. CHURCHILL ASSOC. JAN. 95

REV. BY REMINGTON & VERNICK ENGINEERS - 1-8-2013

WPHA 9-30-85
WPHA 8-15-84
WPH 1982
REVISIONS

SEE DETAIL SHEET 34.01
 SEE DETAIL SHEET 34.02
 SEE DETAIL SHEET 34.03
 SEE DETAIL SHEET 34.04

PINWOOD LAKE

ATLANTIC COUNTY
 GALLOWAY TOWNSHIP