

See Adjoining Sheet 31.02

REVISIONS		
DATE	LS NAME	LIC. No.
4-27-98	MARTIN F TIRELLA	LS 27477

TAX MAP
TOWNSHIP OF HAMILTON
 ATLANTIC COUNTY, NEW JERSEY
 SCALE: 1" = 100' DATE: JUNE 1, 1977

RONALD J. PRICE
 PLEASANTVILLE, N.J.
 N.J. LICENSE NO. 13901

NEW JERSEY DEPARTMENT OF THE TREASURY
 DIVISION OF TAXATION
 LOCAL PROPERTY AND PUBLIC UTILITY BRANCH
 APPROVED AS A TAX MAP PURSUANT TO THE
 PROVISIONS OF CHAPTER 175, LAWS OF 1976, ETC.
 FOR THE DIRECTOR, DIVISION OF TAXATION

Ronald J. Price P.E. & L.S.
 BY: LIC. #15434 CHIEF, ENGINEERING SECTION
 DATE: JAN 22 1985 SERIAL NO. 654

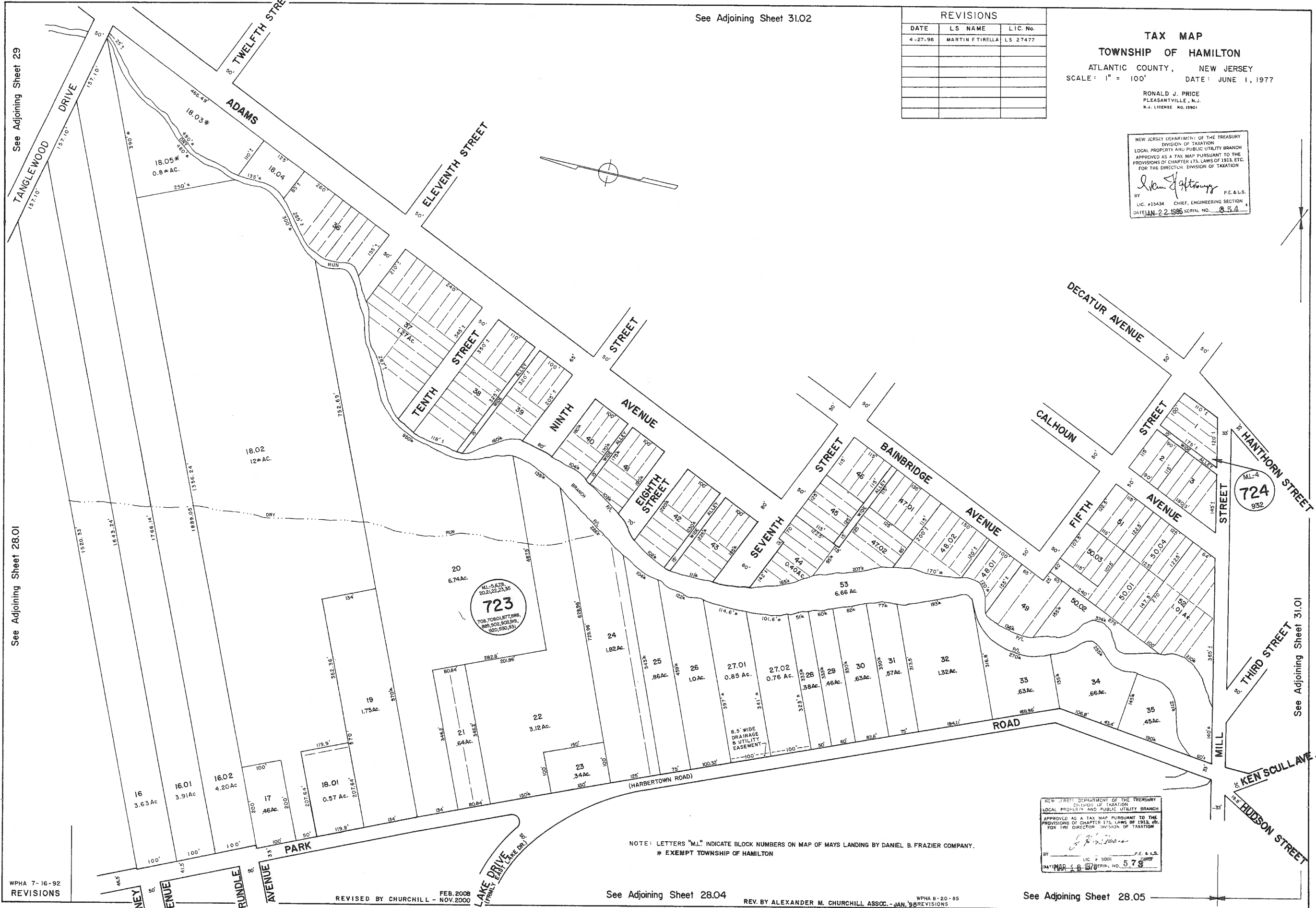

WPHA 7-16-92
 REVISIONS

REVISED BY CHURCHILL - FEB. 2008
 NOV. 2000

See Adjoining Sheet 28.04

REV. BY ALEXANDER M. CHURCHILL ASSOC. - JAN. 98 REVISIONS

WPHA 8-20-85

See Adjoining Sheet 28.05

NEW JERSEY DEPARTMENT OF THE TREASURY
 DIVISION OF TAXATION
 LOCAL PROPERTY AND PUBLIC UTILITY BRANCH
 APPROVED AS A TAX MAP PURSUANT TO THE
 PROVISIONS OF CHAPTER 175, LAWS OF 1976, ETC.
 FOR THE DIRECTOR, DIVISION OF TAXATION

Ronald J. Price P.E. & L.S.
 BY: LIC. #15434 CHIEF, ENGINEERING SECTION
 DATE: MAR 18 1978 SERIAL NO. 578