

ATLANTIC COUNTY
MULLICA TOWNSHIP

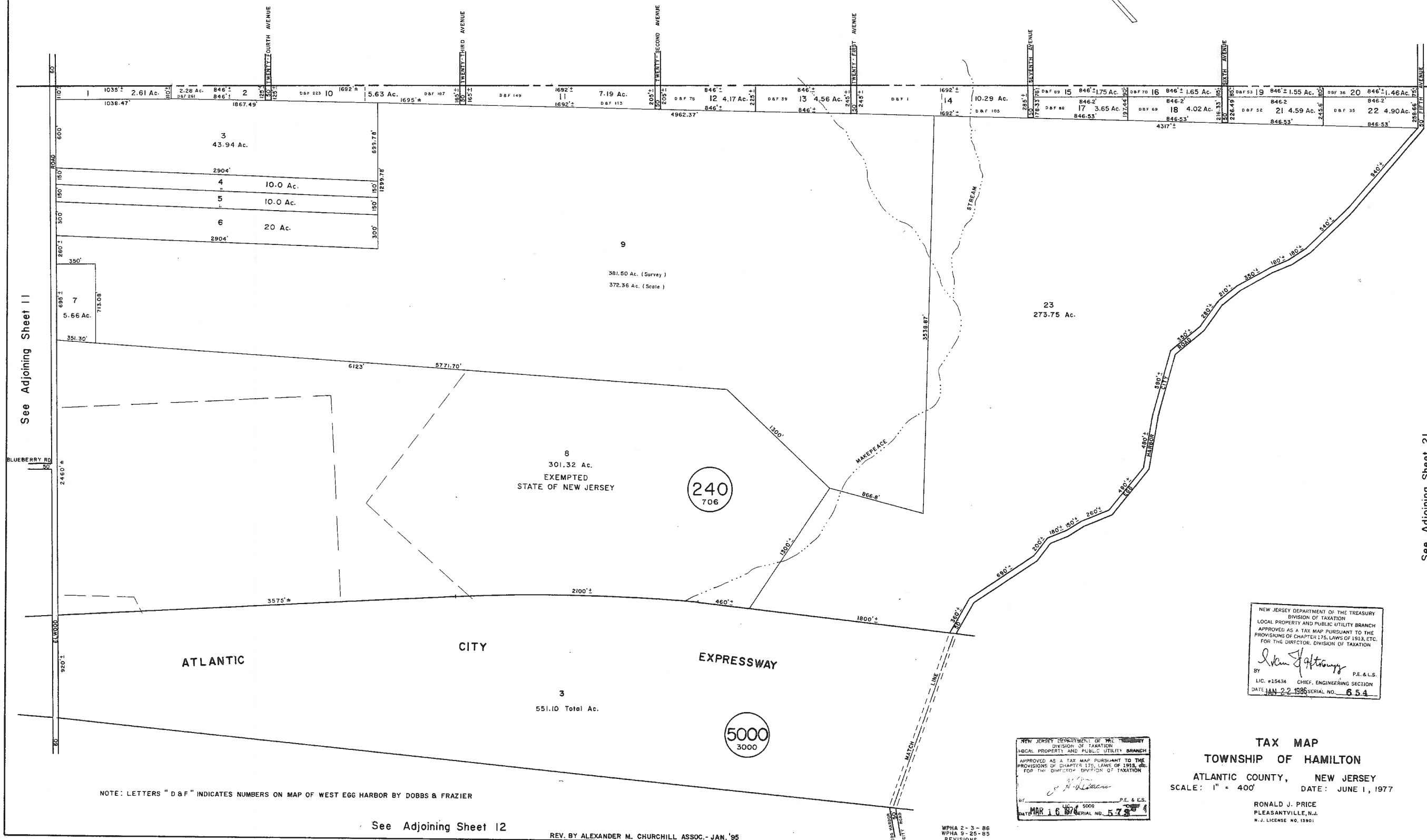
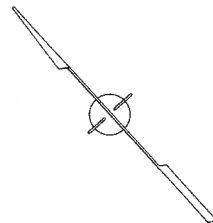

See Adjoining Sheet 11

See Adjoining Sheet 21

NOTE: LETTERS "D & F" INDICATES NUMBERS ON MAP OF WEST EGG HARBOR BY DOBBS & FRAZIER

See Adjoining Sheet 12

REV. BY ALEXANDER M. CHURCHILL ASSOC. - JAN. '95

WPHA 2-3-86
WPHA 9-25-85
REVISIONS

NEW JERSEY DEPARTMENT OF THE TREASURY
DIVISION OF TAXATION
LOCAL PROPERTY AND PUBLIC UTILITY BRANCH
APPROVED AS A TAX MAP PURSUANT TO THE
PROVISIONS OF CHAPTER 175, LAWS OF 1913, ETC.
FOR THE DIRECTOR, DIVISION OF TAXATION
Alexander M. Churchill
BY: P.E. & L.S.
LIC. #15434 CHIEF, ENGINEERING SECTION
DATE: JAN 22 1985 SERIAL NO. 654

NEW JERSEY DEPARTMENT OF THE TREASURY
DIVISION OF TAXATION
LOCAL PROPERTY AND PUBLIC UTILITY BRANCH
APPROVED AS A TAX MAP PURSUANT TO THE
PROVISIONS OF CHAPTER 175, LAWS OF 1913, ETC.
FOR THE DIRECTOR, DIVISION OF TAXATION
Alexander M. Churchill
BY: P.E. & L.S.
LIC. #15434 CHIEF, ENGINEERING SECTION
DATE: MAR 16 1978 SERIAL NO. 578

TAX MAP
TOWNSHIP OF HAMILTON
ATLANTIC COUNTY, NEW JERSEY
SCALE: 1" = 400' DATE: JUNE 1, 1977

RONALD J. PRICE
PLEASANTVILLE, N.J.
N.J. LICENSE NO. 12901