

See Adjoining Sheet 5.04

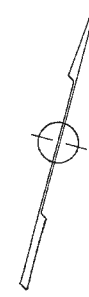

See Adjoining Sheet 5.07

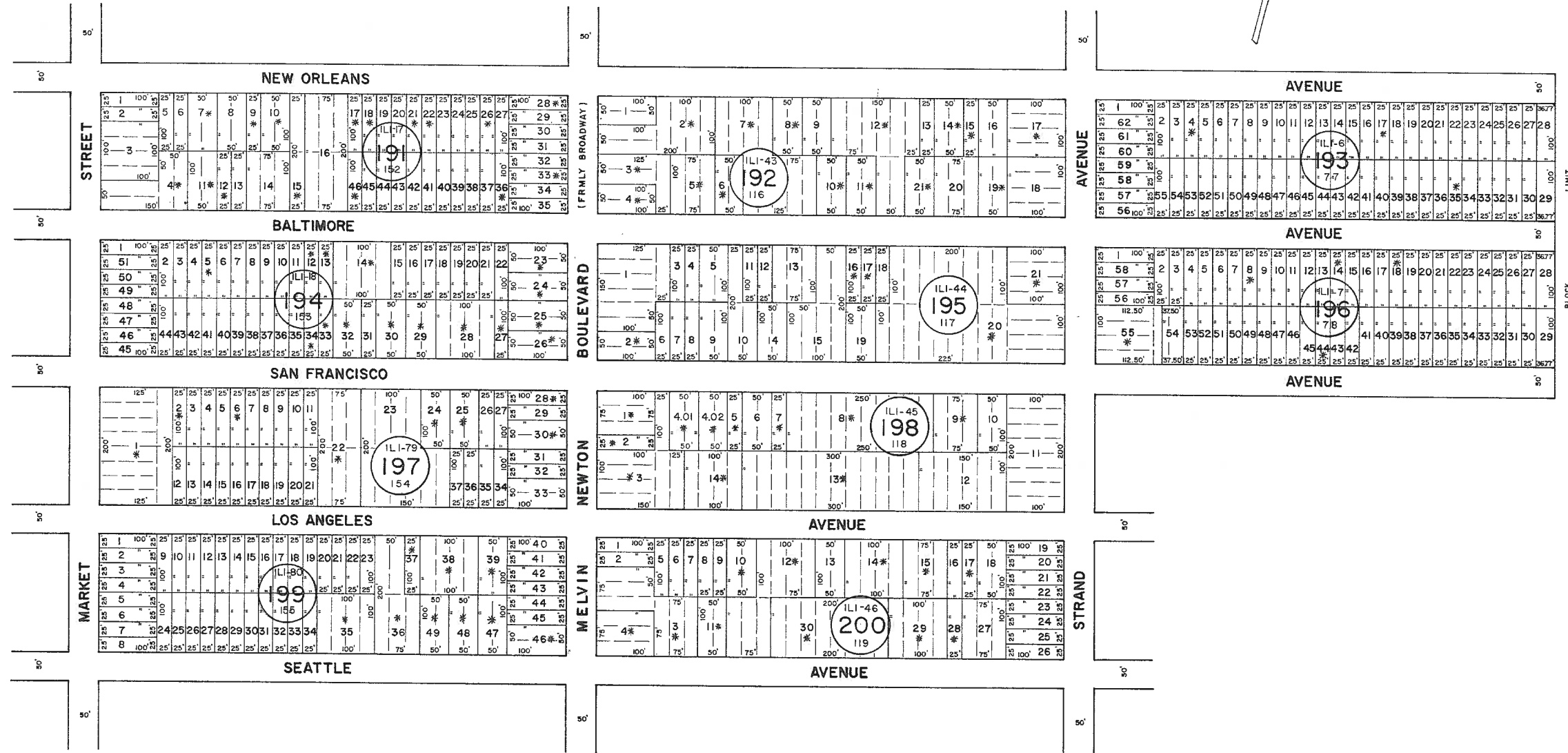

See Adjoining Sheet 5

NOTE: LETTERS "ILI" INDICATES NUMBER ON MAP OF INDUSTRIAL LAND COMPANY

\* EXEMPT TOWNSHIP OF HAMILTON

REV. BY CHURCHILL - FEB. 2008  
REV. BY ALEXANDER M. CHURCHILL ASSOC. - JAN. '95

See Adjoining Sheet 14.04

NEW JERSEY DEPARTMENT OF THE TREASURY  
DIVISION OF TAXATION  
LOCAL PROPERTY AND PUBLIC UTILITY BRANCH  
APPROVED AS A TAX MAP PURSUANT TO THE  
PROVISIONS OF CHAPTER 175, LAWS OF 1913, ETC.  
FOR THE DIRECTOR, DIVISION OF TAXATION

*J. N. DiVito*  
BY P.E. & L.S.  
LIC. #15434 CHIEF, ENGINEERING SECTION  
DATE JAN 22 1996 SERIAL NO. 654

NEW JERSEY DEPARTMENT OF THE TREASURY  
DIVISION OF TAXATION  
LOCAL PROPERTY AND PUBLIC UTILITY BRANCH  
APPROVED AS A TAX MAP PURSUANT TO THE  
PROVISIONS OF CHAPTER 175, LAWS OF 1913, ETC.  
FOR THE DIRECTOR, DIVISION OF TAXATION

*J. N. DiVito*  
BY P.E. & L.S.  
LIC. # 5009  
DATE MAR 18 1997 SERIAL NO. 579

TAX MAP  
TOWNSHIP OF HAMILTON  
ATLANTIC COUNTY, NEW JERSEY  
SCALE: 1" = 100' DATE: JUNE 1, 1977

RONALD J. PRICE  
PLEASANTVILLE, N.J.  
N.J. LICENSE NO. 19901

WPHA 5-7-84 REVISIONS