

See Adjoining Sheet 5.01

ATLANTIC COUNTY  
BUENA VISTA TOWNSHIP

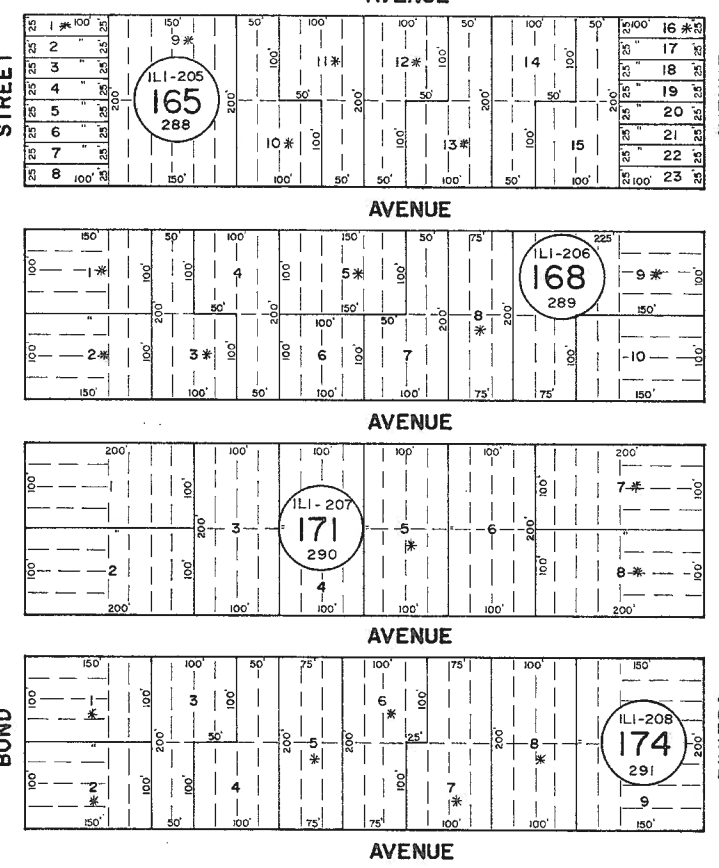
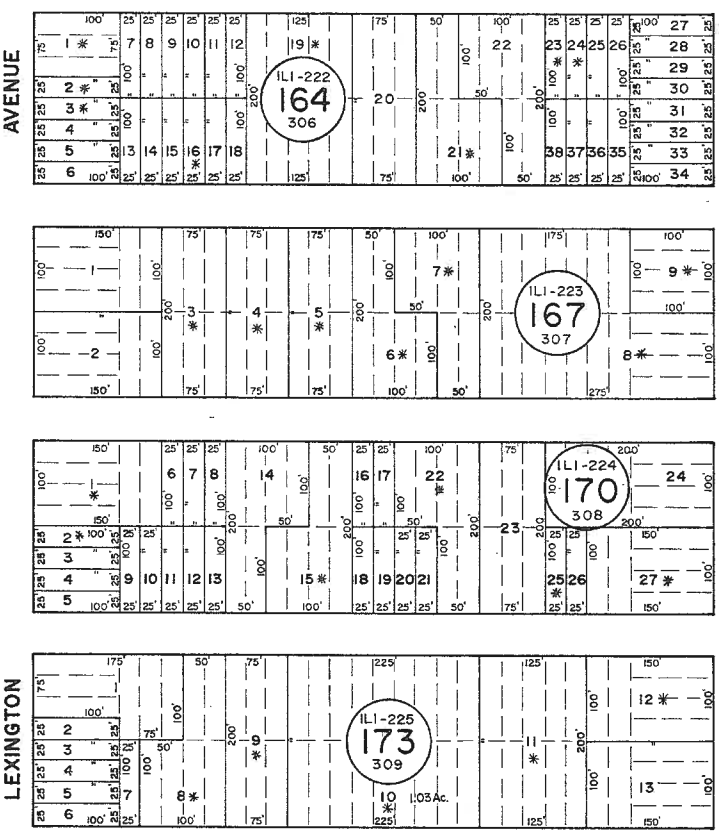

NOTE: LETTERS "ILI" INDICATES NUMBER ON MAP OF INDUSTRIAL LAND COMPANY  
\* EXEMPT TOWNSHIP OF HAMILTON

REV. BY R&V - 1-8-2013  
REV. BY CHURCHILL - FEB. 2008

See Adjoining Sheet 14.01

NEW JERSEY DEPARTMENT OF THE TREASURY  
DIVISION OF TAXATION  
LOCAL PROPERTY AND PUBLIC UTILITY BRANCH  
APPROVED AS A TAX MAP PURSUANT TO THE  
PROVISIONS OF CHAPTER 175, LAWS OF 1993, ETC.  
FOR THE DIRECTOR, DIVISION OF TAXATION

*J. H. [Signature]*  
LIC. # 15434 P.E. & L.S.  
DATE MAR 16 1997 SERIAL NO. 573

NEW JERSEY DEPARTMENT OF THE TREASURY  
DIVISION OF TAXATION  
LOCAL PROPERTY AND PUBLIC UTILITY BRANCH  
APPROVED AS A TAX MAP PURSUANT TO THE  
PROVISIONS OF CHAPTER 175, LAWS OF 1993, ETC.  
FOR THE DIRECTOR, DIVISION OF TAXATION

*[Signature]*  
LIC. # 15434 P.E. & L.S.  
DATE JAN 22 1986 SERIAL NO. 574

TAX MAP  
TOWNSHIP OF HAMILTON  
ATLANTIC COUNTY, NEW JERSEY  
SCALE: 1" = 100' DATE: JUNE 1, 1977

RONALD J. PRICE  
PLEASANTVILLE, N.J.  
N.J. LICENSE NO. 12991

See Adjoining Sheet 5.06