

REVISIONS		
DATE	L.S. NAME	L.I.C. NUMBER
10-24-97	KENNETH P FRANK	LS 36727
5-2012	ORAG F. REMINGTON	LS 23924

TAX MAP
TOWNSHIP OF HAMILTON
 ATLANTIC COUNTY, NEW JERSEY
 SCALE: 1" = 400'
 DATE: JUNE 1, 1977

RONALD J. PRICE
 PLEASANTVILLE, N.J.
 N.J. LICENSE NO. 13901

NEW JERSEY DEPARTMENT OF THE TREASURY
 DIVISION OF TAXATION
 LOCAL PROPERTY AND PUBLIC UTILITY BRANCH
 APPROVED AS A TAX MAP PURSUANT TO THE
 PROVISIONS OF CHAPTER 175, LAWS OF 1953, ETC.
 FOR THE DIRECTOR, DIVISION OF TAXATION
 BY: *[Signature]* P.E. & L.S.
 L.I.C. #1546
 JAN 22 1986 SERIAL NO. 573

NEW JERSEY DEPARTMENT OF THE TREASURY
 DIVISION OF TAXATION
 LOCAL PROPERTY AND PUBLIC UTILITY BRANCH
 APPROVED AS A TAX MAP PURSUANT TO THE
 PROVISIONS OF CHAPTER 175, LAWS OF 1953, ETC.
 FOR THE DIRECTOR, DIVISION OF TAXATION
 BY: *[Signature]* P.E. & L.S.
 L.I.C. #1546
 JAN 22 1986 SERIAL NO. 574

NOTE: LETTERS "L.I." INDICATE NUMBERS ON MAP OF INDUSTRIAL LAND COMPANY.
 LETTER "W" INDICATE NUMBER ON MAP OF WEYMOUTH FARM & AGRICULTURAL COMPANY
 * EXEMPT TOWNSHIP OF HAMILTON

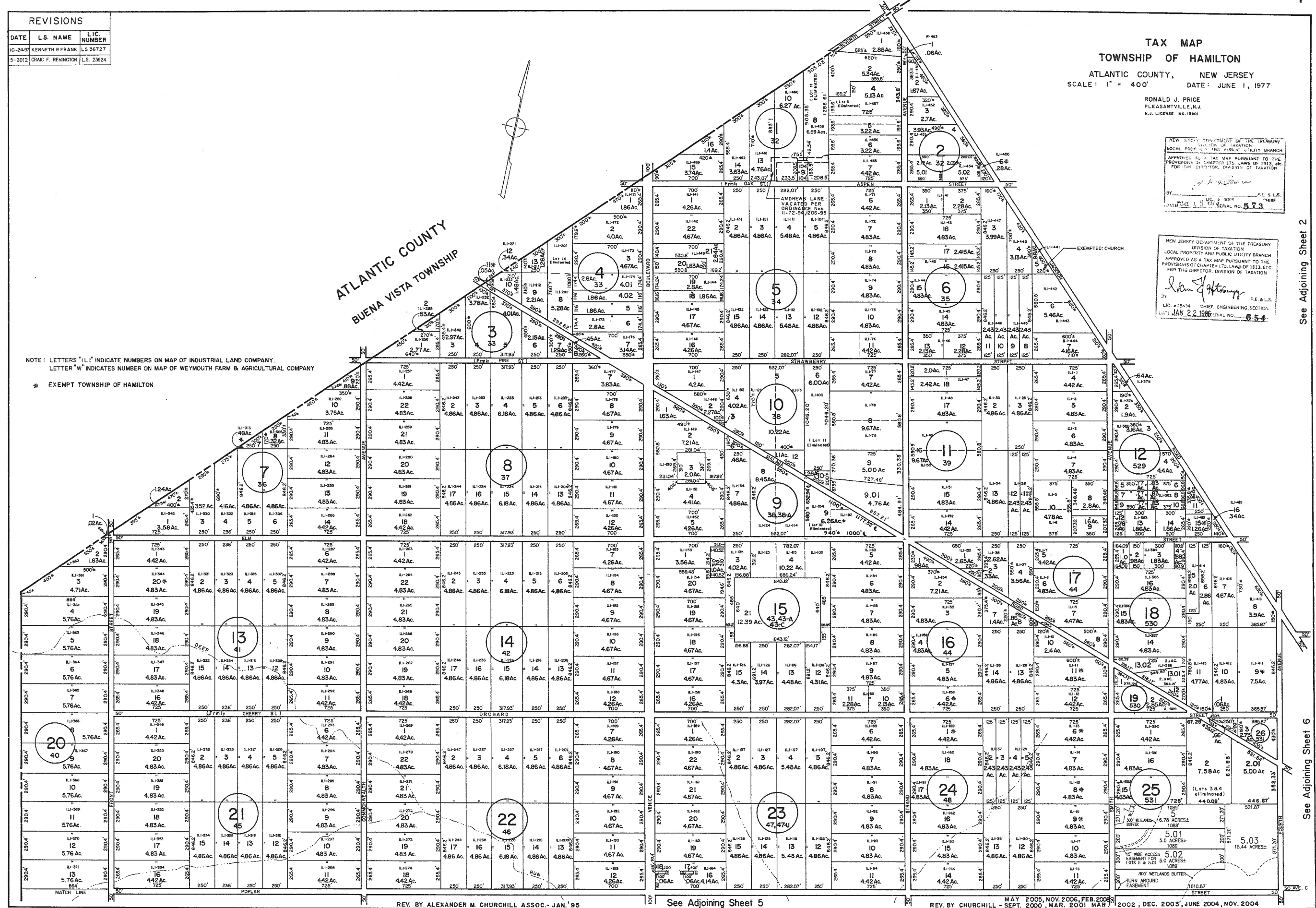

REV. BY ALEXANDER M. CHURCHILL ASSOC.- JAN. '95

See Adjoining Sheet 5

MAY 2005, NOV. 2006, FEB. 2008
 REV. BY CHURCHILL - SEPT. 2000, MAR. 2001, MAR. 2002, DEC. 2003, JUNE 2004, NOV. 2004

See Adjoining Sheet 2

See Adjoining Sheet 6