

See Adjoining Sheet 45

See Adjoining Sheet 48

See Adjoining Sheet 44

See Adjoining Sheet 48.02

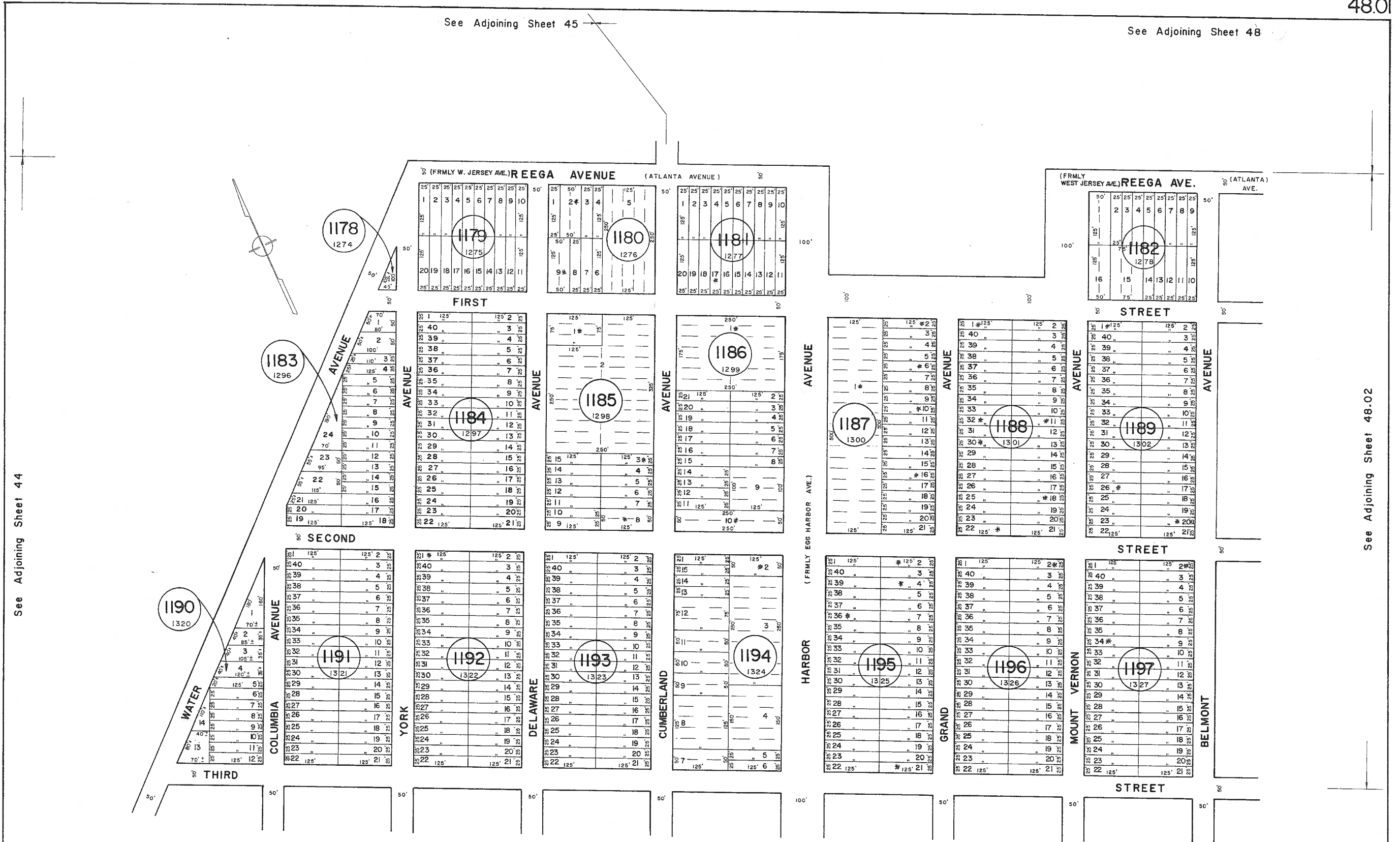

* EXEMPT TOWNSHIP OF HAMILTON

See Adjoining Sheet 48.04

NEW JERSEY DEPARTMENT OF THE TREASURY
 DIVISION OF TAXATION
 LOCAL PROPERTY AND PUBLIC UTILITY BRANCH
 APPROVED AS A TAX MAP PURSUANT TO THE
 PROVISIONS OF CHAPTER 175, LAWS OF 1913, ETC.
 FOR THE DIRECTOR, DIVISION OF TAXATION

Alexander M. Churchill
 BY: P.E. & L.S.
 LIC. #15434 CHIEF, ENGINEERING SECTION
 DATE: JAN 22 1986 SERIAL NO. 654

NEW JERSEY DEPARTMENT OF THE TREASURY
 DIVISION OF TAXATION
 LOCAL PROPERTY AND PUBLIC UTILITY BRANCH
 APPROVED AS A TAX MAP PURSUANT TO THE
 PROVISIONS OF CHAPTER 175, LAWS OF 1913, ETC.
 FOR THE DIRECTOR, DIVISION OF TAXATION

Ronald J. Price
 BY: P.E. & L.S.
 LIC. #16150 CHIEF, ENGINEERING SECTION
 DATE: MAR 16 1986 SERIAL NO. 578

TAX MAP
 TOWNSHIP OF HAMILTON
 ATLANTIC COUNTY, NEW JERSEY
 SCALE: 1" = 100' DATE: JUNE 1, 1977

RONALD J. PRICE
 PLEASANTVILLE, N.J.
 N.J. LICENSE NO. 13901

REV. BY ALEXANDER M. CHURCHILL, ASSOC. - JAN. '85
 REV. BY CHURCHILL - FEB. 2008