

REVISIONS

WPHA 7-23-92
WPHA 7-16-96

DATE	L.S. NAME	LIC. No
	KENNETH P. FRANK	L.S. 36727
1-8-2013	CRAIG F. REMINGTON	L.S. 23924
10-4-2013	CRAIG F. REMINGTON	L.S. 23924
4-3-2014	CHARLES E. ADAMSON	L.S. 42627

See Adjoining Sheet 16

NOTE: THE APPARENT GORE LINES & DIMENSIONS SHOWN ARE PLOTTED IN ACCORDANCE WITH THE METES & BOUNDS DESCRIPTIONS APPEARING IN THE LAST DEED/FILED PLAN OF RECORD FOR EACH PARCEL/SUBDIVISION & DO NOT PURPORT TO REPRESENT TITLE OR OWNERSHIP STATUS IN ANY MANNER. THESE SITUATIONS ARE SUBJECT TO SOLUTION BY THE PROPERTY OWNERS CONCERNED. OWNERSHIP UNKNOWN.

NOTE: LETTERS "660" INDICATE NUMBERS ON MAP OF RICHLAND COLONY BY GILBERT & O'CALLAGHAN

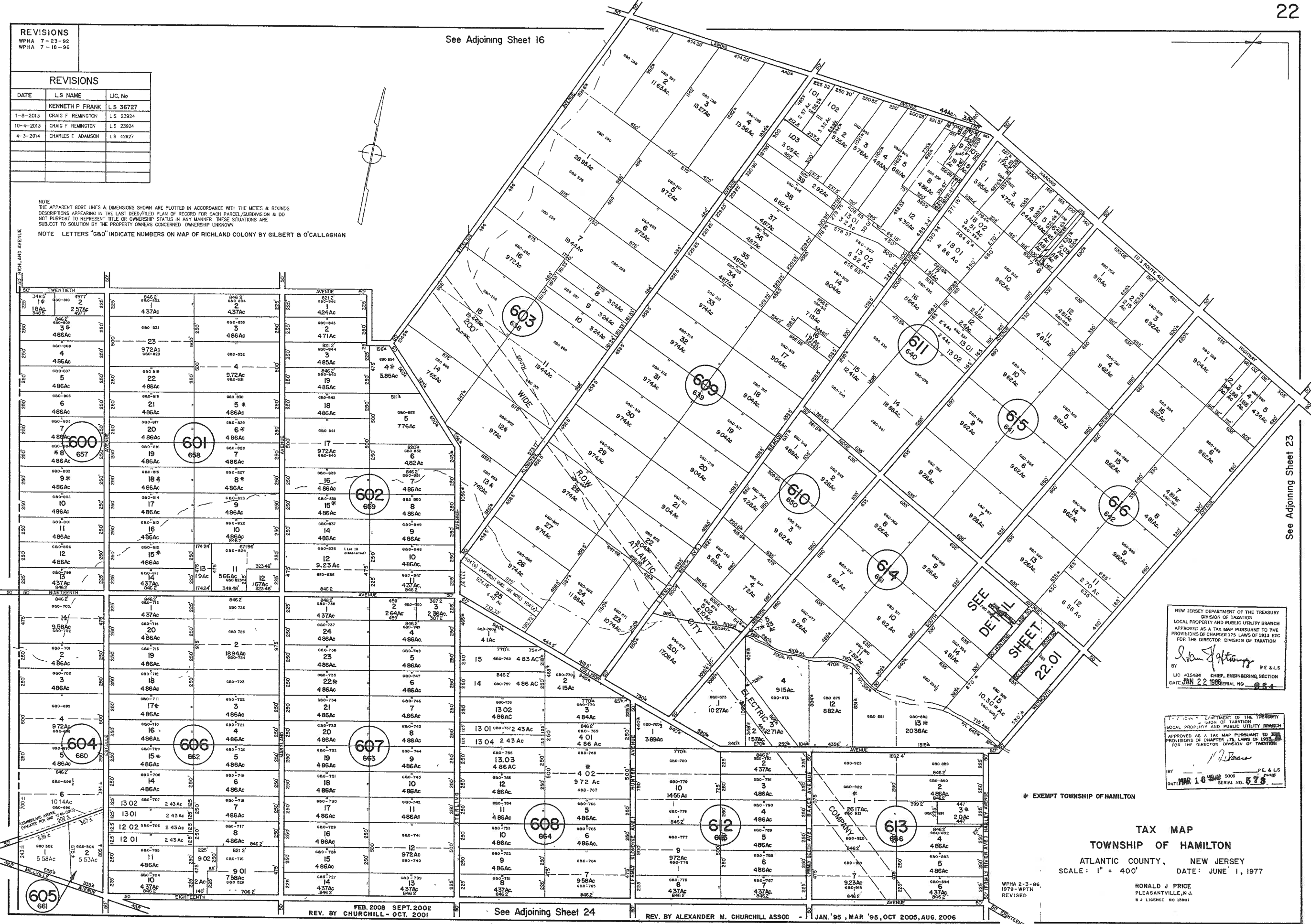

NEW JERSEY DEPARTMENT OF THE TREASURY
DIVISION OF TAXATION
LOCAL PROPERTY AND PUBLIC UTILITY BRANCH
APPROVED AS A TAX MAP PURSUANT TO THE PROVISIONS OF CHAPTER 175, LAWS OF 1955, ETC. FOR THE DIRECTOR, DIVISION OF TAXATION

Alexander M. Churchill P.E. & L.S.
LIC #15438 CHIEF, ENGINEERING SECTION
DATE: JAN 22 1986 SERIAL NO. 854

NEW JERSEY DEPARTMENT OF THE TREASURY
DIVISION OF TAXATION
LOCAL PROPERTY AND PUBLIC UTILITY BRANCH
APPROVED AS A TAX MAP PURSUANT TO THE PROVISIONS OF CHAPTER 175, LAWS OF 1955, ETC. FOR THE DIRECTOR, DIVISION OF TAXATION

Ronald J. Price P.E. & L.S.
LIC #15438 CHIEF, ENGINEERING SECTION
DATE: MAR 16 1986 SERIAL NO. 578

* EXEMPT TOWNSHIP OF HAMILTON

TAX MAP
TOWNSHIP OF HAMILTON
ATLANTIC COUNTY, NEW JERSEY
SCALE: 1" = 400' DATE: JUNE 1, 1977

RONALD J. PRICE
PLEASANTVILLE, N.J.
N.J. LICENSE NO. 13801

FEB. 2008 SEPT. 2002
REV. BY CHURCHILL - OCT. 2001

See Adjoining Sheet 24

REV. BY ALEXANDER M. CHURCHILL ASSOC - JAN. '95, MAR '95, OCT 2005, AUG. 2006

ATLANTIC COUNTY
BUENA VISTA TOWNSHIP

See Adjoining Sheet 23