

REVISIONS			
DATE	BY	LIC. NO.	COMMENTS
6/18/10	JAM	29918	
1/14/16	JAM	29918	
10/24/17	JAM	29918	

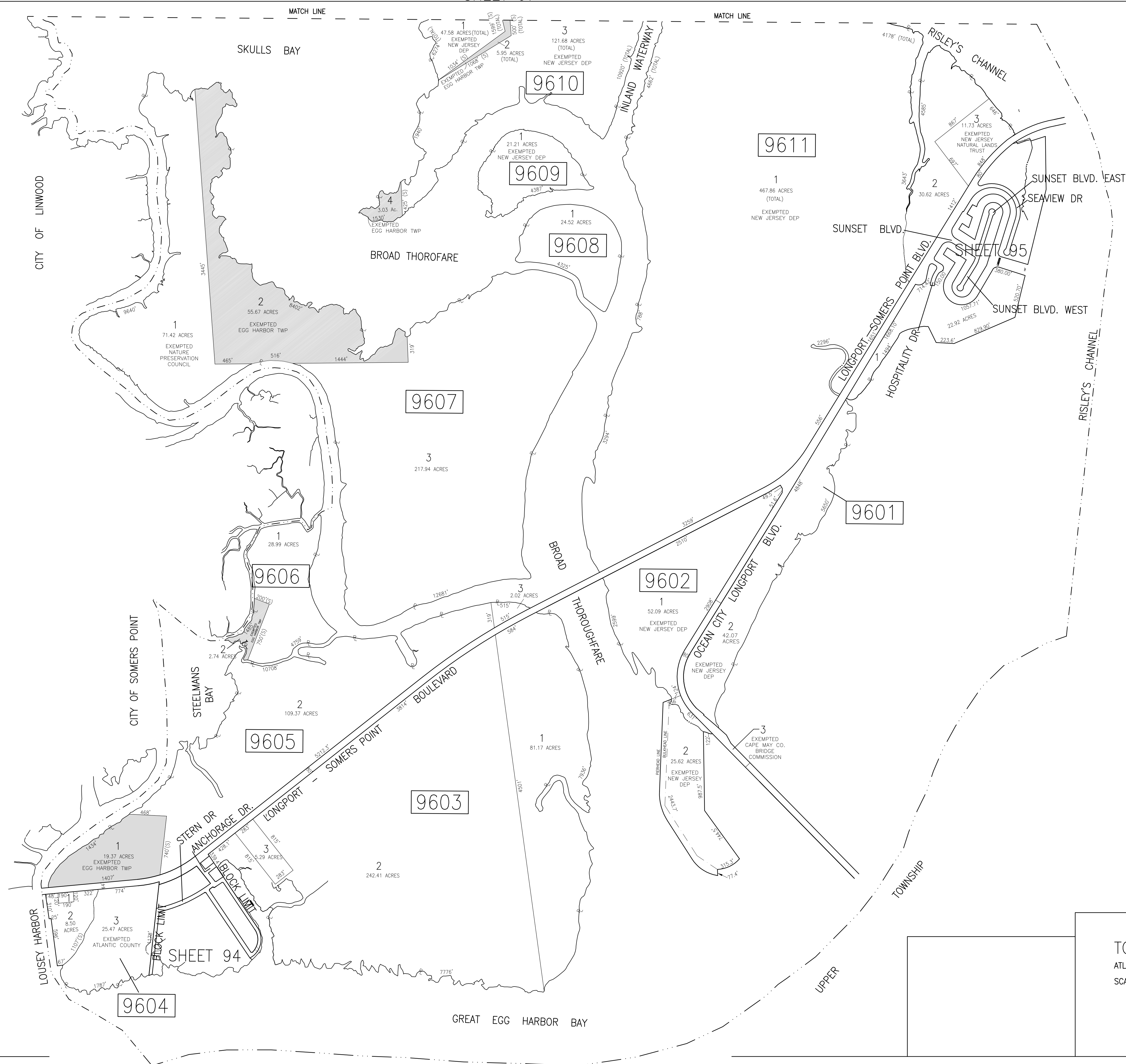
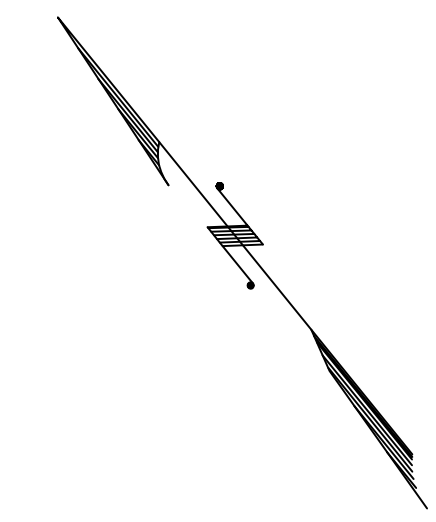

BORO OF LONGPORT

THIS SHEET HAS BEEN DRAWN USING COMPUTER AIDED DRAFTING/DESIGN (CAD/D).

SHADED AREAS INDICATE EGG HARBOR TOWNSHIP EXEMPTED PROPERTY

**TAX MAP**  
**TOWNSHIP OF EGG HARBOR**  
 ATLANTIC COUNTY, NEW JERSEY  
 SCALE: 1"=600' JANUARY 2008  
**JAMES A. MOTT, PE, PLS**  
PROFESSIONAL ENGINEER & LAND SURVEYOR  
 NEW JERSEY LICENSE NO. 29918  
 3122 FIRE ROAD  
 EGG HARBOR TOWNSHIP, NJ 08234