

| REVISIONS |     |          |          |
|-----------|-----|----------|----------|
| DATE      | BY  | LIC. NO. | COMMENTS |
| 6/17/10   | JAM | 29918    |          |
| 3/12/12   | JAM | 29918    |          |
| 12/12/13  | JAM | 29918    |          |
| 10/24/17  | JAM | 29918    |          |
|           |     |          |          |
|           |     |          |          |

SHEET 51

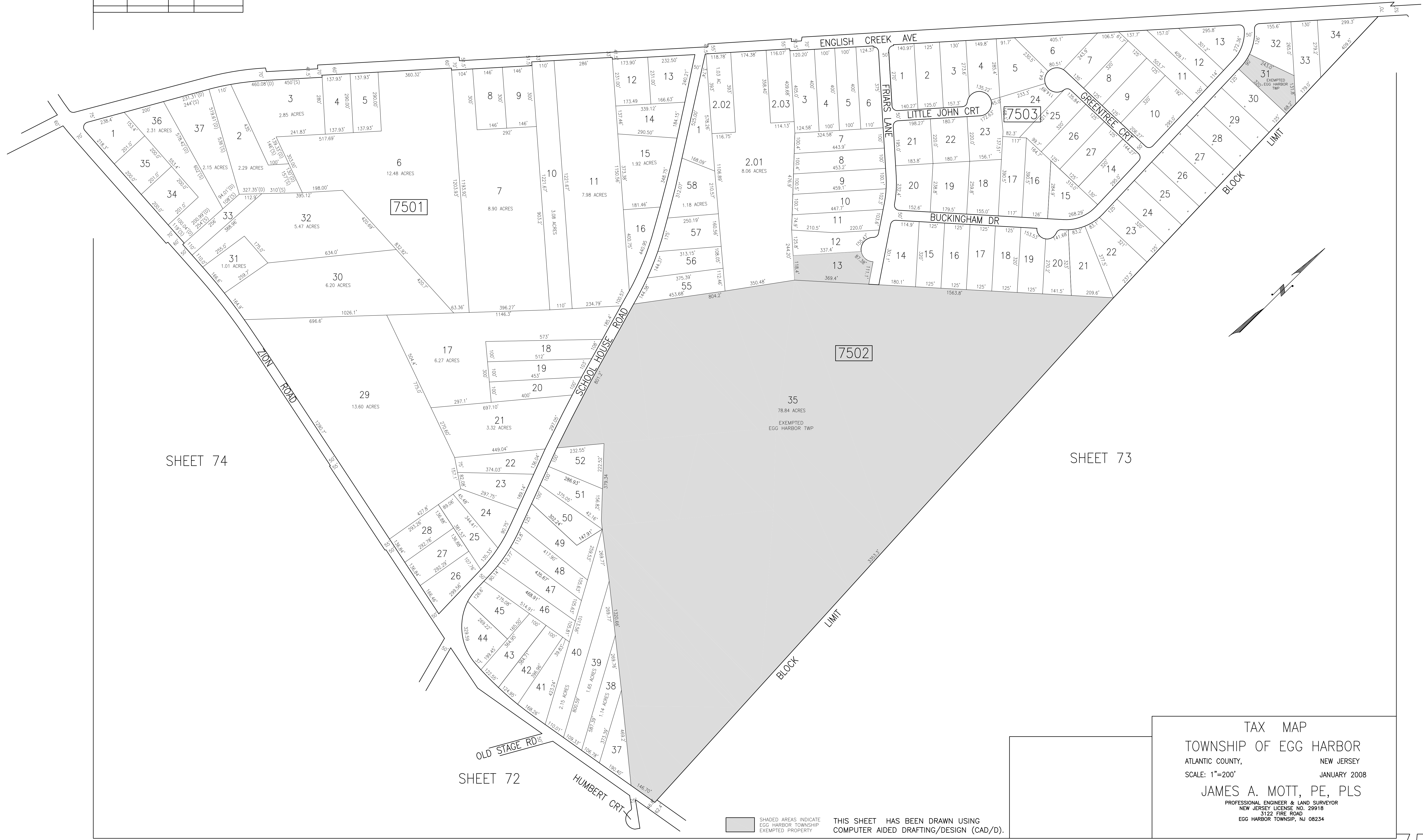

SHEET 74

SHEET 73

SHEET 72

 SHADED AREAS INDICATE  
 EGG HARBOR TOWNSHIP  
 EXEMPTED PROPERTY

THIS SHEET HAS BEEN DRAWN USING  
 COMPUTER AIDED DRAFTING/DESIGN (CAD/D).

TAX MAP  
 TOWNSHIP OF EGG HARBOR  
 ATLANTIC COUNTY, NEW JERSEY  
 SCALE: 1"=200' JANUARY 2008  
 JAMES A. MOTT, PE, PLS  
 PROFESSIONAL ENGINEER & LAND SURVEYOR  
 NEW JERSEY LICENSE NO. 29918  
 3122 FIRE ROAD  
 EGG HARBOR TOWNSHIP, NJ 08234