

REVISIONS				REVISIONS			
DATE	BY	LIC. NO	COMMENTS	DATE	BY	LIC. NO	COMMENTS
1/7/13	JAM	29918		11/7/08	JAM	29918	
11/11/13	JAM	29918		12/23/08	JAM	29918	
12/4/13	JAM	29918		4/20/2009	JAM	29918	
12/16/13	JAM	29918		11/10/09	JAM	29918	
1/19/17	JAM	29918		3/10/10	JAM	29918	
10/24/17	JAM	29918		6/16/10	JAM	29918	
3/2/18	JAM	29918		5/31/11	JAM	29918	
1/17/19	JAM	29918		4/5/12	JAM	29918	

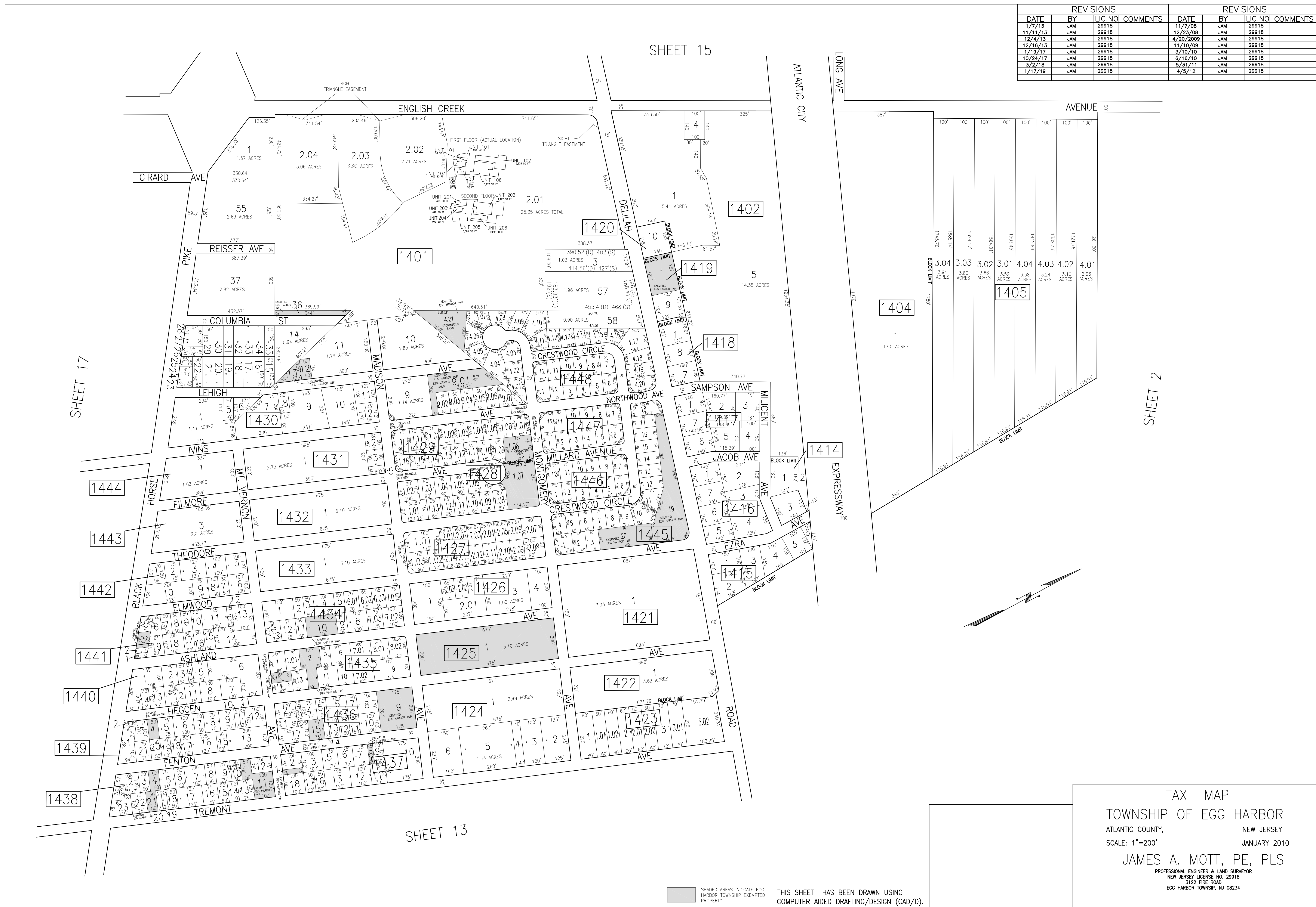

SHEET 17

SHEET 15

SHEET 13

SHEET 2

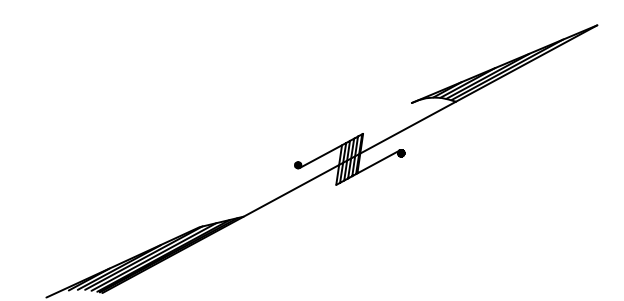

SHADED AREAS INDICATE EGG HARBOR TOWNSHIP EXEMPTED PROPERTY. THIS SHEET HAS BEEN DRAWN USING COMPUTER AIDED DRAFTING/DESIGN (CAD/D).

TAX MAP
 TOWNSHIP OF EGG HARBOR
 ATLANTIC COUNTY, NEW JERSEY
 SCALE: 1"=200' JANUARY 2010
JAMES A. MOTT, PE, PLS
PROFESSIONAL ENGINEER & LAND SURVEYOR
 NEW JERSEY LICENSE NO. 29918
 3122 FIRE ROAD
 EGG HARBOR TOWNSHIP, NJ 08234