

SHEET 41

REVISIONS			
DATE	BY	LIC. NO	COMMENTS
6/10/08	JAM	29918	
3/10/09	JAM	29918	
11/2/09	JAM	29918	
6/21/10	JAM	29918	
3/12/12	JAM	29918	
10/24/17	JAM	29918	

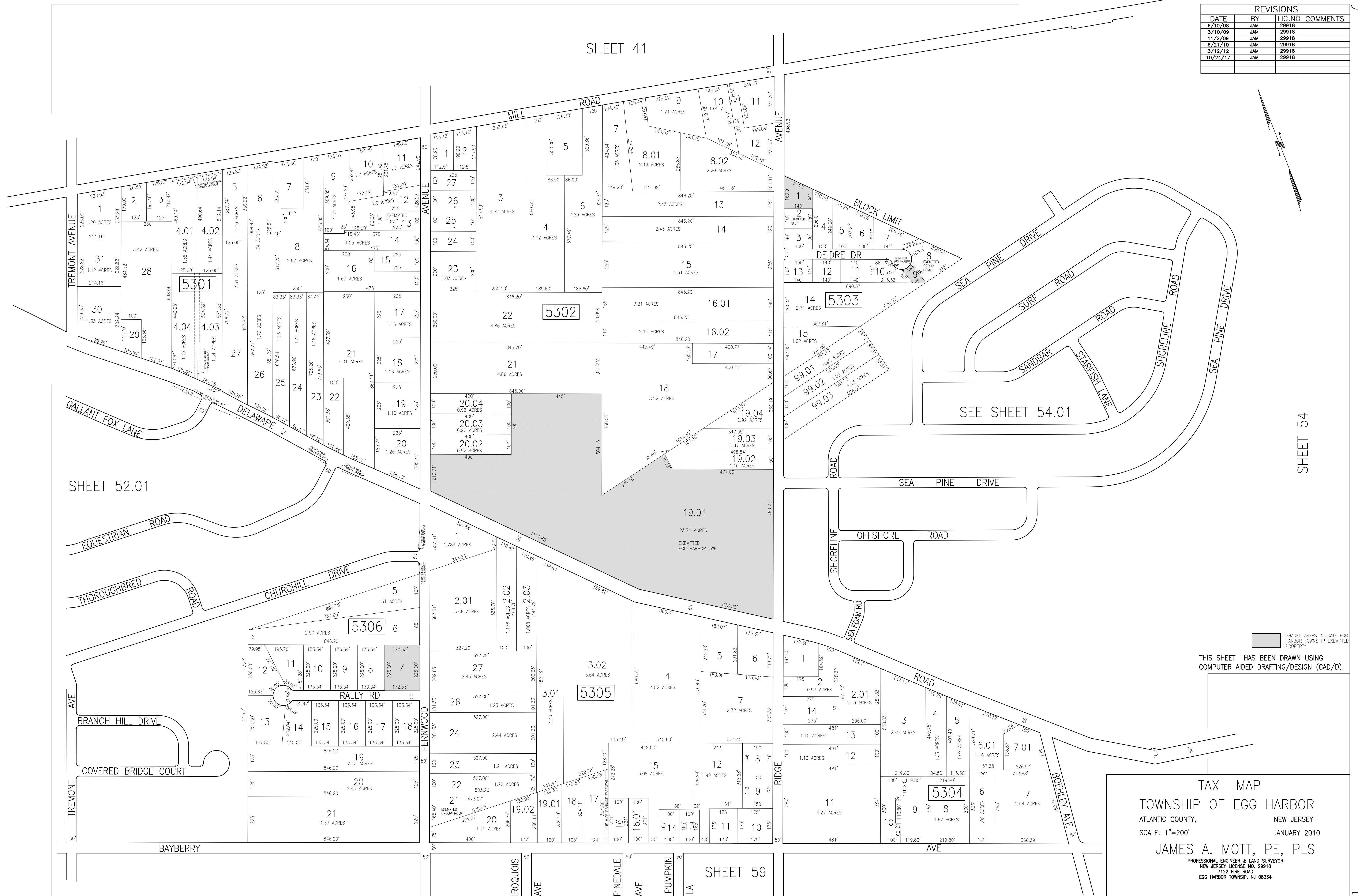
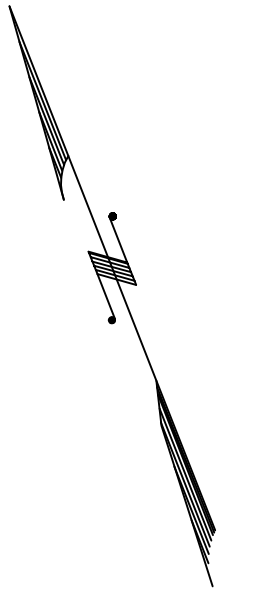

SHEET 54

SHEET 52.01

SHADED AREAS INDICATE EGG HARBOR TOWNSHIP EXEMPTED PROPERTY

THIS SHEET HAS BEEN DRAWN USING COMPUTER AIDED DRAFTING/DESIGN (CAD/D).

TAX MAP  
 TOWNSHIP OF EGG HARBOR  
 ATLANTIC COUNTY, NEW JERSEY  
 SCALE: 1"=200' JANUARY 2010  
 JAMES A. MOTT, PE, PLS  
 PROFESSIONAL ENGINEER & LAND SURVEYOR  
 NEW JERSEY LICENSE NO. 29918  
 3122 FIRE ROAD  
 EGG HARBOR TOWNSHIP, NJ 08234