

REVISIONS			
DATE	BY	LIC. NO.	COMMENTS
6/18/10	JAM	29918	
7/18/10	JAM	29918	
8/28/12	JAM	29918	
1/7/15	JAM	29918	
2/28/17	JAM	29918	
7/27/17	JAM	29918	
10/24/17	JAM	29918	

SHEET 30

SHEET 45

SHEET 46

SHEET 51

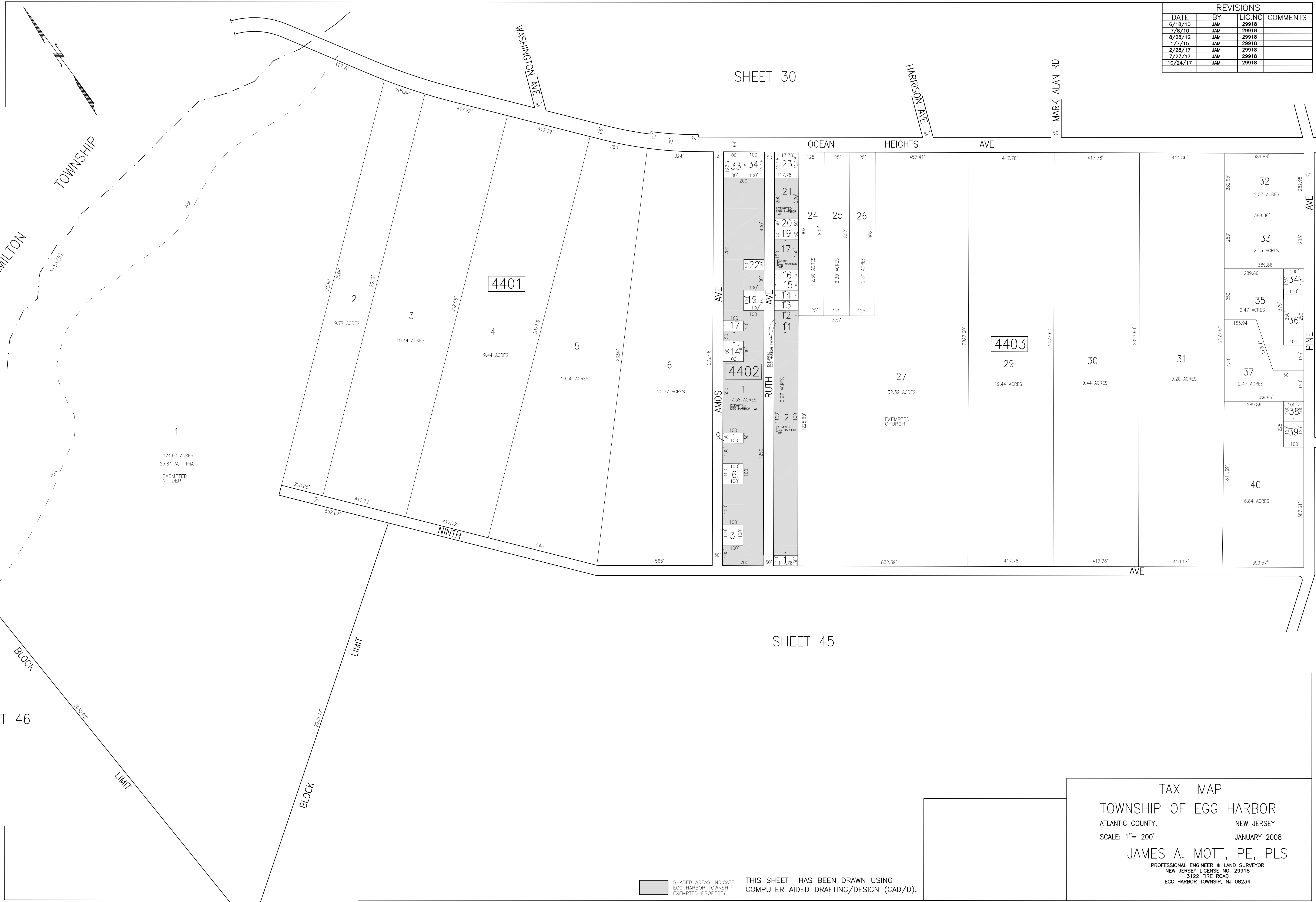

1  
 124.03 ACRES  
 25.84 AC -FHA  
 EXEMPTED  
 NJ DEP

SHADED AREAS INDICATE  
 EGG HARBOR TOWNSHIP  
 EXEMPTED PROPERTY

THIS SHEET HAS BEEN DRAWN USING  
 COMPUTER AIDED DRAFTING/DESIGN (CAD/D).

TAX MAP  
 TOWNSHIP OF EGG HARBOR  
 ATLANTIC COUNTY, NEW JERSEY  
 SCALE: 1"= 200' JANUARY 2008  
 JAMES A. MOTT, PE, PLS  
 PROFESSIONAL ENGINEER & LAND SURVEYOR  
 NEW JERSEY LICENSE NO. 29918  
 3122 FIRE ROAD  
 EGG HARBOR TOWNSHIP, NJ 08234