

REVISIONS			
DATE	BY	LIC. NO.	COMMENTS
6/16/10	JAM	29918	
1/2/15	JAM	29918	
7/27/16	JAM	29918	
2/28/17	JAM	29918	
10/22/18	JAM	29918	

SHEET 36

SHEET 24

LIBERTY AVE

SECOND AVE

THIRD AVE

FOURTH AVE

FIFTH AVE

1112

UNNAMED ALLEY

MYRTLE AVE

SHEET 20

SHEET 37

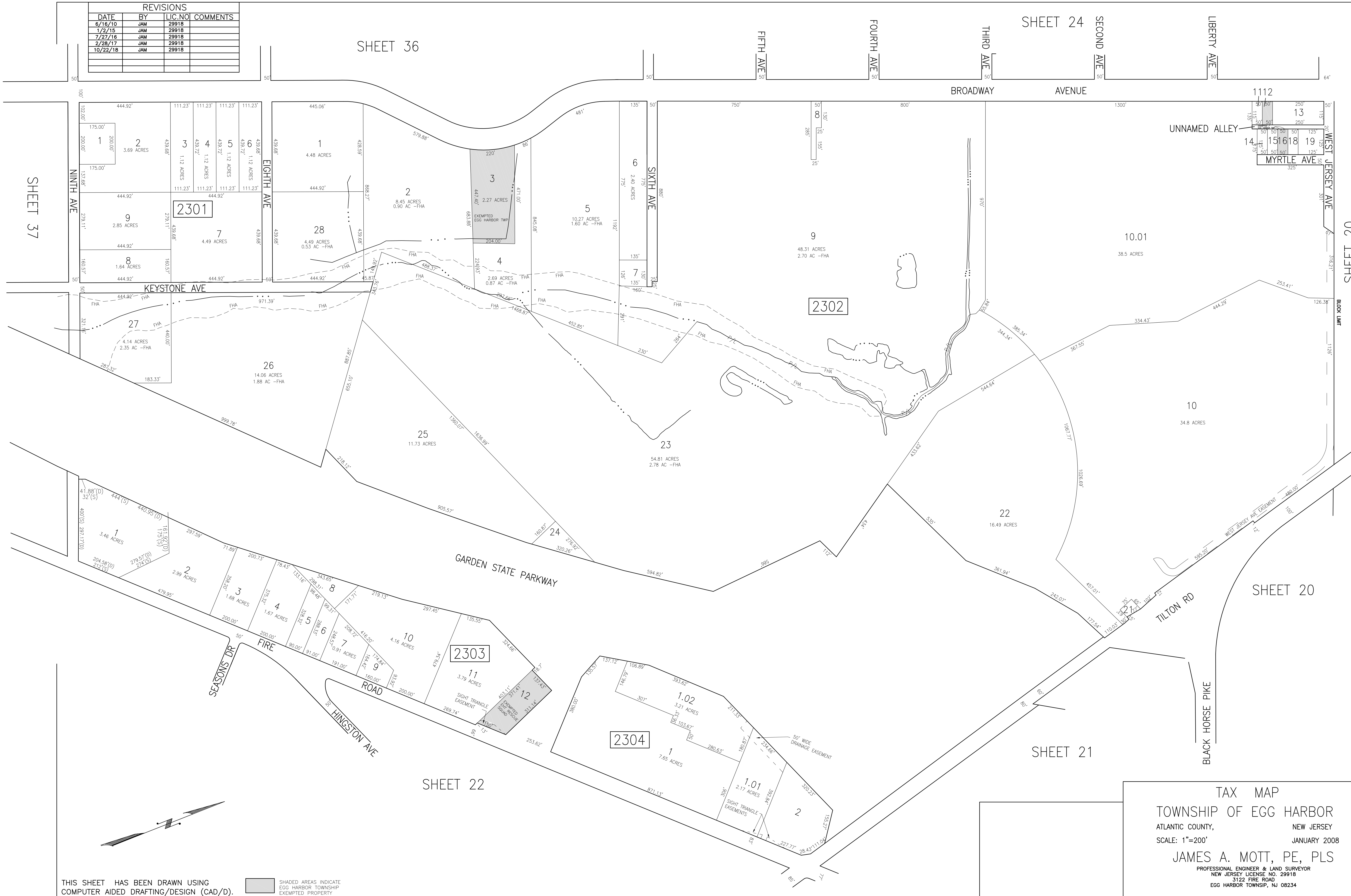

TAX MAP
 TOWNSHIP OF EGG HARBOR
 ATLANTIC COUNTY, NEW JERSEY
 SCALE: 1"=200' JANUARY 2008
 JAMES A. MOTT, PE, PLS
 PROFESSIONAL ENGINEER & LAND SURVEYOR
 NEW JERSEY LICENSE NO. 29918
 3122 FIRE ROAD
 EGG HARBOR TOWNSHIP, NJ 08234

THIS SHEET HAS BEEN DRAWN USING
 COMPUTER AIDED DRAFTING/DESIGN (CAD/D).
 SHADED AREAS INDICATE
 EGG HARBOR TOWNSHIP
 EXEMPTED PROPERTY