

TAX MAP
 TOWNSHIP OF EGG HARBOR
 ATLANTIC COUNTY, NEW JERSEY
 SCALE: 1"=200'
 JANUARY 2008
 JAMES A. MOTT, PE, PLS
 PROFESSIONAL ENGINEER & LAND SURVEYOR
 NEW JERSEY LICENSE NO. 29918
 3122 FIRE ROAD
 EGG HARBOR TOWNSHIP, NJ 08234

THIS SHEET HAS BEEN DRAWN USING
 COMPUTER AIDED DRAFTING/DESIGN (CAD/D).

SHADED AREAS INDICATE
 EGG HARBOR TOWNSHIP
 EXEMPTED PROPERTY

REVISIONS			
DATE	BY	LIC. NO.	COMMENTS
2/18/08	JAM	29918	
11/7/08	JAM	29918	
6/15/10	JAM	29918	
3/12/12	JAM	29918	
6/12/13	JAM	29918	
6/11/18	JAM	29918	

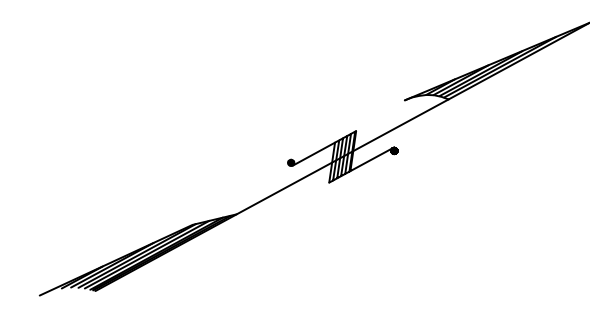

SHEET 28

SHEET 27

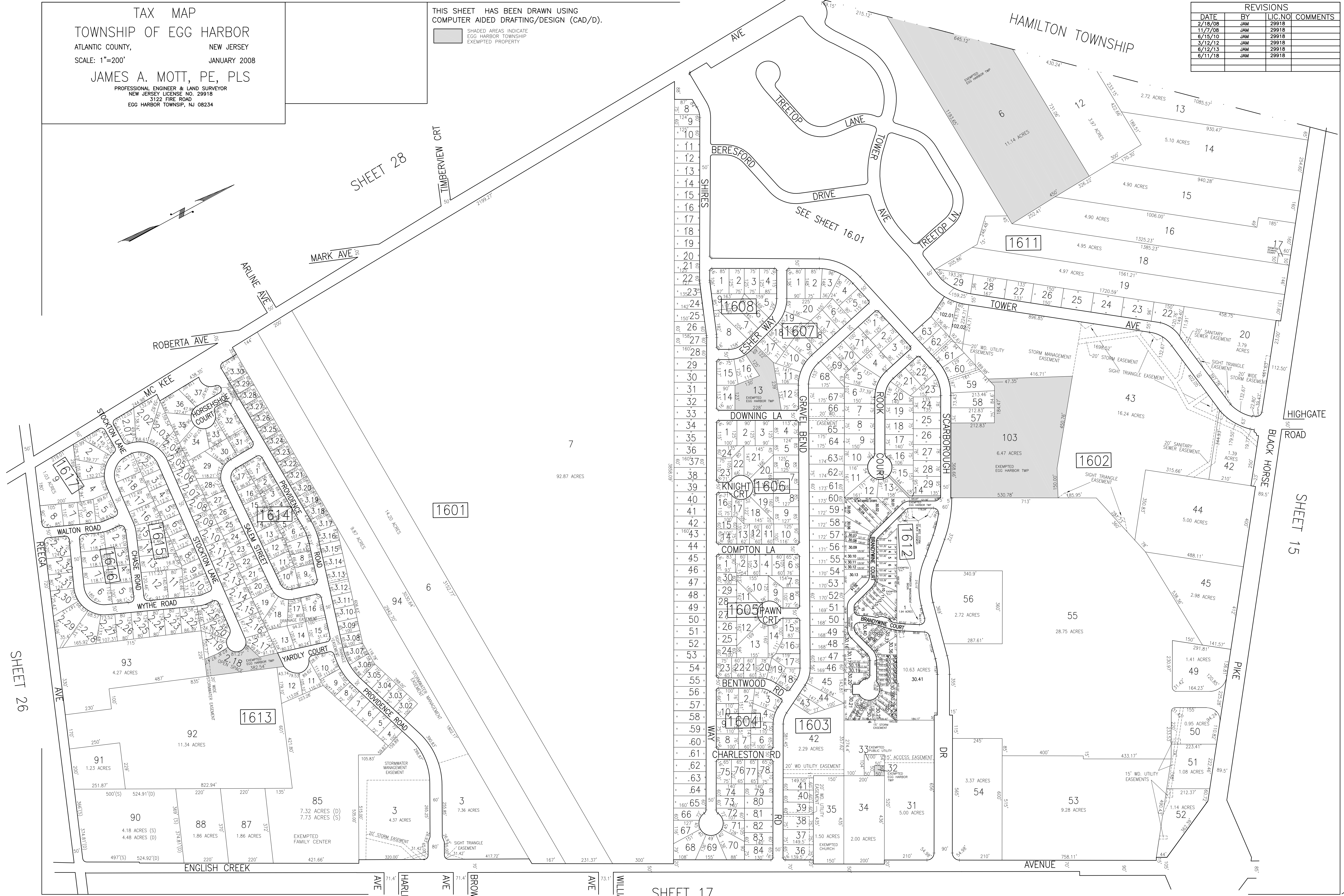

SHEET 26

SHEET 15

SHEET 17