

REVISIONS				REVISIONS				REVISIONS			
DATE	BY	LIC. NO.	COMMENTS	DATE	BY	LIC. NO.	COMMENTS	DATE	BY	LIC. NO.	COMMENTS
6/10/08	JAM	29918		1/7/12	JAM	29918		2/23/18	JAM	29918	
11/7/08	JAM	29918		11/12/13	JAM	29918		7/12/18	JAM	29918	
9/16/09	JAM	29918		12/16/13	JAM	29918		9/25/18	JAM	29918	
6/16/10	JAM	29918		1/2/15	JAM	29918					
1/13/11	JAM	29918		1/28/16	JAM	29918					
6/2/11	JAM	29918		7/26/17	JAM	29918					

SHEET 7

SHEET 8

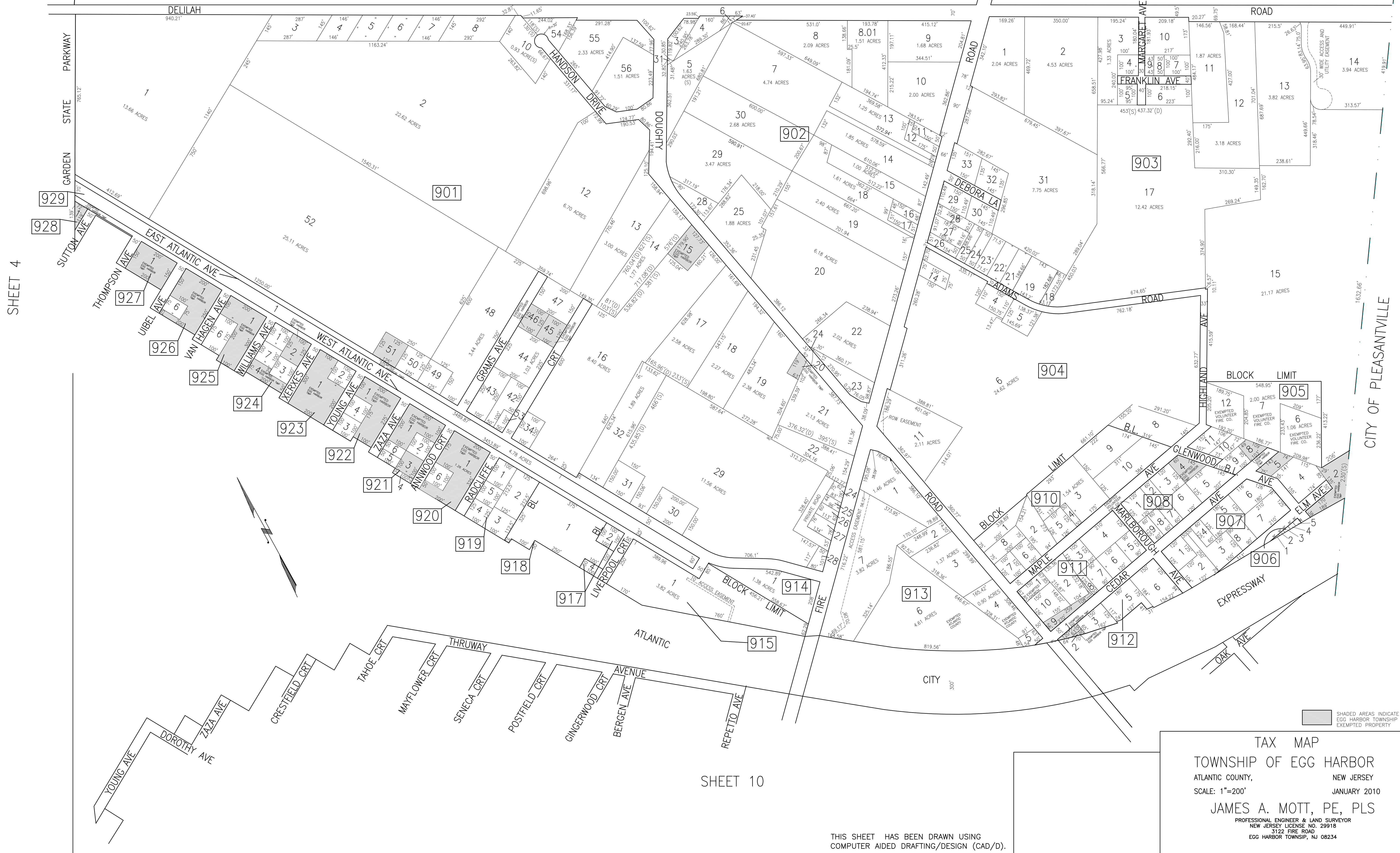

SHEET 4

CITY OF PLEASANTVILLE

SHEET 10

SHADED AREAS INDICATE  
EGG HARBOR TOWNSHIP  
EXEMPTED PROPERTY

TAX MAP  
TOWNSHIP OF EGG HARBOR  
ATLANTIC COUNTY, NEW JERSEY  
SCALE: 1"=200'  
JANUARY 2010  
JAMES A. MOTT, PE, PLS  
PROFESSIONAL ENGINEER & LAND SURVEYOR  
NEW JERSEY LICENSE NO. 29918  
3122 FIRE ROAD  
EGG HARBOR TOWNSHIP, NJ 08234

THIS SHEET HAS BEEN DRAWN USING  
COMPUTER AIDED DRAFTING/DESIGN (CAD/D).