

REVISIONS			
DATE	BY	LIC. NO.	COMMENTS
6/22/10	JAM	29918	
11/26/13	JAM	29918	

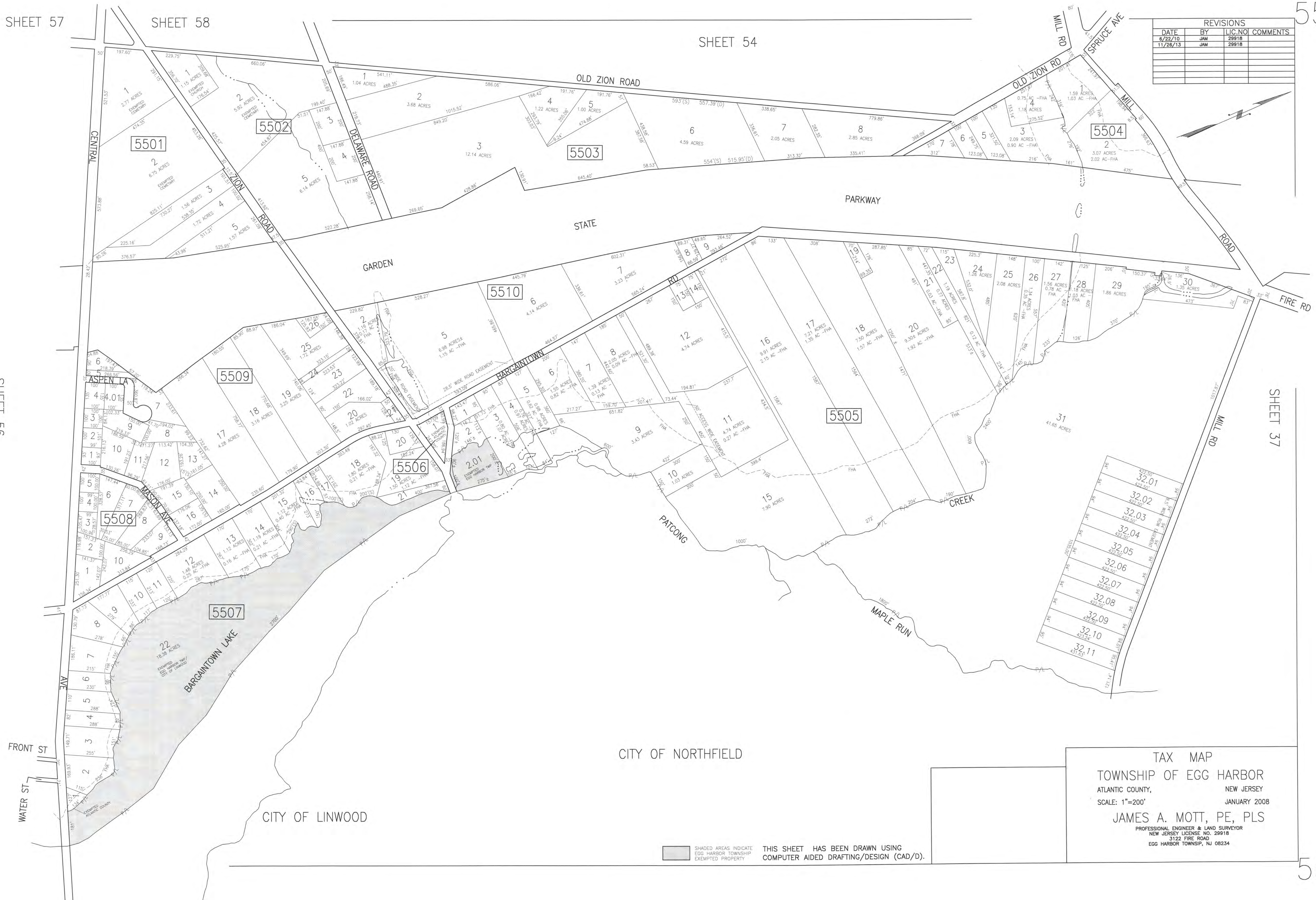
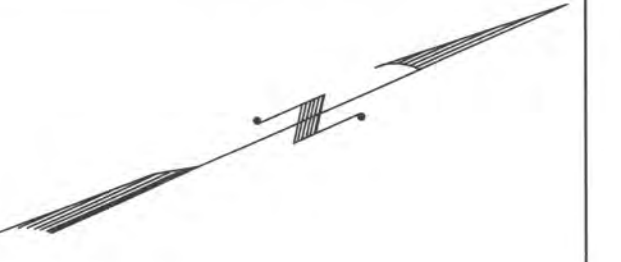

SHEET 56

SHEET 37

CITY OF NORTHFIELD

CITY OF LINWOOD

**TAX MAP**  
**TOWNSHIP OF EGG HARBOR**  
 ATLANTIC COUNTY, NEW JERSEY  
 SCALE: 1"=200' JANUARY 2008  
**JAMES A. MOTT, PE, PLS**  
 PROFESSIONAL ENGINEER & LAND SURVEYOR  
 NEW JERSEY LICENSE NO. 29918  
 3122 FIRE ROAD  
 EGG HARBOR TOWNSHIP, NJ 08234

SHADED AREAS INDICATE EGG HARBOR TOWNSHIP EXEMPTED PROPERTY  
 THIS SHEET HAS BEEN DRAWN USING COMPUTER AIDED DRAFTING/DESIGN (CAD/D).