

REVISIONS			
DATE	BY	LIC. NO.	COMMENTS
1/28/08	JAM	29918	
6/10/08	JAM	29918	
11/13/08	JAM	29918	
2/9/10	JAM	29918	
6/15/10	JAM	29918	
2/4/11	JAM	29918	
11/21/13	JAM	29918	
12/16/13	JAM	29918	

REVISIONS			
DATE	BY	LIC. NO.	COMMENTS
7/29/14	JAM	29918	
8/21/14	JAM	29918	
12/3/15	JAM	29918	
10/13/16	JAM	29918	
1/19/17	JAM	29918	

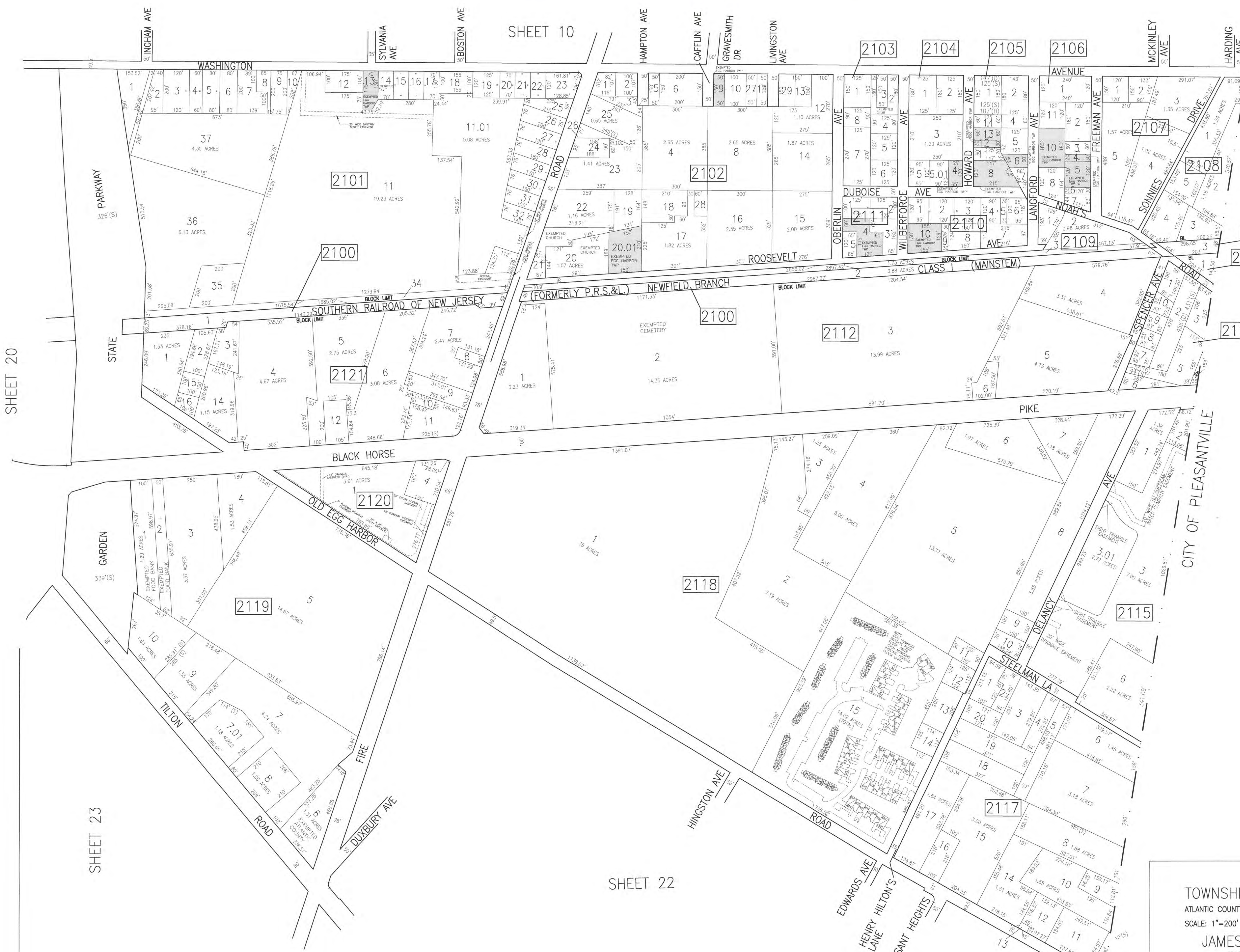
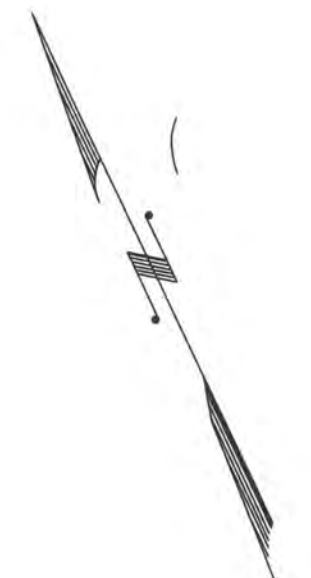

TAX MAP  
 TOWNSHIP OF EGG HARBOR  
 ATLANTIC COUNTY, NEW JERSEY  
 SCALE: 1"=200' JANUARY 2008  
 JAMES A. MOTT, PE, PLS  
 PROFESSIONAL ENGINEER & LAND SURVEYOR  
 NEW JERSEY LICENSE NO. 29918  
 3122 FIRE ROAD  
 EGG HARBOR TOWNSHIP, NJ 08234

THIS SHEET HAS BEEN DRAWN USING COMPUTER AIDED DRAFTING/DESIGN (CAD/D). SHaded AREAS INDICATE EGG HARBOR TOWNSHIP EXEMPTED PROPERTY