

TAX MAP  
 TOWNSHIP OF EGG HARBOR  
 ATLANTIC COUNTY, NEW JERSEY  
 SCALE: 1"=200'  
 JANUARY 2008  
 JAMES A. MOTT, PE, PLS  
 PROFESSIONAL ENGINEER & LAND SURVEYOR  
 NEW JERSEY LICENSE NO. 29918  
 3122 FIRE ROAD  
 EGG HARBOR TOWNSHIP, NJ 08234

THIS SHEET HAS BEEN DRAWN USING  
 COMPUTER AIDED DRAFTING/DESIGN (CAD/D).

SHADED AREAS INDICATE  
 EXEMPTED EGG HARBOR TOWNSHIP  
 PROPERTY

REVISIONS			
DATE	BY	LIC. NO.	COMMENTS
2/18/08	JAM	29918	
11/7/08	JAM	29918	
6/15/10	JAM	29918	
3/12/12	JAM	29918	
6/12/13	JAM	29918	

SHEET 27

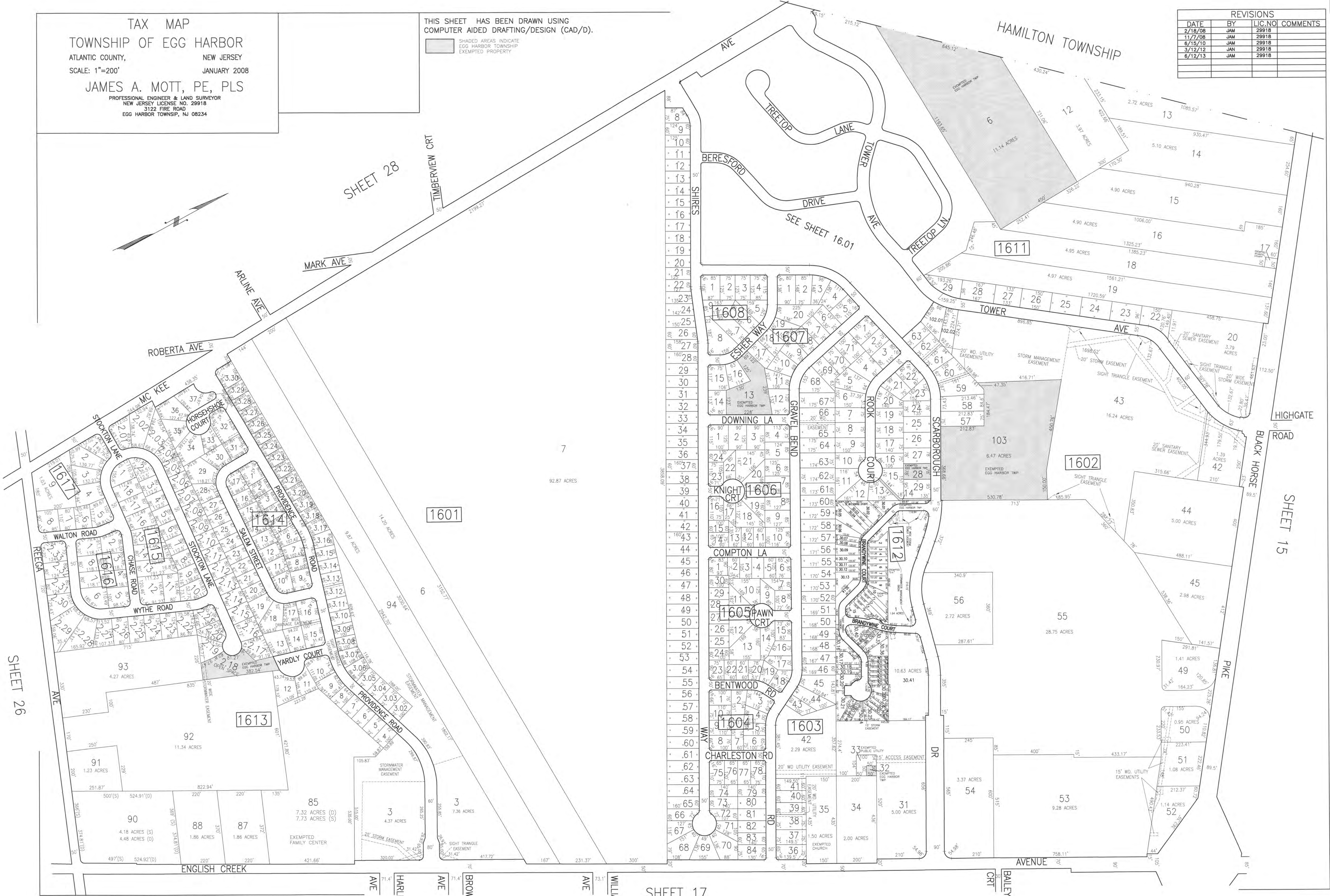

SHEET 28

SHEET 15

SHEET 17