

REVISIONS			
DATE	BY	LIC. NO.	COMMENTS
7/12/10	JAM	29918	
1/15/16	JAM	29918	
7/26/17	JAM	29918	
9/18/17	JAM	29918	
2/18/19	JAM	29918	

### LEGEND

COUNTY LINE	
MUNICIPAL BOUNDARY LINE	
ARTIFICIAL BLOCK LIMIT	
FORMER PROPERTY LINE	
STREAM & WATER LINES	
STREAM & WATER LINES (IF PROPERTY LINE)	
SHEET LIMIT LINE (ON KEY MAP)	
PIERHEAD LINE	
BULKHEAD LINE	
FLOOD HAZARD LINE	
BOUNDARIES OF SPECIAL TAXING DIST	
EASEMENT LINE	

BLOCK NUMBER (ON KEY MAP)	
BLOCK NUMBER	
TAX MAP SHEET NUMBER	
LOT NUMBER	16
SCALED DISTANCE/ACREAGE	200'(S)
DEED DISTANCE/ACREAGE	200'(D)
CALCULATED DISTANCE	200'

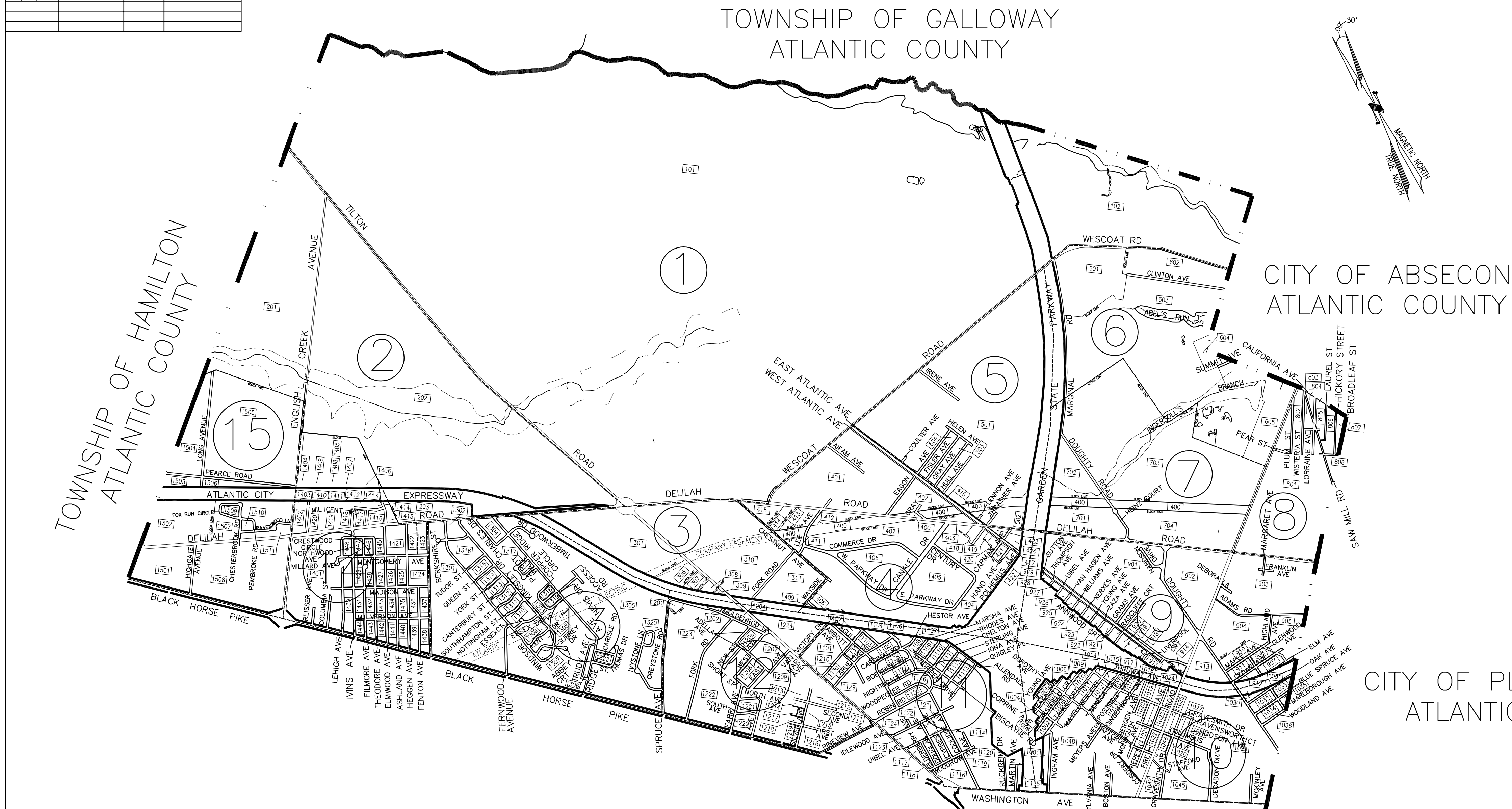

CITY OF PLEASANTVILLE  
ATLANTIC COUNTY

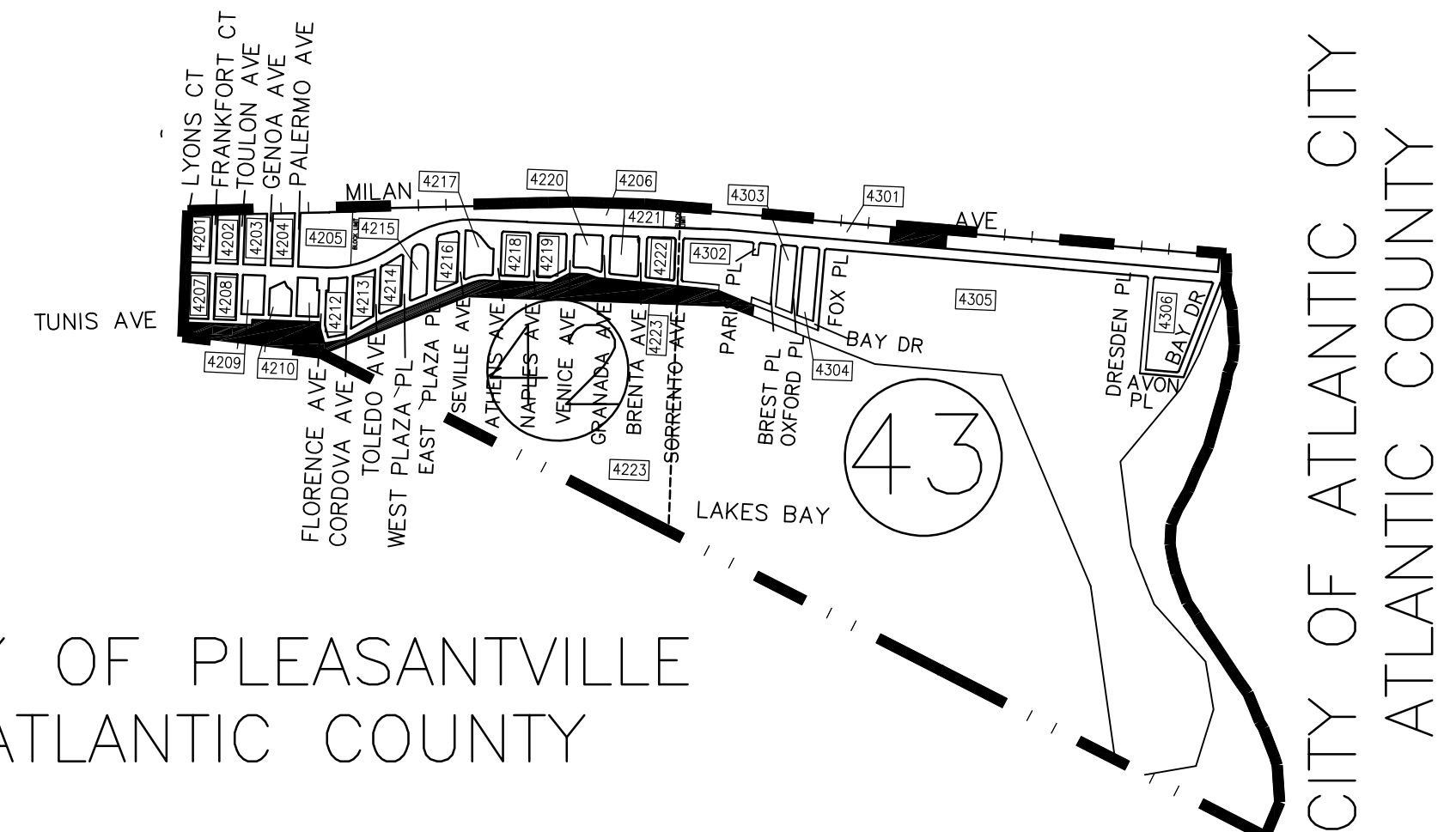

KEY MAP II

THE ORIGINAL MAP WAS MADE AND SIGNED BY CHRIS R. REHMANN, LOCENSE NUMBER 17119. IT WAS CERTIFIED BY IVAN HAFTKOWYCZ AND ASSIGNED SERIAL NUMBER 763 AND WAS DATED 8/12/1994.

I HEREBY CERTIFY THAT THIS MAP HAS BEEN REVISED UNDER MY IMMEDIATE SUPERVISION, AND COMPLIES WITH THE LAWS OF THE STATE OF NEW JERSEY.

JAMES A. MOTT, P.E. & L.S. No. 29918

THE AREAS, BOUNDARIES, AND DIMENSIONS SHOWN ON THIS MAP ARE DERIVED FROM GROUND SURVEYS, AERIAL SURVEYS AND RECORDED PLANS, MAPS, DEEDS, AND WILLS AND ARE TO BE USED FOR TAX ASSESSMENT PURPOSES ONLY.

THIS SHEET HAS BEEN DRAWN USING COMPUTER AIDED DRAFTING/DESIGN (CAD/D).

TAX MAP  
TOWNSHIP OF EGG HARBOR  
ATLANTIC COUNTY, NEW JERSEY  
SCALE: 1"=1500' JANUARY 2008  
JAMES A. MOTT, PE, PLS  
PROFESSIONAL ENGINEER & LAND SURVEYOR  
NEW JERSEY LICENSE NO. 29918  
3122 FIRE ROAD  
EGG HARBOR TOWNSHIP, NJ 08234  
TO SHOW CONDITIONS AS OF JULY 12, 2010