

KEY MAP

REVISIONS		
DATE	NAME	NO.
12-9-2019	CHARLES E. ADAMSON	42627

NOTES:

1. THE AREAS, BOUNDARIES AND DIMENSIONS, SHOWN ON THIS TAX MAP, ARE DERIVED FROM GROUND SURVEYS, AERIAL SURVEYS, AND RECORDED PLANS, MAPS, DEEDS AND WILLS, ARE TO BE USED FOR ASSESSMENT PURPOSES ONLY.*
2. THIS TAX MAP SUPERSEDES THE TAX MAP APPROVED DATE: APRIL, 24 1973
3. THESE MAPS HAVE BEEN DRAWN USING COMPUTER AIDED DRAFTING/DESIGN (CAD/D) AND COORDINATE GEOMETRY (COGO).

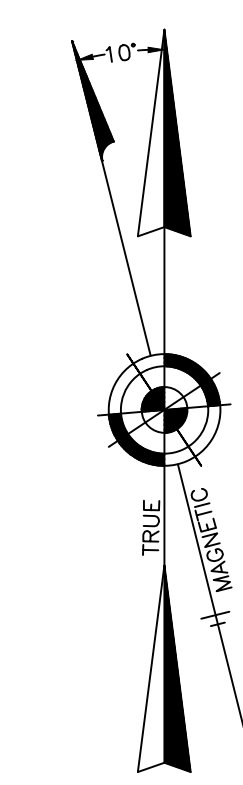

LEGEND

KEY MAP

- 10** PLATE NUMBER
- 101 BLOCK NUMBER
- ARTIFICIAL-BLOCK-LIMIT-LINE
- RIGHT-OF-WAY LINE
- PLATE DELINEATION LINE
- MUNICIPAL BOUNDARY LINE
- COUNTY BOUNDARY LINE
- WATERWAY LINES
- W.L.A. WETLAND AREA - W.L.A.

DETAIL SHEET

- 81.05** BLOCK NUMBERS
- 5 LOT NUMBERS
- 33 ADDRESS NUMBERS
- BLOCK LIMIT
- ARTIFICIAL-BLOCK-LIMIT-LINE
- LOT LINE
- RIGHT-OF-WAY LINE
- EASEMENT LINE
- MUNICIPAL BOUNDARY LINE
- COUNTY BOUNDARY LINE
- WATERWAY LINES
- W.L.A. WETLAND AREA - W.L.A.

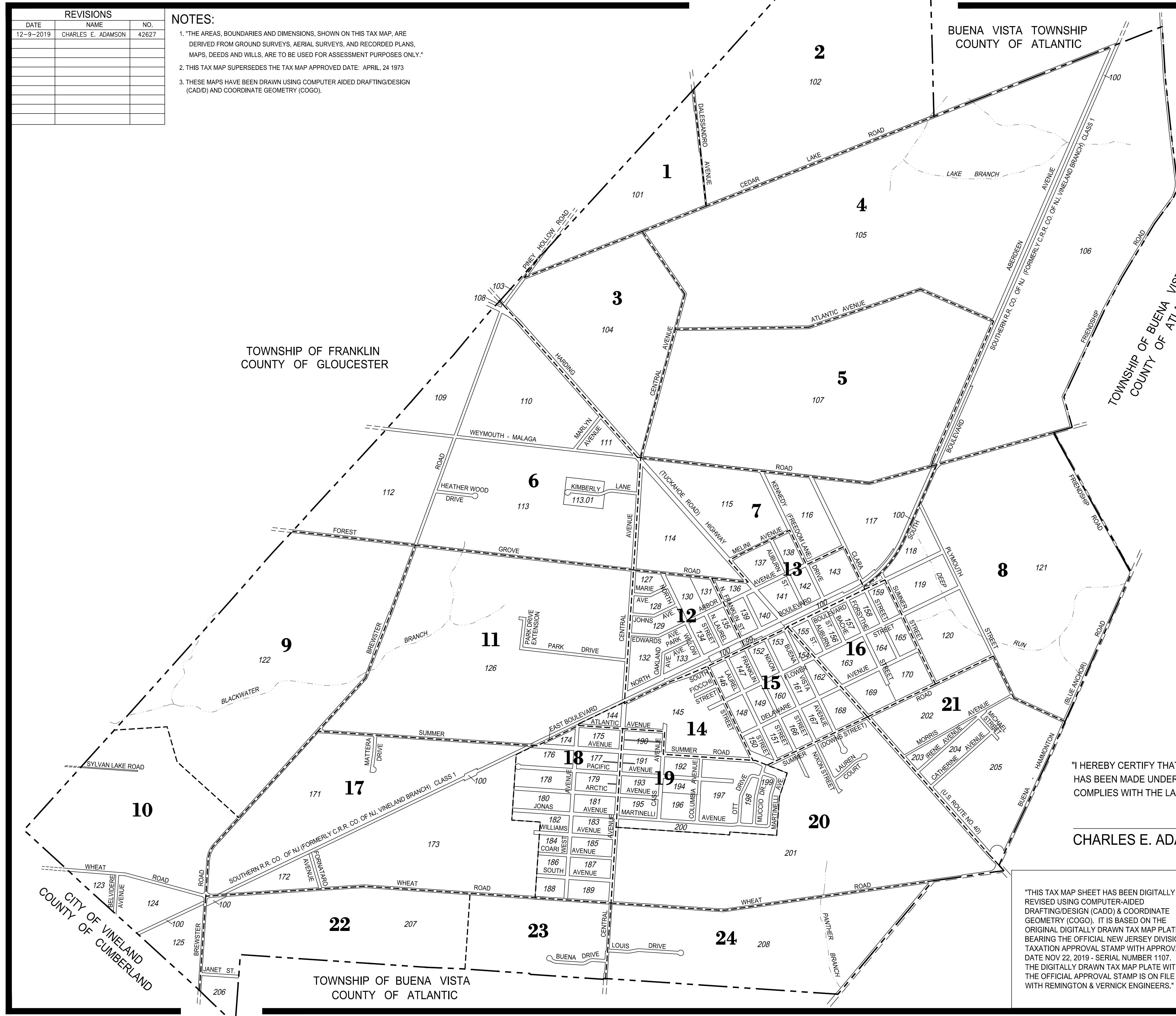

"I HEREBY CERTIFY THAT THIS MAP AND ANY REQUIRED SURVEY HAS BEEN MADE UNDER MY IMMEDIATE SUPERVISION, AND COMPLIES WITH THE LAWS OF THE STATE OF NEW JERSEY."

CHARLES E. ADAMSON NJ PROFESSIONAL LAND SURVEYOR LIC. NO. 42627

"THIS TAX MAP SHEET HAS BEEN DIGITALLY REVISED USING COMPUTER-AIDED DRAFTING/DESIGN (CADD) & COORDINATE GEOMETRY (COGO). IT IS BASED ON THE ORIGINAL DIGITALLY DRAWN TAX MAP PLATE BEARING THE OFFICIAL NEW JERSEY DIVISION TAXATION APPROVAL STAMP WITH APPROVAL DATE NOV 22, 2019 - SERIAL NUMBER 1107. THE DIGITALLY DRAWN TAX MAP PLATE WITH THE OFFICIAL APPROVAL STAMP IS ON FILE WITH REMINGTON & VERNICK ENGINEERS."

TAX MAP
BOROUGH OF BUENA
 ATLANTIC COUNTY NEW JERSEY
 SCALE: 1" = 800' DATE: 3-12-2019
 CHARLES E. ADAMSON N.J.P.L.S. LIC. NO. 42627
REMINGTON & VERNICK ENGINEERS
 845 N. MAIN STREET, PLEASANTVILLE, N.J. 08232
 (609) 645-7110, FAX (609) 645-7076, WEB SITE ADDRESS: WWW.RVE.COM
 Certificate of Authorization: 24 GA 28003300
 -ENGINEERING EXCELLENCE-
 TO SHOW CONDITIONS AS OF 1-19-2022

KEY MAP