

BONITA

TIDEWAY

BONITA COVE

BEACH AVENUE

FOURTEENTH STREET

FIFTHTEENTH STREET SOUTH

BOULEVARD

SIXTEENTH STREET

SEVENTEENTH STREET

SEVENTEENTH STREET SOUTH

EIGHTEENTH STREET SOUTH

NINETEENTH STREET SOUTH

BAY SHORE

REVERE

SHEET 22

SHEET 18

SHEET 18

SHEET 17

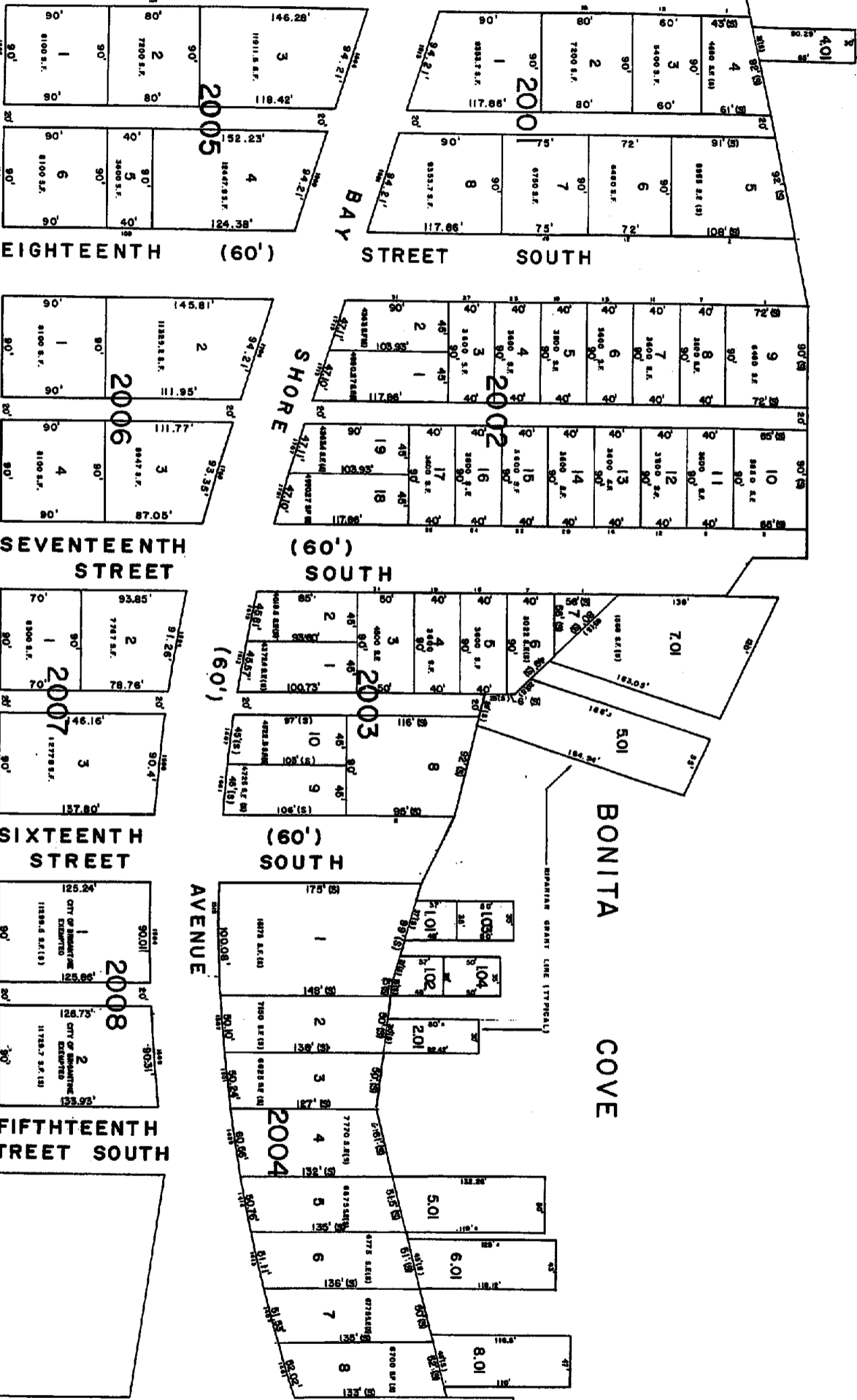

THE STATE DEPARTMENT OF THE TREASURY  
 LOCAL PROPERTY AND FINANCIAL SERVICES DIVISION  
 APPROVED AS A TAX MAP PURSUANT TO THE  
 PROVISIONS OF P.L. 1986-10, CHAPTER 116, AND  
 FOR THE DISTRICT OF PLEASANTVILLE, N.J.  
 WILLIAM C. KISSANE, PLANNING SECTION  
 DATE: FEB 21, 1988, SCALE: 1" = 50'

REV. SEPT. 23, 1986  
**TAX MAP**  
 CITY OF BRIGANTINE  
 ATLANTIC COUNTY, NEW JERSEY  
 SCALE: 1" = 50'  
 WILLIAM C. KISSANE, PLANNING SECTION  
 N.J. L.S. NO. 17427  
 113 SO. CHESTNUT ST. PLEASANTVILLE, N.J.  
 N.J. L.S. NO. 8823

364

20