

REVISIONS				
DATE	BY	LIC. NO.	BLOCK	LOT
09/2013	CHARLES A. ATKINSON-ARH	33994	840	1.01
09/2013	CHARLES A. ATKINSON-ARH	33994	840	1.02

SHEET 130

SHEET 132

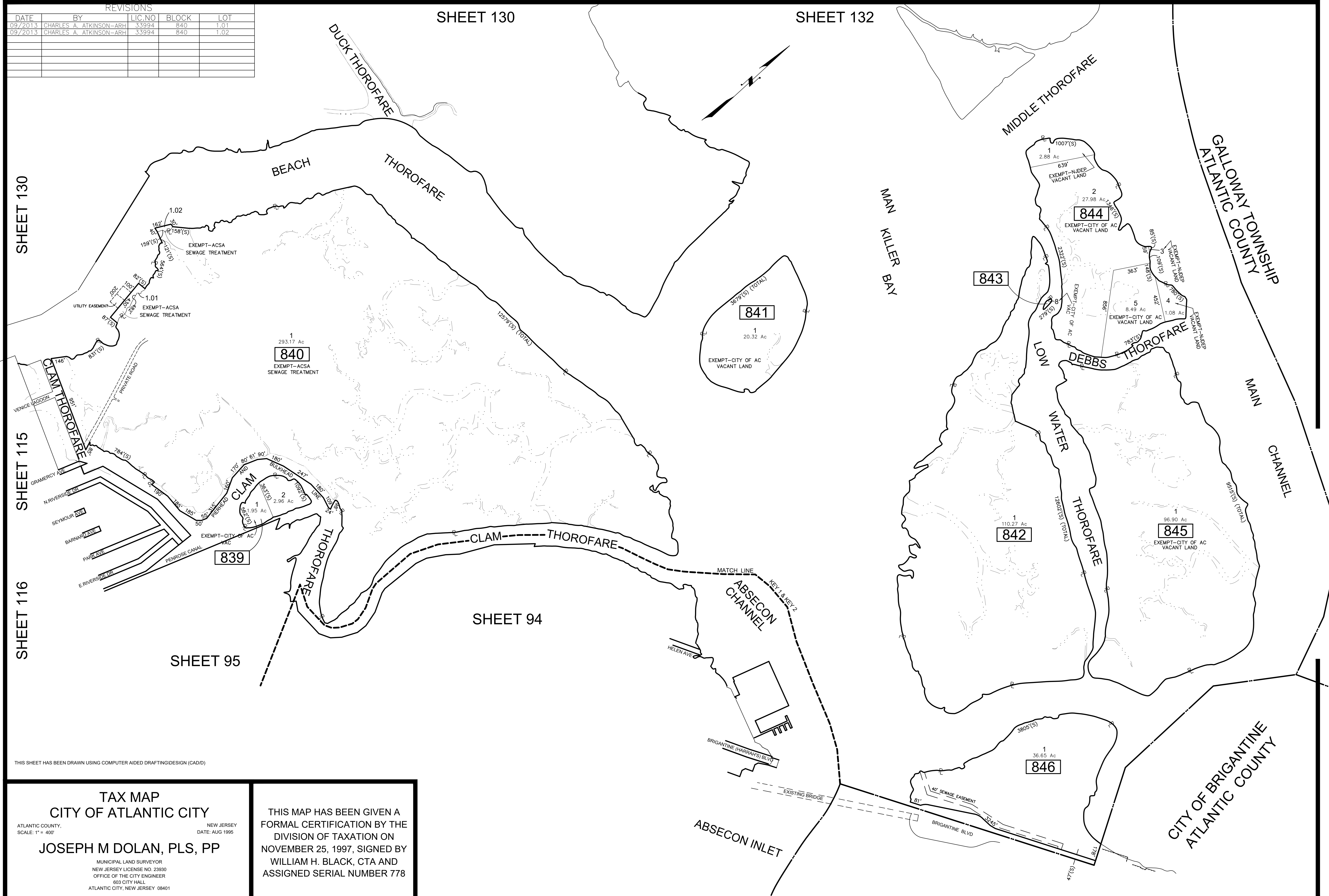

THIS SHEET HAS BEEN DRAWN USING COMPUTER AIDED DRAFTING/DESIGN (CAD/D)

TAX MAP
CITY OF ATLANTIC CITY
 ATLANTIC COUNTY, NEW JERSEY
 SCALE: 1" = 400'
JOSEPH M DOLAN, PLS, PP
 MUNICIPAL LAND SURVEYOR
 NEW JERSEY LICENSE NO. 23930
 OFFICE OF THE CITY ENGINEER
 603 CITY HALL
 ATLANTIC CITY, NEW JERSEY 08401

THIS MAP HAS BEEN GIVEN A FORMAL CERTIFICATION BY THE DIVISION OF TAXATION ON NOVEMBER 25, 1997, SIGNED BY WILLIAM H. BLACK, CTA AND ASSIGNED SERIAL NUMBER 778

TO SHOW CONDITIONS AS OF MAY 2019
 CO# 24GA27973300