

"COASTAL BAY"
CONDOMINIUMS
BLOCK 792 LOT 3

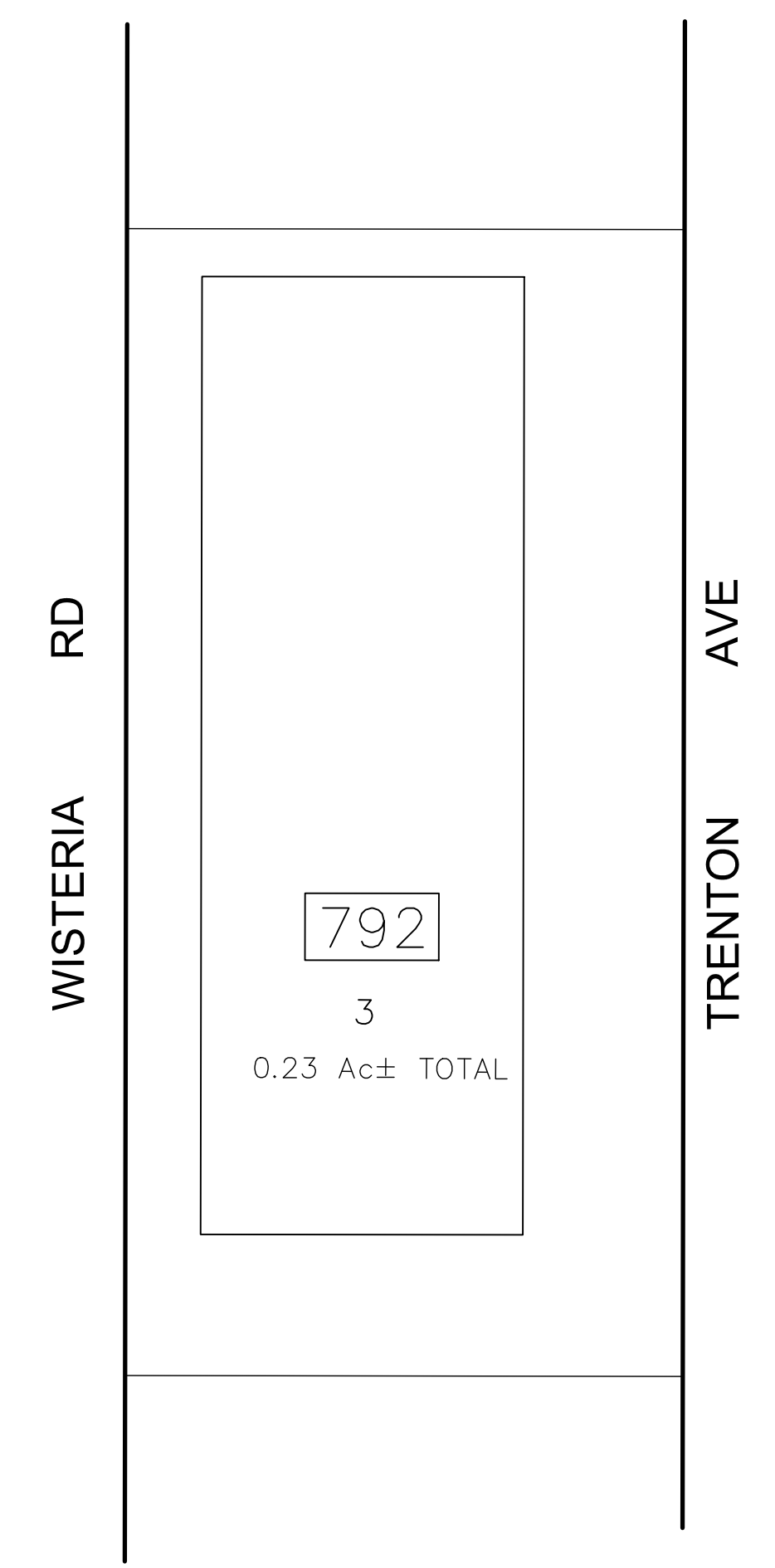

QUAL	UNIT TYPE	FLOOR	SQ. FT.
C0101		1	817
C0102		1	828
C0103		1	816
C0104		1	826
C0105		1	822
C0106		1	832
C0107		1	817
C0108		1	826
C0109		1	817
C0110		1	827

"ELBERON CONDO"
BLOCK 789 LOT 1

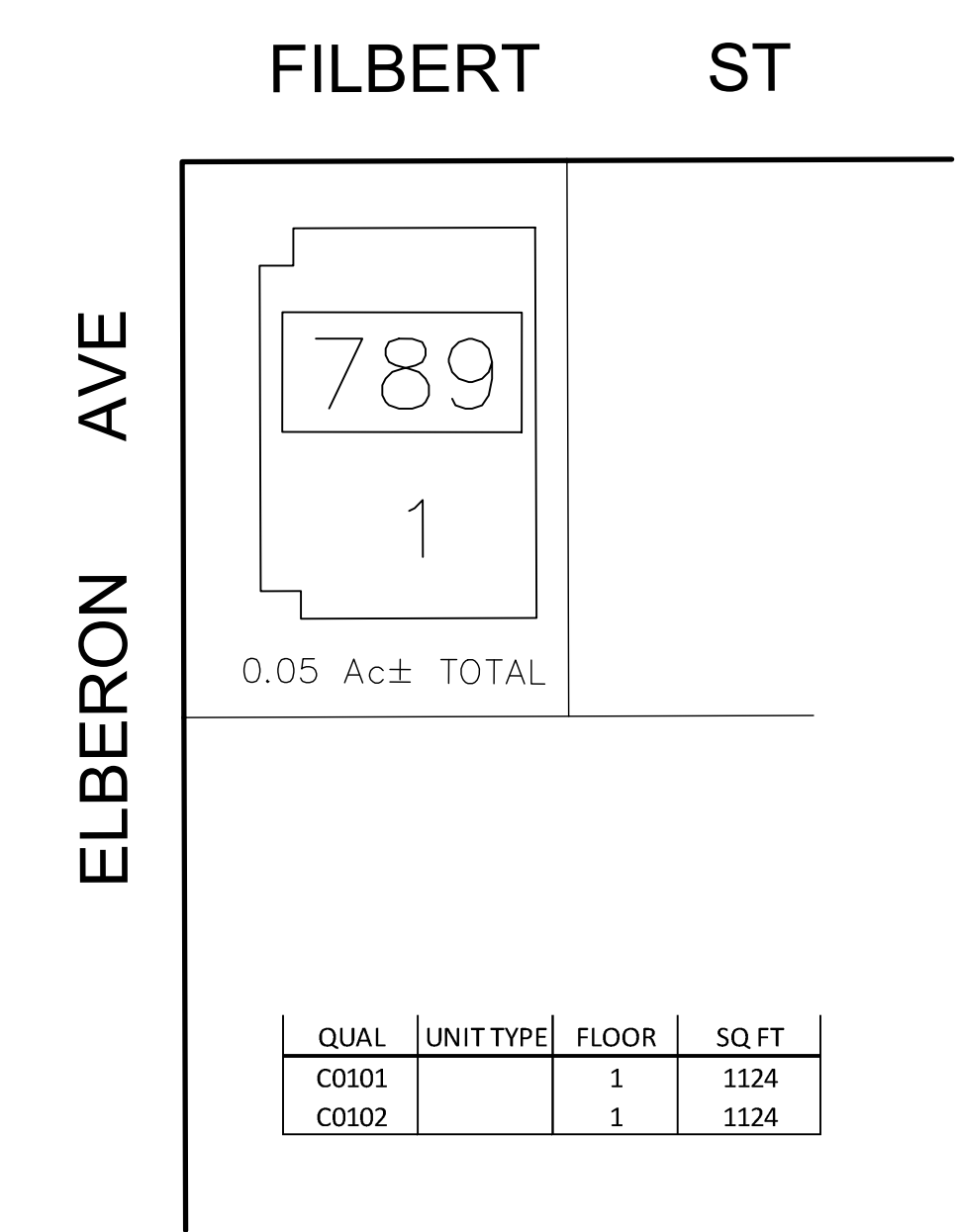

QUAL	UNIT TYPE	FLOOR	SQ. FT.
C0101		1	1124
C0102		1	1124

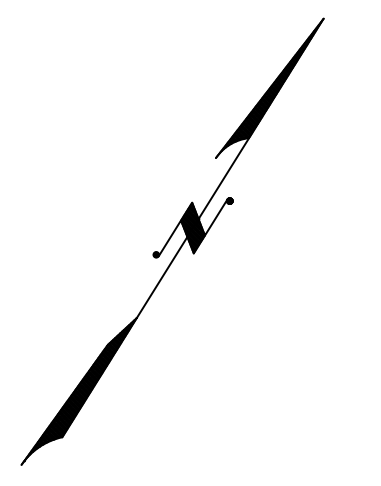

REVISIONS				
DATE	BY	LIC. NO.	BLOCK	LOT

THIS MAP HAS BEEN GIVEN A FORMAL CERTIFICATION BY THE DIVISION OF TAXATION ON NOVEMBER 25, 1997, SIGNED BY WILLIAM H. BLACK, CTA AND ASSIGNED SERIAL NUMBER 778

TAX MAP
CITY OF ATLANTIC CITY
ATLANTIC COUNTY, NEW JERSEY
NOT TO SCALE DATE: AUG 1995
JOSEPH M DOLAN, PLS, PP
MUNICIPAL LAND SURVEYOR
NEW JERSEY LICENSE NO. 23930
OFFICE OF THE CITY ENGINEER
603 CITY HALL
ATLANTIC CITY, NEW JERSEY 08401
TO SHOW CONDITIONS AS OF MAY 2019