

SHEET 92

REVISIONS				
DATE	BY	LIC. NO	BLOCK	LOT
09/2013	CHARLES A. ATKINSON-ARH	33994	589	19.02
01/2016	ED CLAY-ARH	34842	589	19.03-19.04

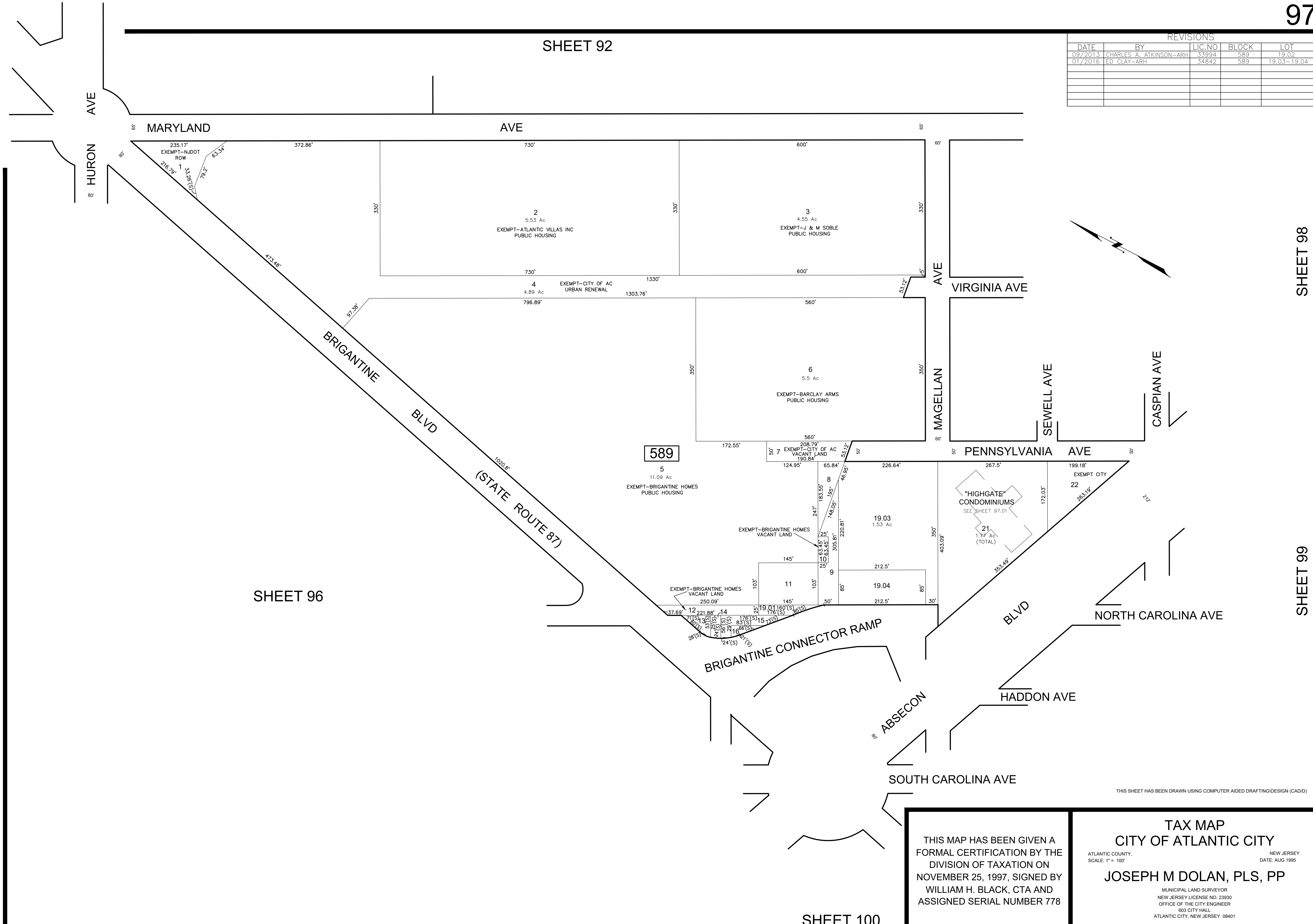

589

SHEET 96

SHEET 98

SHEET 99

SHEET 100

THIS SHEET HAS BEEN DRAWN USING COMPUTER AIDED DRAFTING/DESIGN (CAD/D)

THIS MAP HAS BEEN GIVEN A FORMAL CERTIFICATION BY THE DIVISION OF TAXATION ON NOVEMBER 25, 1997, SIGNED BY WILLIAM H. BLACK, CTA AND ASSIGNED SERIAL NUMBER 778

**TAX MAP**  
**CITY OF ATLANTIC CITY**

ATLANTIC COUNTY, NEW JERSEY  
SCALE: 1" = 100'  
**JOSEPH M DOLAN, PLS, PP**  
MUNICIPAL LAND SURVEYOR  
NEW JERSEY LICENSE NO. 23930  
OFFICE OF THE CITY ENGINEER  
603 CITY HALL  
ATLANTIC CITY, NEW JERSEY 08401

TO SHOW CONDITIONS AS OF MAY 2019

COA# 24GA27973300