

SHEET 72

REVISIONS				
DATE	BY	LIC. NO	BLOCK	LOT
11/2015	CHARLES A. ATKINSON-ARR	33994	322	24-25,27-29
04/2019	ED CLAY	34842	322	26

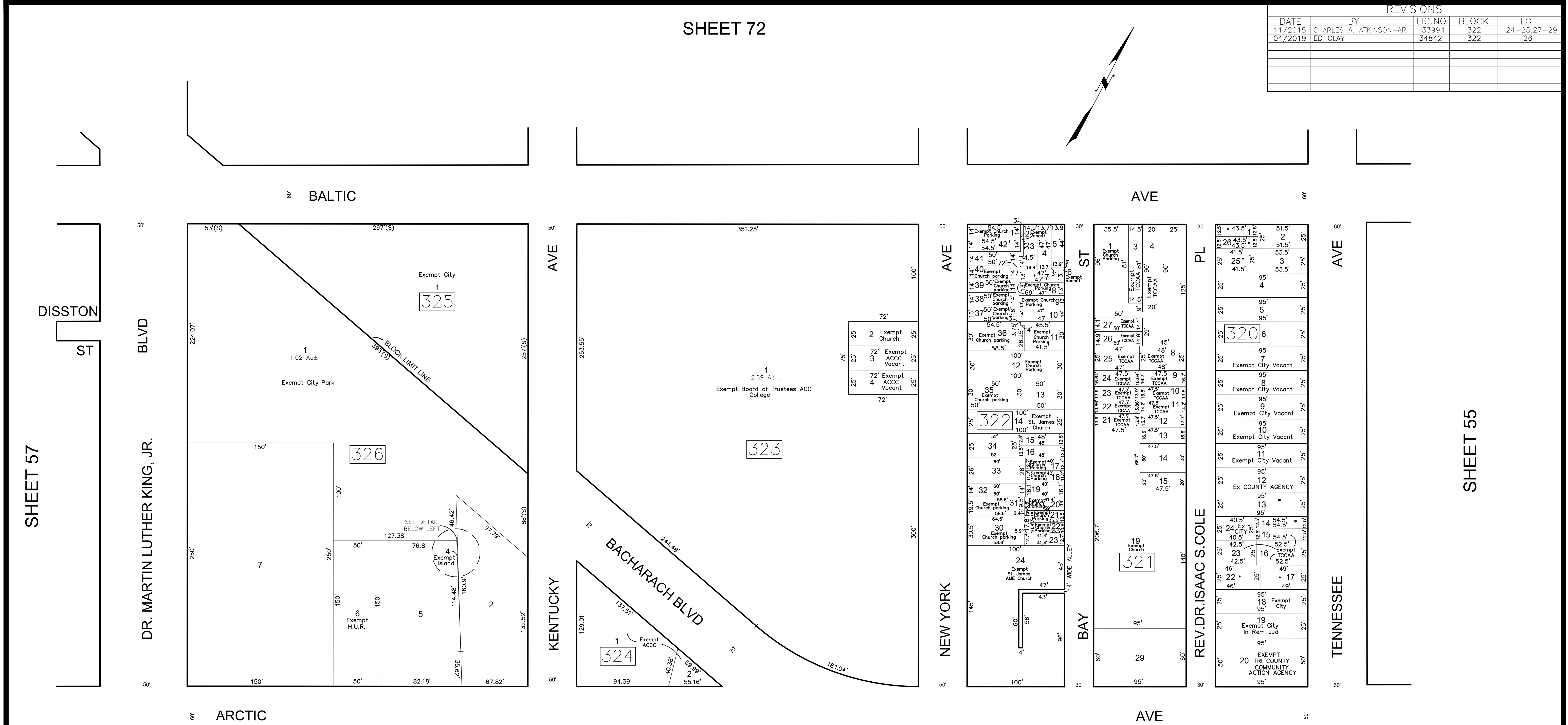
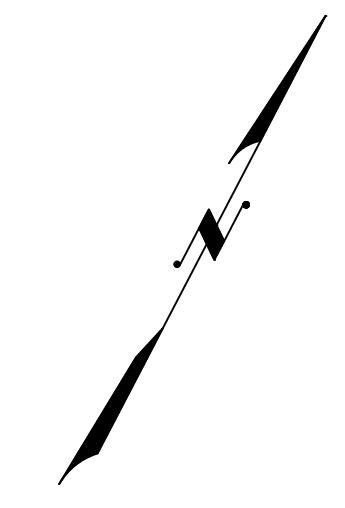

SHEET 57

SHEET 55

SHEET 49

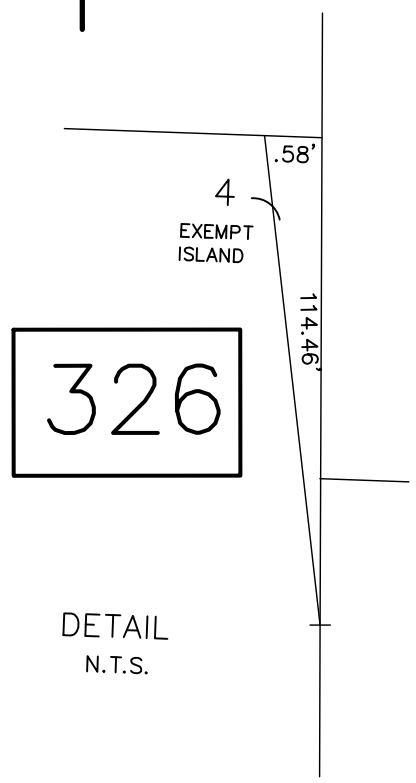

326

DETAIL N.T.S.

LEGEND:

*	-	Exempt City
ACCC	-	Atlantic Cape Community College
H.U.R.	-	Atlantic City Housing and Urban Renewal Assoc.
TCCAA	-	Tri-County Community Action Academy

THIS SHEET HAS BEEN DRAWN USING COMPUTER AIDED DRAFTING/DESIGN (CADD)

THIS MAP HAS BEEN GIVEN A FORMAL CERTIFICATION BY THE DIVISION OF TAXATION ON NOVEMBER 25, 1997, SIGNED BY WILLIAM H. BLACK, CTA AND ASSIGNED SERIAL NUMBER 778

TAX MAP
CITY OF ATLANTIC CITY

ATLANTIC COUNTY, NEW JERSEY
SCALE: 1" = 50'

JOSEPH M DOLAN, PLS, PP

MUNICIPAL LAND SURVEYOR
NEW JERSEY LICENSE NO. 23930
OFFICE OF THE CITY ENGINEER
603 CITY HALL
ATLANTIC CITY, NEW JERSEY 08401

TO SHOW CONDITIONS AS OF MAY 2019

COA# 24GA27973300