

"BAYSIDE"  
CONDOMINIUM  
BLOCK 229 LOT 11

QUAL	UNIT TYPE	FLOOR	SQ.FT
C1101		1	624
C1102		1	616
C1103		1	616
C1104		1	624
C1105		1	624
C1106		1	616
C1107		1	616
C1108		1	624
C1201		2	624
C1202		2	616
C1203		2	616
C1204		2	624
C1205		2	624
C1206		2	616
C1207		2	616
C1208		2	624
C2101		1	624
C2102		1	624
C2103		1	616
C2104		1	616
C2105		1	624
C2106		1	691
C2107		1	871
C2201		2	871
C2202		2	691
C2203		2	616
C2204		2	624
C2205		2	624
C2206		2	616
C2207		2	616
C3101		1	624
C3102		1	616
C3103		1	616
C3104		1	624
C3105		1	854
C3106		1	871
C3107		1	871
C3201		2	854
C3202		2	616
C3203		2	624
C3204		2	624
C3205		2	616
C3206		2	616
C3207		2	624

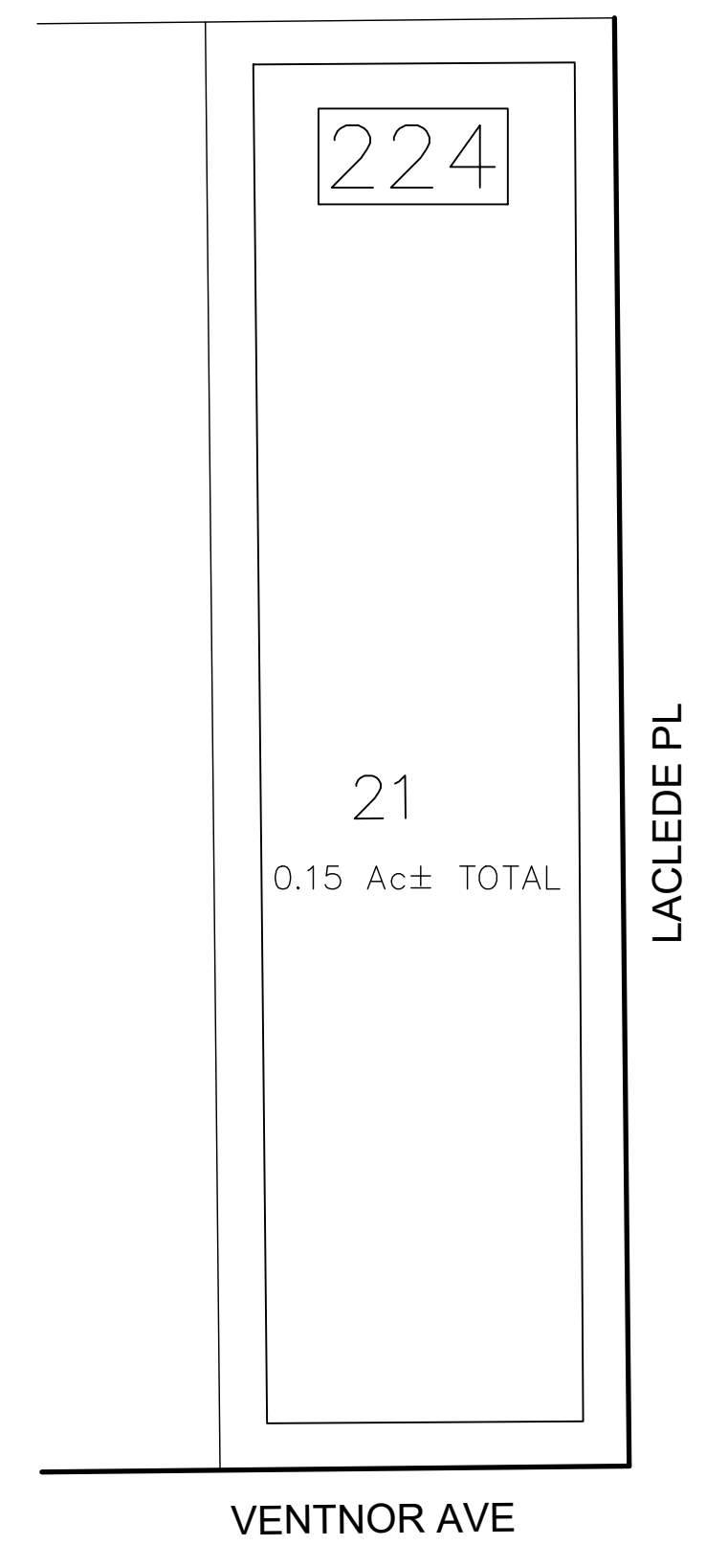

"LA CLEDE"  
CONDOMINIUM  
BLOCK 224 LOT 21

QUAL	UNIT TYPE	FLOOR	SQ.FT
C0101		1	1530
C0102		1	1082
C0103		1	466
C0104		1	4082
C0105		1	466

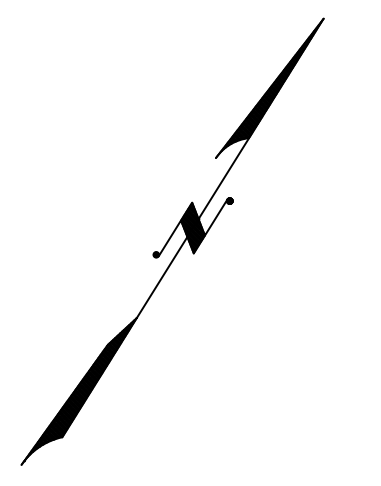

REVISIONS				
DATE	BY	LIC.NO	BLOCK	LOT

THIS MAP HAS BEEN GIVEN A FORMAL CERTIFICATION BY THE DIVISION OF TAXATION ON NOVEMBER 25, 1997, SIGNED BY WILLIAM H. BLACK, CTA AND ASSIGNED SERIAL NUMBER 778

**TAX MAP**  
**CITY OF ATLANTIC CITY**  
ATLANTIC COUNTY, NEW JERSEY  
NOT TO SCALE DATE: AUG 1995  
**JOSEPH M DOLAN, PLS, PP**  
MUNICIPAL LAND SURVEYOR  
NEW JERSEY LICENSE NO. 23930  
OFFICE OF THE CITY ENGINEER  
603 CITY HALL  
ATLANTIC CITY, NEW JERSEY 08401  
TO SHOW CONDITIONS AS OF MAY 2019