

"2 SOUTH MONTGOMERY"
CONDOMINIUM
BLOCK 213 LOT 7

QUAL	UNIT TYPE	FLOOR	SQ.FT
C0101	BASE	337	
C0102	BASE	456	
C0103	1	754	
C0104	1	754	
C0105	2	786	
C0106	2	786	
C0107	3	786	
C0108	3	786	

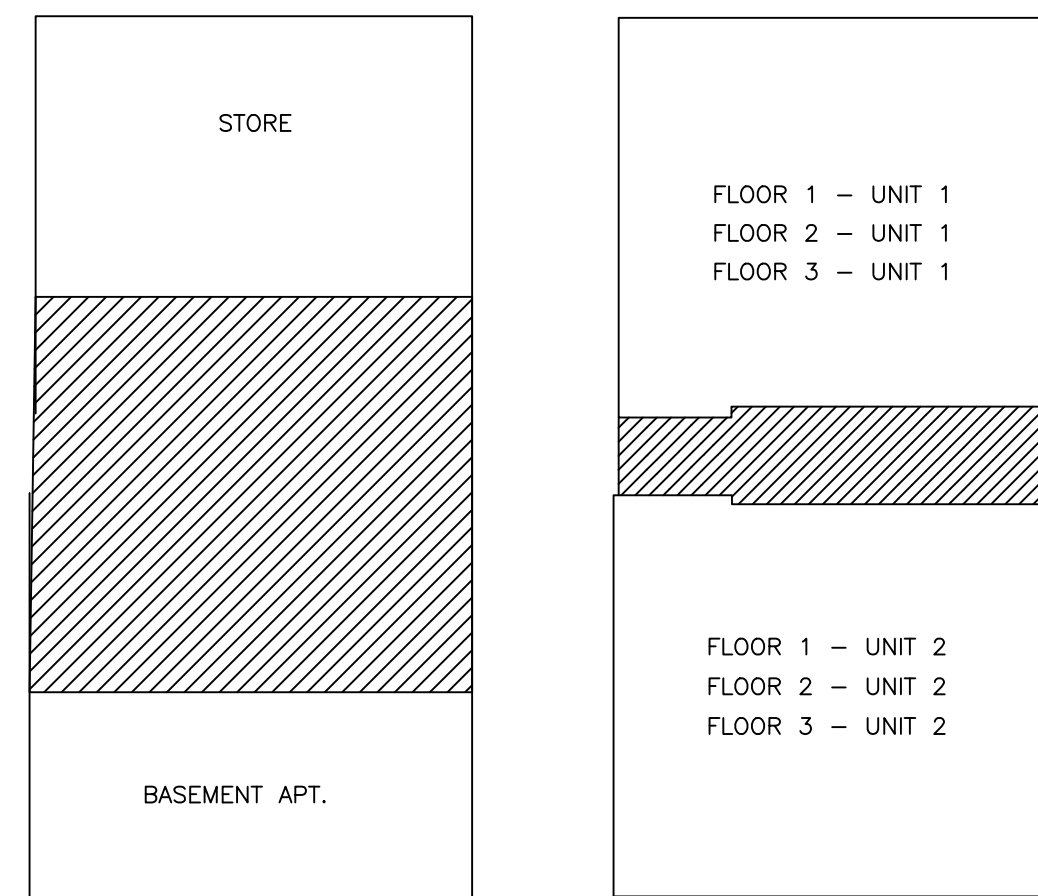

COMMON ELEMENT

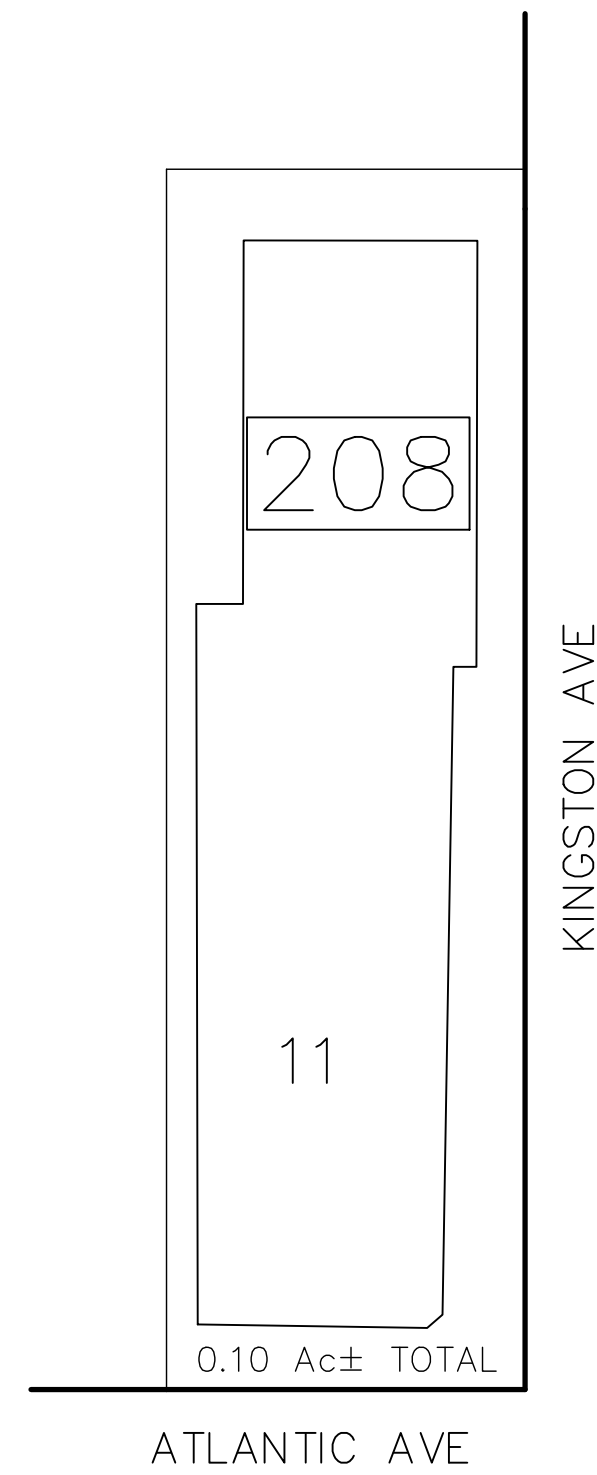

"KINGSTON TERRACE"
CONDOMINIUM
BLOCK 208 LOT 11

QUAL	UNIT TYPE	FLOOR	SQ.FT
1101		1	231
1102		1	440
1103		1	400
1104		1	246
1105		1	252
1106		1	240
1107		1	240
1108		2	284
1109		2	498
1110		2	240
1111		2	288
1112		2	288
1113		2	288
1114		3	536
1115		3	410
1116		3	240
1117		3	288
1118		3	288
1119		3	288

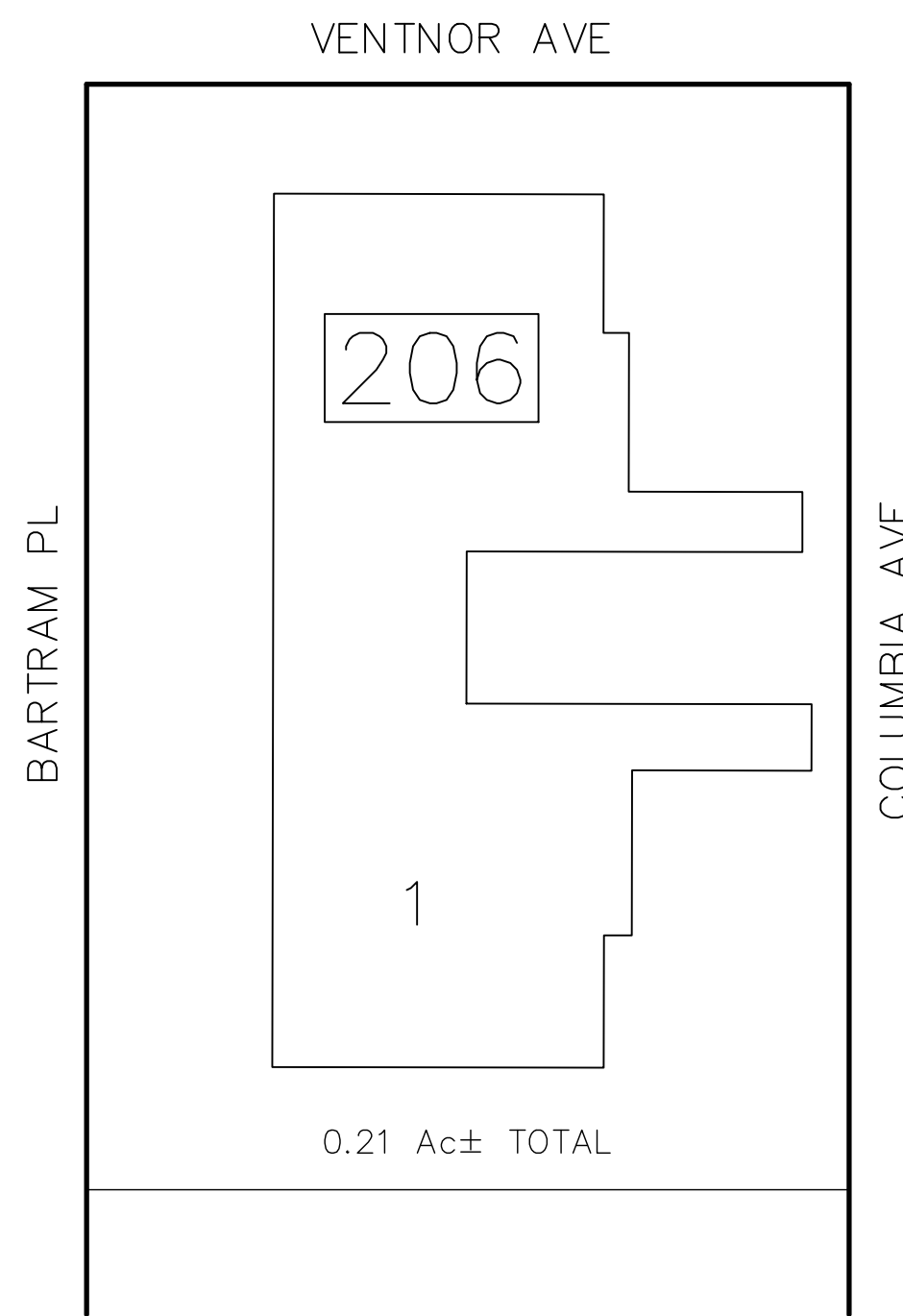

"THE STONEHURST"
CONDOMINIUM
BLOCK 206 LOT 1

QUAL	UNIT TYPE	FLOOR	SQ.FT
C0101		1	1940
C0102		1	1940
C0103		1	1940
C0104		1	1940
C0105		1	1940
C0106		1	1940

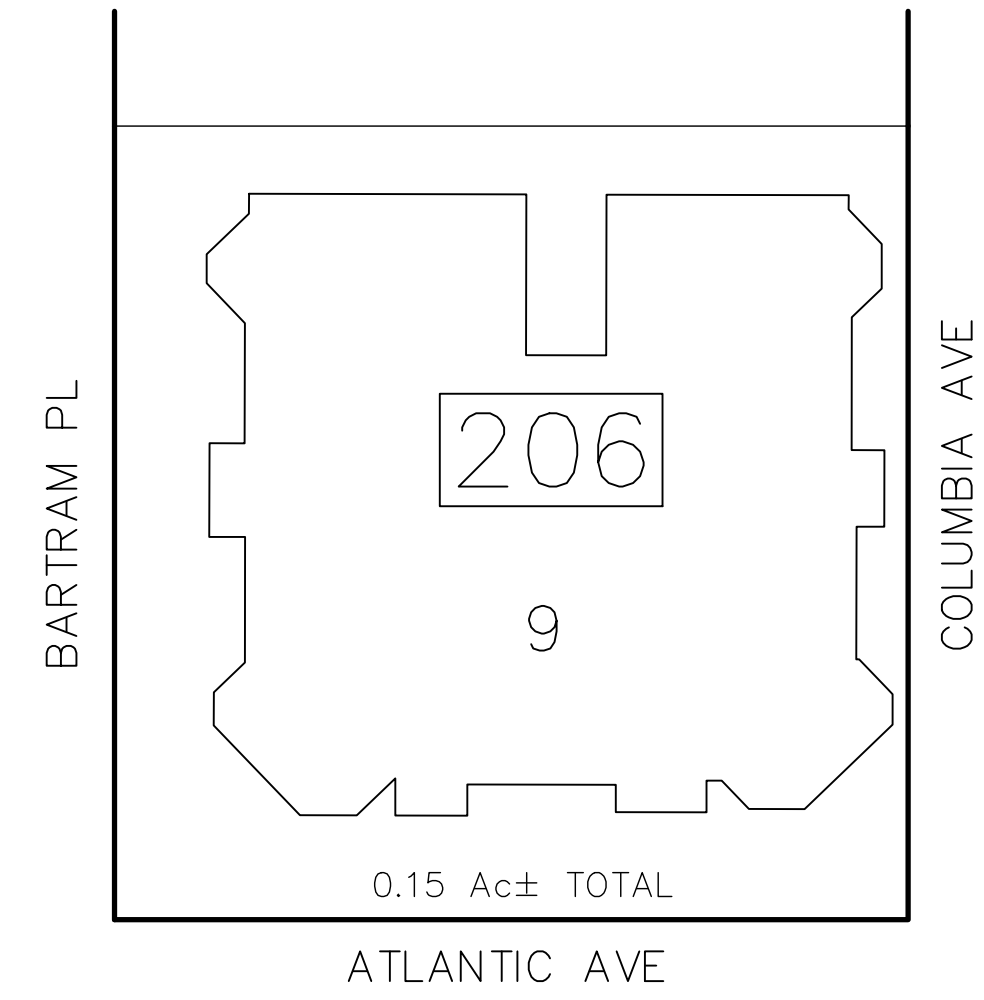

"THE EMBASSY"
CONDOMINIUM
BLOCK 206 LOT 9

QUAL	UNIT TYPE	FLOOR	SQ.FT
C0001	BASE	587	
C0101	1	763	
C0102	1	670	
C0103	1	678	
C0104	1	767	
C0201	2	918	
C0202	2	670	
C0203	2	677	
C0204	2	918	
C0301	3	918	
C0302	3	670	
C0303	3	678	
C0304	3	918	
C9001	4	288	

REVISIONS				
DATE	BY	LIC.NO	BLOCK	LOT

THIS MAP HAS BEEN GIVEN A FORMAL CERTIFICATION BY THE DIVISION OF TAXATION ON NOVEMBER 25, 1997, SIGNED BY WILLIAM H. BLACK, CTA AND ASSIGNED SERIAL NUMBER 778

TAX MAP
CITY OF ATLANTIC CITY
ATLANTIC COUNTY, NEW JERSEY
NOT TO SCALE
JOSEPH M DOLAN, PLS, PP
MUNICIPAL LAND SURVEYOR
NEW JERSEY LICENSE NO. 23930
OFFICE OF THE CITY ENGINEER
603 CITY HALL
ATLANTIC CITY, NEW JERSEY 08401
TO SHOW CONDITIONS AS OF MAY 2019
COA# 24GA27973300