

6 NEW HAMPSHIRE AVENUE
CONDOMINIUM

125

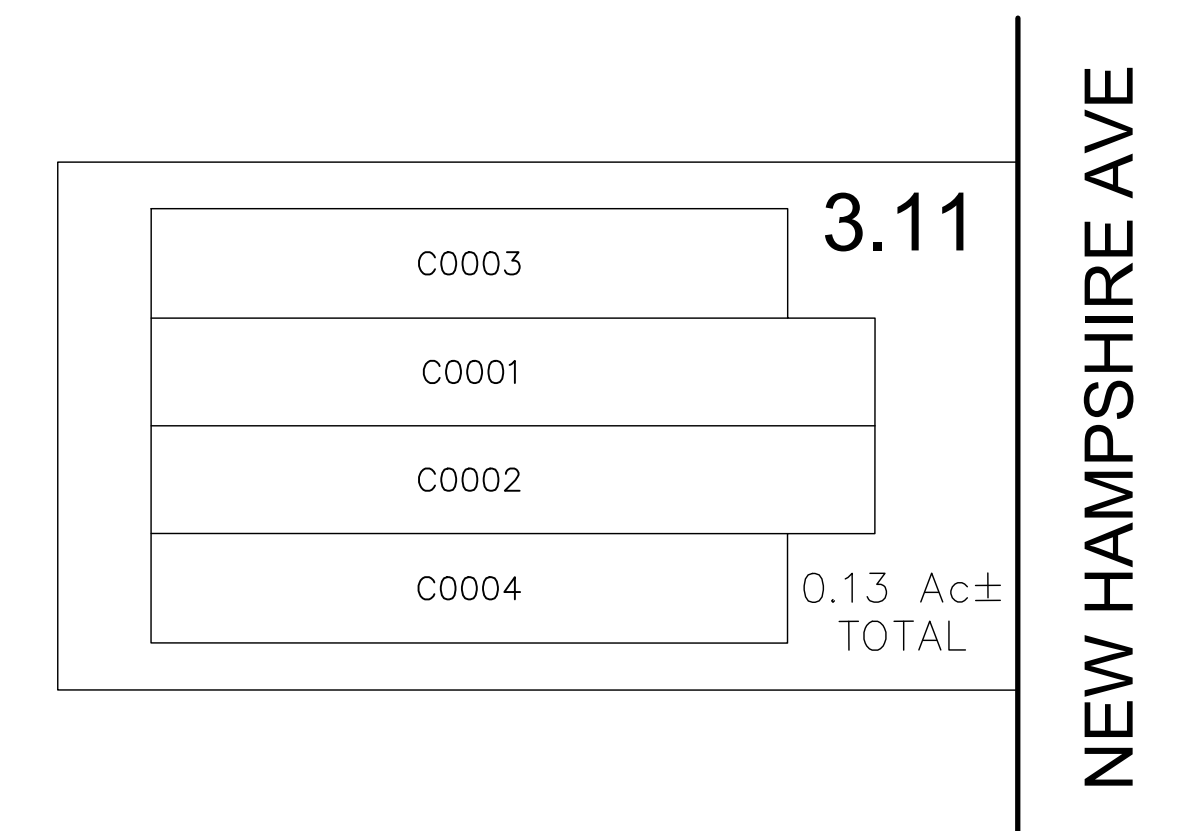

SCALE: 1"=20'

QUAL	UNIT TYPE	FLOOR	SQ FT
C0001	1A	1	1409.1
C0002	1B	1	1409.1
C0003	2A	2	1409.1
C0004	2B	2	1409.1

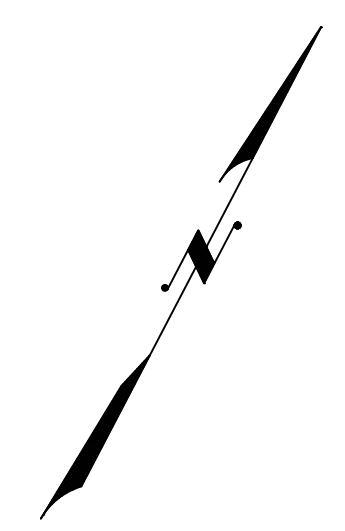

REVISIONS				
DATE	BY	LIC. NO	BLOCK	LOT

THIS MAP HAS BEEN GIVEN A
FORMAL CERTIFICATION BY THE
DIVISION OF TAXATION ON
NOVEMBER 25, 1997, SIGNED BY
WILLIAM H. BLACK, CTA AND
ASSIGNED SERIAL NUMBER 778

TAX MAP
CITY OF ATLANTIC CITY
ATLANTIC COUNTY, NEW JERSEY
NOT TO SCALE DATE: AUG 1995
JOSEPH M DOLAN, PLS, PP
MUNICIPAL LAND SURVEYOR
NEW JERSEY LICENSE NO. 23930
OFFICE OF THE CITY ENGINEER
603 CITY HALL
ATLANTIC CITY, NEW JERSEY 08401
TO SHOW CONDITIONS AS OF MAY 2019

COA# 24GA27973300