

REVISIONS		
DATE	NAME	NO.
3-1-2017	CHARLES E. ADAMSON	42627

**NOTE:**  
THIS SHEET HAS BEEN DRAWN USING COMPUTER AIDED DRAFTING/DESIGN (CADD) AND COORDINATE GEOMETRY (COGO).

SHEET 64

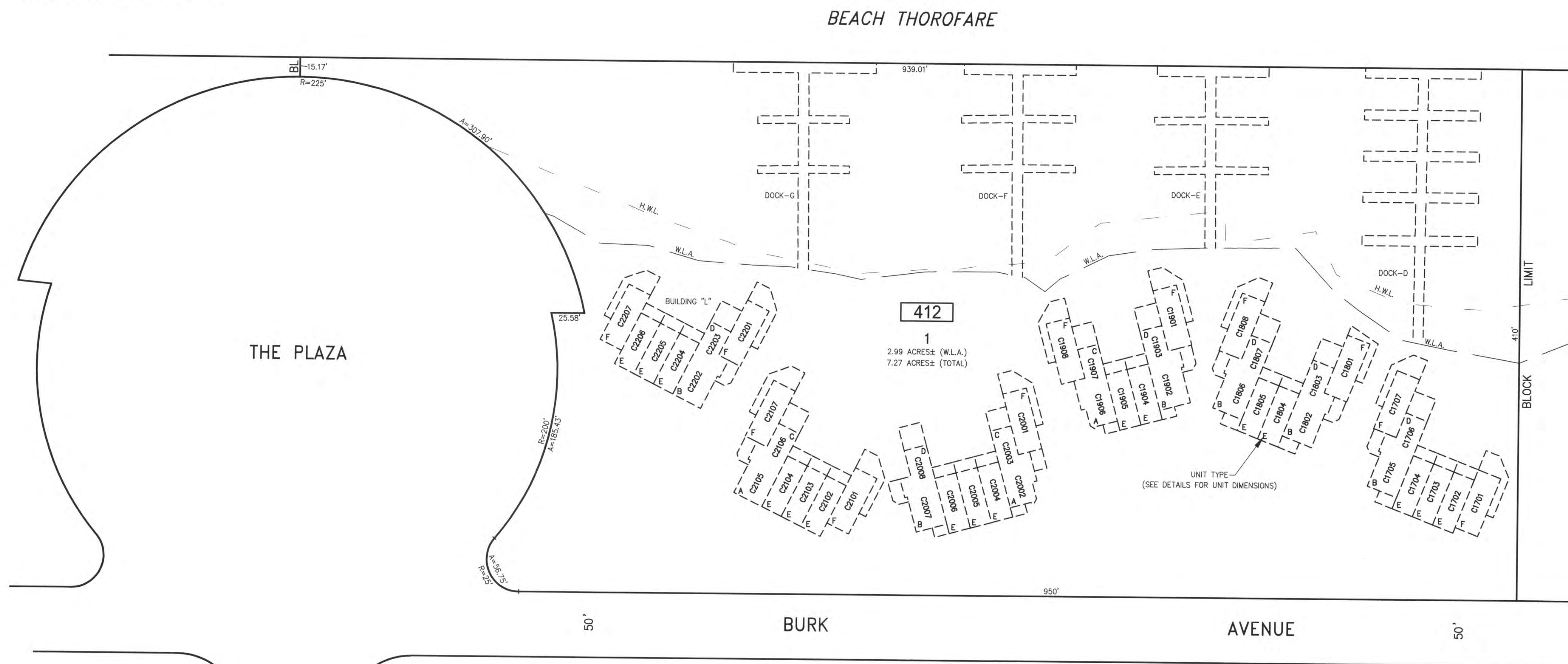

SHEET 62

DORSET AVENUE

SHEET 60

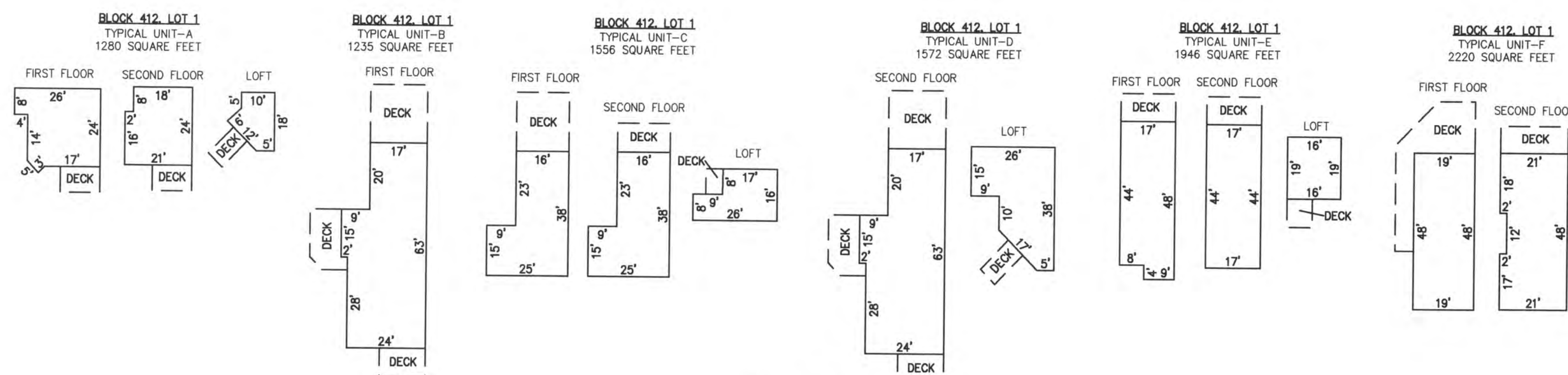

**DETAILS**  
SCALE: 1"=30"  
**BLOCK 412, LOT 1**  
**CROWN KEY YACHT CLUB CONDOMINIUM**

CONDO QUALIFIER	SQUARE FOOTAGE	DOCK NUMBER	CONDO QUALIFIER	SQUARE FOOTAGE	DOCK NUMBER
C1701	2220 SF.	D-38	C2001	2220 SF.	F-10
C1702	1946 SF.	D-36	C2002	1280 SF.	E-2
C1703	1946 SF.	D-34	C2003	1556 SF.	E-4
C1704	1946 SF.	D-32	C2004	1946 SF.	F-8
C1705	1235 SF.	D-28	C2005	1946 SF.	F-6
C1706	1572 SF.	D-30	C2006	1946 SF.	F-4
C1707	2220 SF.	D-40	C2007	1235 SF.	E-1
C1801	2220 SF.	D-37	C2008	1572 SF.	E-3
C1802	1235 SF.	D-25	C2101	2220 SF.	F-9
C1803	1572 SF.	D-29	C2102	1946 SF.	F-7
C1804	1946 SF.	D-33	C2103	1946 SF.	F-5
C1805	1946 SF.	D-35	C2104	1946 SF.	F-3
C1806	1235 SF.	D-27	C2105	1280 SF.	F-1
C1807	1572 SF.	D-31	C2106	1556 SF.	F-2
C1808	2220 SF.	D-39	C2107	2220 SF.	G-8
C1901	2220 SF.	E-8	C2201	2220 SF.	G-5
C1902	1235 SF.	D-22	C2202	1235 SF.	G-2
C1903	1572 SF.	D-24	C2203	1572 SF.	G-1
C1904	1946 SF.	E-6	C2204	1946 SF.	G-4
C1905	1946 SF.	E-5	C2205	1946 SF.	G-3
C1906	1280 SF.	D-26	C2206	1946 SF.	G-6
C1907	1556 SF.	D-23	C2207	2220 SF.	G-7
C1908	2220 SF.	E-7			

"THIS TAX MAP SHEET HAS BEEN DIGITALLY REVISED USING COMPUTER-AIDED DRAFTING/DESIGN (CADD) & COORDINATE GEOMETRY (COGO). IT IS BASED ON THE ORIGINAL DIGITALLY DRAWN TAX MAP PLATE BEARING THE OFFICIAL NEW JERSEY DIVISION TAXATION APPROVAL STAMP WITH APPROVAL DATE JULY, 20, 2016. SERIAL NUMBER 1070 AND SIGNATURE OF JUDY P. MILLER, CTA, CHIEF PROPERTY ADMINISTRATION AND SHELLY REILLY, CTA, PRINCIPAL FIELD REPRESENTATIVE. THE ORIGINAL DIGITALLY DRAWN TAX MAP PLATE WITH THE OFFICIAL APPROVAL STAMP IS ON FILE WITH REMINGTON & VERNICK ENGINEERS."

**TAX MAP**  
**CITY OF VENTNOR**  
ATLANTIC COUNTY NEW JERSEY  
SCALE: 1" = 50' DATE: 2-19-2015

**CHARLES E. ADAMSON** NJ PROFESSIONAL LAND SURVEYOR LIC. NO. 42627

**RV & W** REMINGTON, VERNICK & WALBERG ENGINEERS  
24 GA 28048700  
645 N. MAIN STREET, PLEASANTVILLE, NJ 08232  
(609) 645-7000, FAX (609) 645-7076  
WEB SITE ADDRESS: WWW.RVW.COM

TO SHOW CONDITIONS AS OF 3-1-2017