

REVISIONS		
DATE	NAME	NO.

**NOTE:**  
THIS SHEET HAS BEEN DRAWN USING COMPUTER AIDED DRAFTING/DESIGN  
(CAD/D) AND COORDINATE GEOMETRY (COGO).

SHEET 55

SHEET 46

SHEET 41

SHEET 35

SHEET 32

SHEET 25

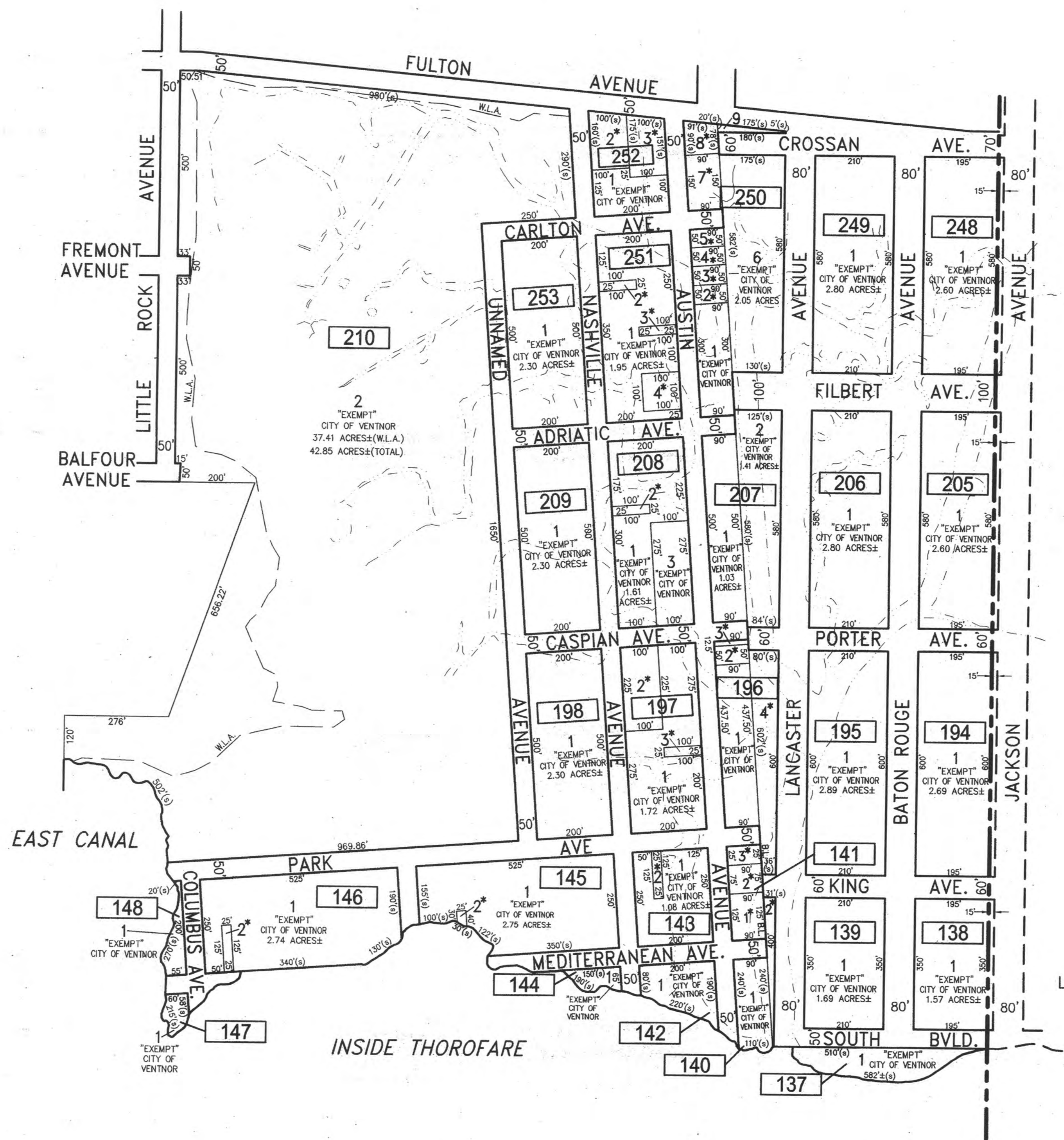

**CITY OF ATLANTIC CITY**  
**COUNTY OF ATLANTIC**

SHEET 18

SHEET 17

NEW JERSEY DEPARTMENT OF THE  
DIVISION OF TAXATION  
APPROVED AS A TAX MAP PREPARED BY  
N.J.S.A. 54:1-15 AND 54:1-16  
FOR THE DIRECTOR, DIVISION OF TAXATION  
*Charles E. Adamson*  
Shelly H. Miller  
DATE JUL 20 2016 1070

**TAX MAP**  
**CITY OF VENTNOR**  
ATLANTIC COUNTY NEW JERSEY  
SCALE: 1" = 200' DATE: 2-19-2015  
CHARLES E. ADAMSON NJ PROFESSIONAL LAND SURVEYOR LIC. NO. 42627  
REMINGTON, VERNICK & WALBERG ENGINEERS  
845 N. MAIN STREET, PLEASANTVILLE, N.J. 08232  
(609) 645-7100, FAX (609) 645-7076  
WEB SITE ADDRESS: WWW.RVE.COM  
TO SHOW CONDITIONS AS OF 7-20-2016