

REVISIONS		
DATE	NAME	NO.

NOTE:
THIS SHEET HAS BEEN DRAWN USING COMPUTER AIDED DRAFTING/DESIGN
(CADD) AND COORDINATE GEOMETRY (COGO).

SHEET 29

SHEET 23

SHEET 21

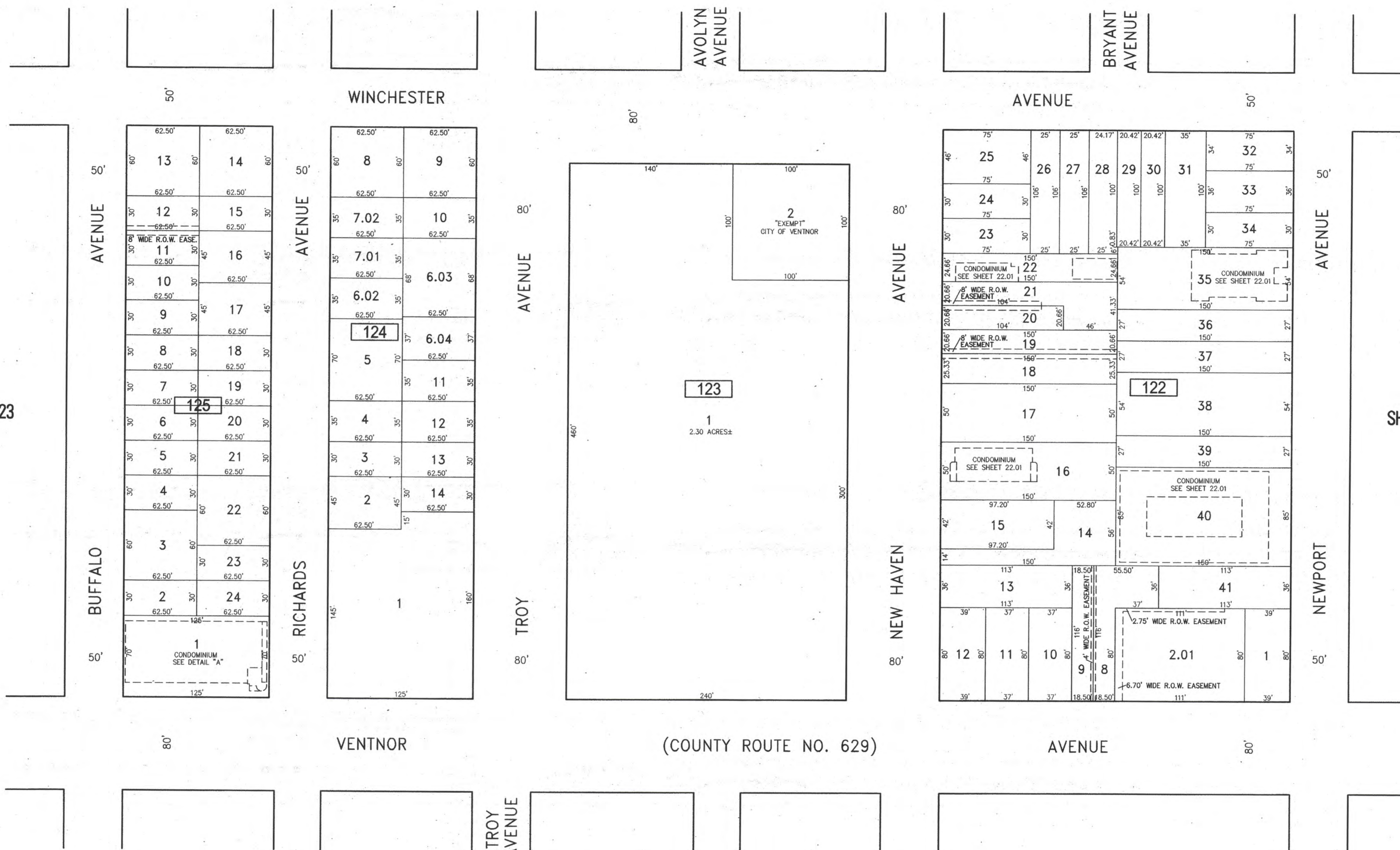
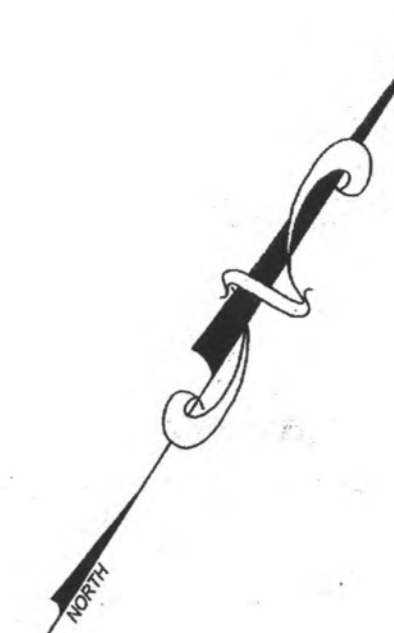

(COUNTY ROUTE NO. 629)

SHEET 14

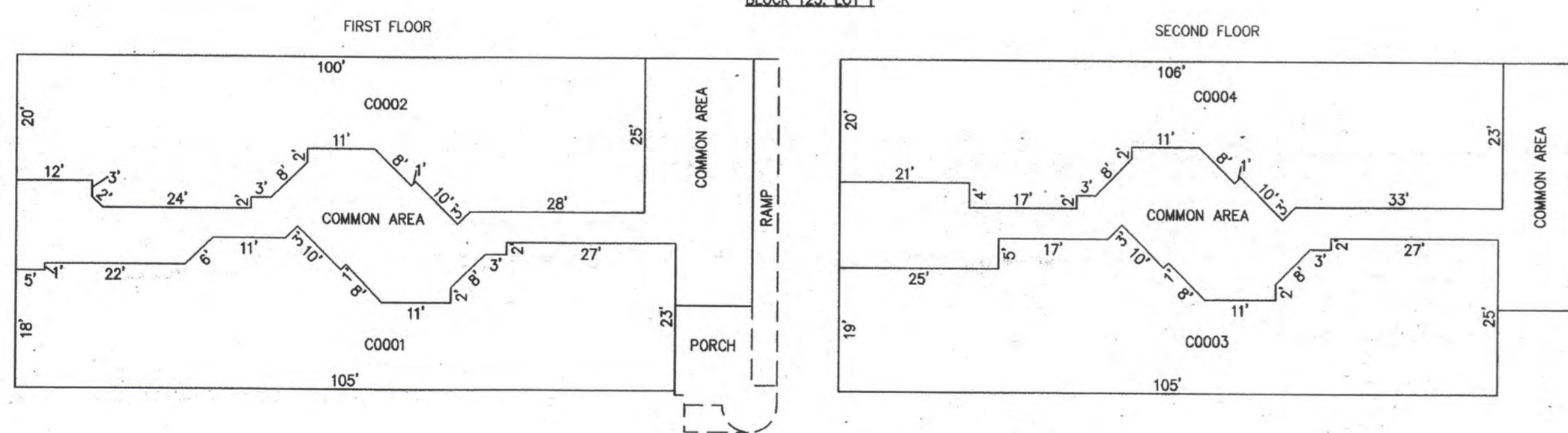

CONDO QUALIFIER	SQUARE FOOTAGE
C0001	2126 SF.
C0002	2006 SF.
C0003	2287 SF.
C0004	2124 SF.

ISLAND MEDICAL CONDOMINIUM
6725 VENTNOR AVENUE
DETAIL "A"
SCALE: 1"=20'

NEW JERSEY DEPARTMENT OF THE TREASURY
DIVISION OF TAXATION
APPROVED AS A TAX MAP PURSUANT TO THE AUTHORITY OF
N.J.S.A. 54:1-15 AND N.J.S.A. 54:2-4
FOR THE DIRECTOR, DIVISION OF TAXATION
Charles E. Adamson
Charles E. Adamson, P.L.S., Civil Property Administrator
Stelly Realty, C.T.A. Principal Field Representative
DATE JUL 20 2016 SERIAL NO. 1070

TAX MAP
CITY OF VENTNOR

ATLANTIC COUNTY NEW JERSEY
SCALE: 1" = 50' DATE: 2-19-2015

CHARLES E. ADAMSON NJ PROFESSIONAL LAND SURVEYOR LIC. NO. 42627
24 GA 28048700
REMINGTON, VERNICK & WALBERG ENGINEERS
645 N. MAIN STREET, PLEASANTVILLE, N.J. 08232
(609) 645-7100, FAX (609) 645-7076
WEB SITE ADDRESS: WWW.RVW.COM
TO SHOW CONDITIONS AS OF 7-20-2016