

REVISIONS		
DATE	NAME	NO.

NOTE:
THIS SHEET HAS BEEN DRAWN USING COMPUTER AIDED DRAFTING/DESIGN (CADD) AND COORDINATE GEOMETRY (COGO).

SHEET 20

SHEET 13

SHEET 11

SHEET 4

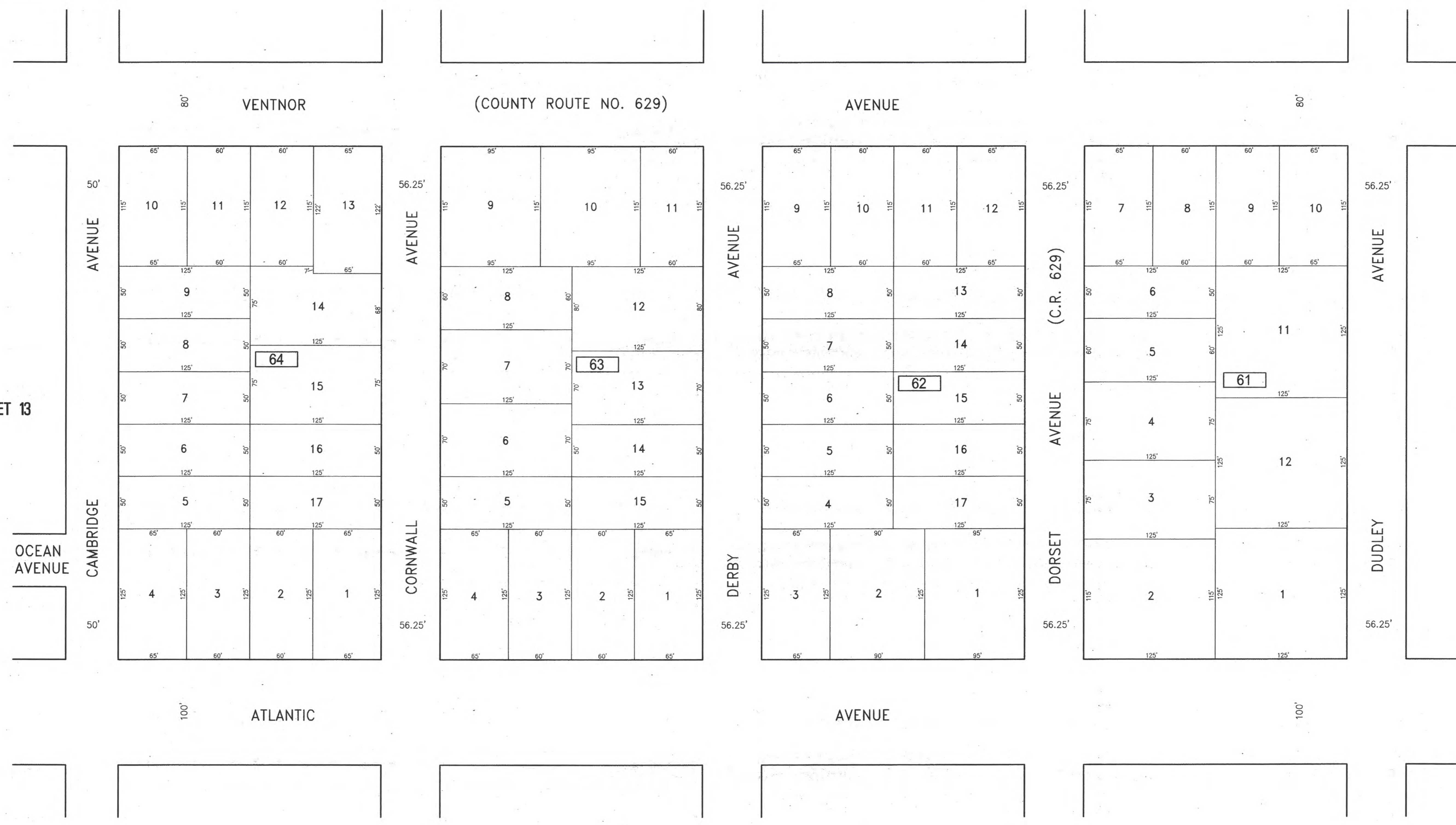

<p>NEW JERSEY DEPARTMENT OF THE TREASURY BUREAU OF TAXATION APPROVED AS A TAX MAP PURSUANT TO THE AUTHORITY OF N.J.S.A. 54:1-18 AND N.J.S.A. 54:5-1 FOR THE DIRECTOR, DIVISION OF TAXATION <i>Shirley Miller, CTA</i> Shirley Miller, CTA, Chief Property Administrator <i>Shirley Miller, CTA</i> Shirley Miller, CTA, Principal State Representative DATE JUL 20 2016 SERIAL NO. 1070</p>	<p>TAX MAP CITY OF VENTNOR ATLANTIC COUNTY NEW JERSEY SCALE: 1" = 50' DATE: 2-19-2015 CHARLES E. ADAMSON NJ PROFESSIONAL LAND SURVEYOR LIC. NO. 42627 REMINGTON, VERNICK & WALBERG ENGINEERS 24 GA 28048700 845 N. MAIN STREET, PLEASANTVILLE, N.J. 08232 (609) 645-7100, FAX (609) 645-7076 WEB SITE ADDRESS: WWW.RVW.COM TO SHOW CONDITIONS AS OF 7-20-2016</p>
---	---